

SITUATED IN

The State of Ohio, County of Muskingum
Township of Washington, and being a part
Lot 3 of Underwoods Subdivision, BK "E", Pg. 62.

SURVEY SPLIT

BASIS OF BEARING

Bearings are based on State Plane Ground
Coordinates, NAD83, Ohio South,
per GPS Observation.

REFERENCES

* As Noted on Plat
www.muskingumcountyauditor.org
www.mceo.org
http://recorder.muskingumcounty.org

Binkley, Linn, McPeck and Filney.
Previous Surveys by: Adcock, Bowman,

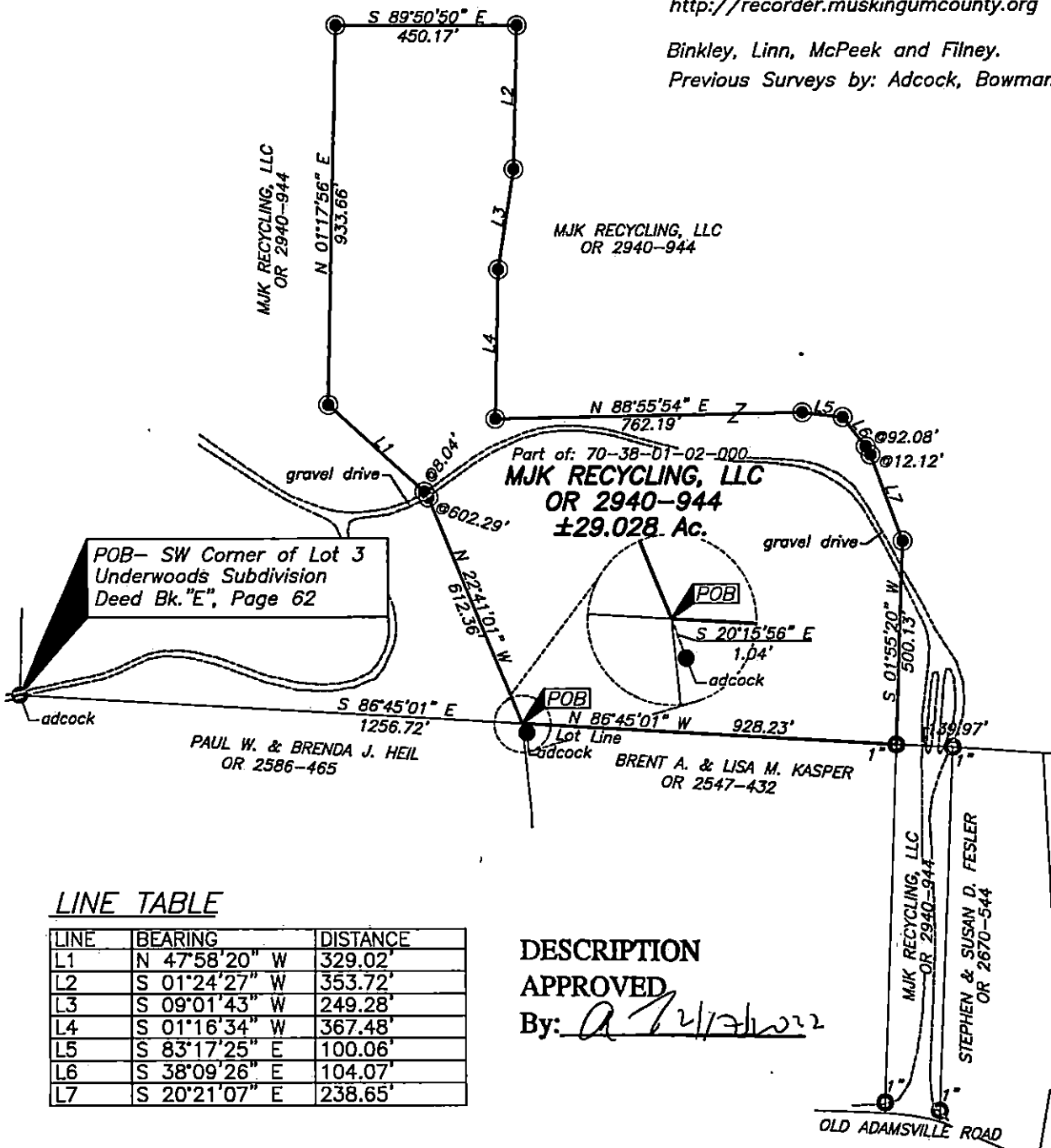

LINE TABLE

LINE	BEARING	DISTANCE
L1	N 47°58'20" W	329.02'
L2	S 01°24'27" W	353.72'
L3	S 09°01'43" W	249.28'
L4	S 01°16'34" W	367.48'
L5	S 83°17'25" E	100.06'
L6	S 38°09'26" E	104.07'
L7	S 20°21'07" E	238.65'

DESCRIPTION
APPROVED

By: *[Signature]*

LEGEND

- Iron Pin Found
- Pipe Found w/cap
- ⊠ Stone Found
- Property Hook
- Iron Pin Set
- Point Not Marked



GRAPHIC SCALE

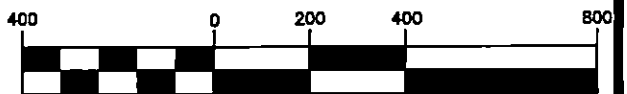

(IN FEET)

1 inch = 400 ft.

OFFICE COPY
NOT RECORDABLE

Brian Kelly McPeck
Reg. Surveyor No. 8517

This plat was prepared by McPeck Land Surveying, LLC
in accordance with Chapter 4733-37 of the Administrative Code,
and is intended to be used for the legal transfer of the property
described and does not intend to describe all or any easements of
record, nor encroachments unless otherwise intended.

**MCPECK
LAND
SURVEYING** LLC
www.mcpecklandsurveying.com
email: brian@mcpecklandsurveying.com
340 Robin Hood Ln., Zanesville, Oh 43701 • 740.704.6073