

81-53-03-13-000



www.mcpeeklandsurveying.com  
email: brian@mcpeeklandsurveying.com  
340 Robin Hood Ln., \* Zanesville, Oh 43701 \* 740.704.6073

**Marlene Moore**  
**OR 2837-56**

**All of: 81-53-03-13-000 (+/-0.089 Ac.)**

Situated in the State of Ohio, County of Muskingum, City of Zanesville, part of Lot 9, Parkinson's Addition as recorded in DR U, Page 281 of the Muskingum County Recorder's Office and described as follows.

Beginning at an iron pin set at the southwest corner of said Lot 9, being on the north line of Sharon Avenue (60'), thence leaving the north line of said Sharon Avenue and going with the west line of said Lot 9, N 03°26'01" W a distance of 90.13 feet to an iron pin set at the southwest corner of the lands now owned by Dana R. Pierce (OR 2080-336);

Thence with the south line of said Pierce's lands and going through said Lot 9, S 88°12'06" E a distance of 45.84 feet to an iron pin set on the west line of Lot 10;

Thence with the west line of said Lot 10, S 01°01'24" E a distance of 87.37 feet to an iron pin set on the north line of said Sharon Avenue;

Thence with the north line of said Sharon Avenue, S 88°24'00" W a distance of 42.00 feet to the place of beginning, containing a total of 0.089 acres more or less, subject to all legal highways and easements of record.

All bearings and distances described herein are based on the Ohio State Plane Grid Coordinates, NAD83, Ohio South per GPS Observation.

All iron pins set are 5/8 inch by 30 inch steel rebar with plastic identification caps marked MCPEEK PS8517.

The above described 0.089 acre parcel is based on a field survey made by McPeek Land Surveying May 15<sup>th</sup>, 2021.

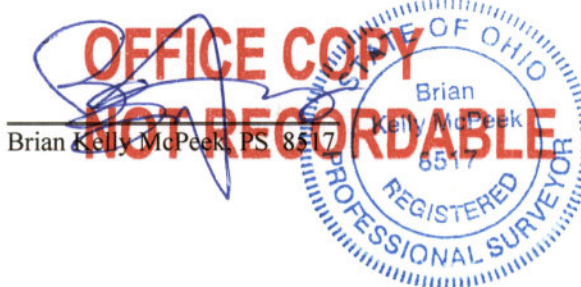

Brian Kelly McPeek, PS 8517

Date

5/21/21

DESCRIPTION  
APPROVED

By: A. J. McPeck