



SITUATED IN

The State of Ohio, County of Muskingum  
City of Zanesville, and being a part of  
Colony North, a Planned Unit Development  
as recorded in Plat Book 14, Pages 89, 90 and 91.

LEGEND

- Iron Pin Set, 5/8" rebar
- Iron Pin Found
- ⊗ PK Nail Set

Ray Thomas Lumbertown, Inc.  
OR 930-271

Cliffhanger Properties, LLC  
OR 1851-752

Cliffhanger Properties, LLC  
OR 1851-752  
Par #86-32-01-01-014  
0.630 AC.

Whitecap Properties, LLC.  
OR 1940-142

Dream Abaco, LLC.  
OR 2286-508

Insight Asset Management, Inc.  
OR 2748-3

Colony Ridge Condominiums  
Plat Book 16, Page 44

Iron Pin Found at the Northwest  
corner of Colony Ridge Condominiums  
as recorded in Plat Book 16, Page 44.

APPROVED BY CITY PLANNING COMMISSION,  
ZANESVILLE, OHIO;  
NO PLAT REQUIRED

*William Linn* 08/22/2019

REFERENCES

As shown on Plat.

BASIS OF BEARING

Bearings are based on the west line of  
Wyndemere Way (now Cliff Hanger Way)  
Street Dedication as per Plat Book 16, Page 43.

DESCRIPTION  
APPROVED

By: *Timothy H. Linn*

PARCEL NO.

Part of: 86-32-01-01-014 (±0.630 Ac.)

GRAPHIC SCALE

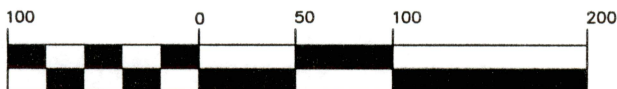

( IN FEET )  
1 inch = 100 ft.

Project No.: 86-32-NIST-TOWN



Linn Engineering, Inc.  
Civil Engineering Consultants  
P.O. Box 2086 Zanesville, Ohio 43702-2086

740-452-7434

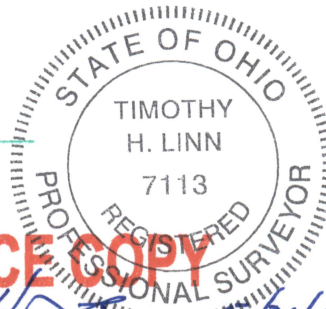

OFFICE COPY  
NOT RECORDABLE

Timothy H. Linn  
Reg. Surveyor No. 7113