

02-26-09-01-006 B

Page 3 of 3

Description of Parcel # 5 (50.099 Acres)

All iron pins set are 5/8" x 30" rebar capped and labeled "Biedenbach Surveying, LLC. PS 7881".

The bearings in this description are for angle calculations only and are based on the south line of the southeast quarter of the southeast quarter of Section 9 used as an assumed bearing of North 87°59'39" West.

A plat of the above-described survey has been submitted for file at the County Engineer's Office.

The above description prepared by Gregory A. Biedenbach, Ohio Registered Surveyor No. 7881, based on information obtained from an actual field survey of March 6, 2019. Said survey being subject to any facts that may be disclosed in a full and accurate title search.

Prior Deed: Official Records Volume 2823, Page 886.

March 6, 2019 *Gregory A. Biedenbach*  
Date Gregory A. Biedenbach  
Ohio Registered Surveyor  
No. 7881

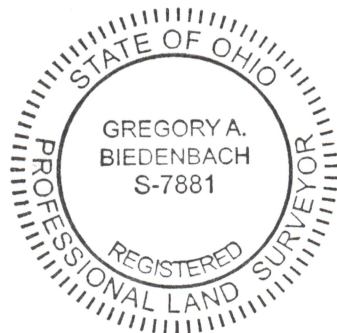

Cc: Survey File: GB-3173F

DESCRIPTION  
APPROVED  
By: *March 3/20/2019*