

Baseline Surveying, Inc.

Land Surveying and Construction Layout

3010 East Pike
Zanesville, OH 43701

Email: bel@mohio.com
Telephone (740) 453-4850

7. WITH A CURVE TO THE LEFT HAVING A RADIUS OF 903.19 FEET (CHORD BEARING NORTH 79 DEGREES 34 MINUTES 09 SECONDS EAST 110.61 FEET, DELTA ANGLE OF 7 DEGREES 01 MINUTES 16 SECONDS) AN ARC DISTANCE OF 110.68 FEET TO A POINT;
8. NORTH 72 DEGREES 56 MINUTES 15 SECONDS EAST 73.71 FEET TO A POINT;

THENCE LEAVING THE SAID ROAD AND TRAVERSING THROUGH THE SAID OSBORN PARCEL THE FOLLOWING TWO COURSES AND DISTANCES:

1. SOUTH 14 DEGREES 54 MINUTES 57 SECONDS EAST 904.90 FEET TO AN IRON PIN SET, PASSING AN IRON PIN SET AT 19.34 FEET AND AT 64.78 FEET;
2. SOUTH 32 DEGREES 35 MINUTES 50 SECONDS EAST 850.72 FEET TO THE **PLACE OF BEGINNING.**

CONTAINING 40.000 ACRES, SUBJECT TO ALL LEGAL ROAD RIGHT OF WAYS OF WILSONWOOD ROAD (TOWNSHIP ROAD 69) AND ALL OTHER APPLICABLE EASEMENTS.

ALL IRON PINS SET ARE 5/8 INCH X 30 INCH REBAR WITH PLASTIC IDENTIFICATION CAPS (BASELINE PS6923-PS8536).

BEARINGS ARE BASED ON OHIO STATE PLANE COORDINATE SYSTEM 1983 (2011), OHIO SOUTH ZONE, GRID, DERIVED FROM A GPS OBSERVATION

I, MICHAEL D. NICHOLS, PS 6923, HEREBY CERTIFY TO THE BEST OF MY KNOWLEDGE AND BELIEF THE SURVEY AND DESCRIPTION TO BE CORRECT AS PREPARED BY ME, THIS 14TH DAY OF OCTOBER 2021, FROM A FIELD SURVEY COMPLETED ON THE 13TH DAY OF OCTOBER 2021.

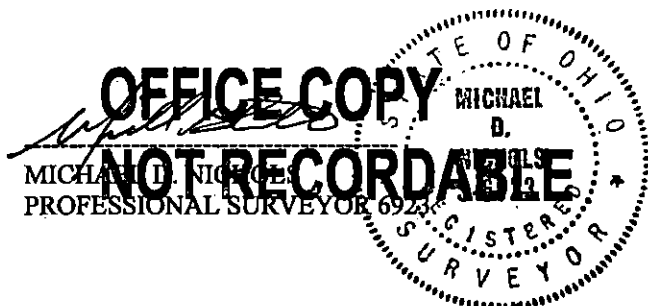

**DESCRIPTION
APPROVED**

By: *[Signature]* 10/14/21