

DESCRIPTION OF SURVEY FOR BILL HILL

JOB#700-2

Situated in the State of Ohio, County of Muskingum, Township of Hopewell:

Being part of South Half Lot #6, of the Third Quarter Township, Township #1, Range #9, of the US Military District, being that portion of Parcel One of the Rosamond Bendure property as described in deed reference Deed Book Volume 1118, Page 51 of said county's deed records, lying between the South line of the Walter Franks property as described in deed reference Deed Book Volume 1009, Page 67, and the Half Lot line for said Lot #6, known as part of Muskingum County Auditor's Parcel Number 25-30-03-33-000, and more particularly described as follows;

Commencing at a railroad spike (found) at the common corner for Lots #5, #6, #9, & #10, being in the bed of a field drive; thence N 02 52 50 E 680.82 feet along the common line for said Lots #6 and #9 to an iron pin (found) at the Southwest corner of the Walter Franks property as described in deed reference Deed Book Volume 1009, Page 67, also being the place of beginning for the property herein intended to be described;

- #1- thence N 02 52 50 E 131.64 feet continuing along the common line for said Lots #6 & #9 to the Northwest corner of the South Half of said Lot #6, unmarked;
- #2- thence S 87 32 30 E 2617.95 feet along the Half Lot line for said Lot #6 to a stone (found) at the Northeast corner of the South Half of said Lot #6;
- #3- thence S 02 47 30 W 125.59 feet along the East line of said Lot #6 to a wood post (found) at the Southeast corner of said Franks property as described in Deed Book Volume 1009, Page 67;
- #4- thence N 87 40 30 W 2618.19 feet through said Lot #6, along the South line of said Franks property as described in Deed Book Volume 1009, Page 67 to the place of beginning, containing 7.73 acres.

The bearings within the description are based on State Plane Coordinate Grid derived from a Solar Observation (Local Hour Angle Method). Bearings are shown in a format of Degrees, Minutes, and Seconds. Iron pins (set) are 5/8" rebar with identification caps (C.R.Harkness P.L.S.6885).

This description was written by Charles R. Harkness Professional Land Surveyor #6885 from an actual survey completed on February 28, 1996, in accordance with Chapter 4733-37 of the Administrative Code, and is intended to be used for Quit Claim Deed purposes only for the property described and does not intend to describe all or any easements of record, nor encroachments unless otherwise indicated.

DESCRIPTION APPROVED
FOR AUDITOR'S TRANSFER

BY Charles R. Harkness

4-1-96

Charles R. Harkness P.L.S. #6885

OFFICE COPY
NOT RECORDABLE

Situated in the State of Ohio, County of Muskingum, Township of Hopewell:

Being part of Lots #5, #6, & #10, of the Third Quarter Township, Township #1, Range #9, of the US Military District, being that portion of Parcel One of the Rosamond Bendure property as described in deed reference Deed Book Volume 1118, Page 51 of said county's deed records, lying South of, the South line of the Walter Franks property as described in deed reference Deed Book Volume 1009, Page 67, known as Muskingum County Auditor's Parcel Number 25-30-03-33-000, being all of the remaining portion of Parcel Two of the Rosamond Bendure property as described in deed reference Deed Book Volume 1118, Page 51 of said county's deed records, known as Muskingum County Auditor's Parcel Number 25-30-03-32-000, being all of Parcel Three of the Rosamond Bendure property as described in deed reference Deed Book Volume 1118, Page 51 of said county's deed records, known as Muskingum County Auditor's Parcel Number 25-30-03-35-000:

LEGEND

- STONE (FOUND) WITH X -
- CONCRETE MONUMENT (FOUND)
- AXLE (FOUND)
- IRON PIPE (FOUND)
- IRON PIN (FOUND)
- RAILROAD SPIKE (FOUND)
- PK NAIL (FOUND)
- POINT
- IRON PIN (SET) 5/8" REBAR WITH IDENTIFICATION CAP (C R HARKNESS PLS 6885)



The bearings on this plat are based on State Plane Coordinate Grid as derived from a Solar Observation (Local Hour Angle Method).

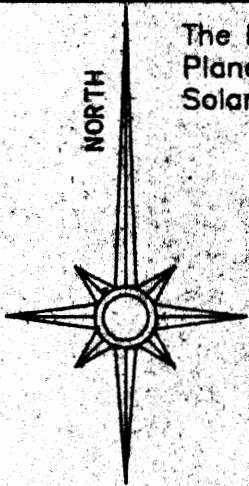

LOT # 7

W. Franks
Vol. 1009, Page 67

41.24 Acres
Parcel #25-30-03-33-000
R. Bendure
Vol. 1118, Page 51
(Parcel One)

137.01 Acres Total

92.74 Acres
Parcel #25-30-03-32-000
R. Bendure
Vol. 1118, Page 51
(Parcel Two)

BLOWUP
Not To Scale

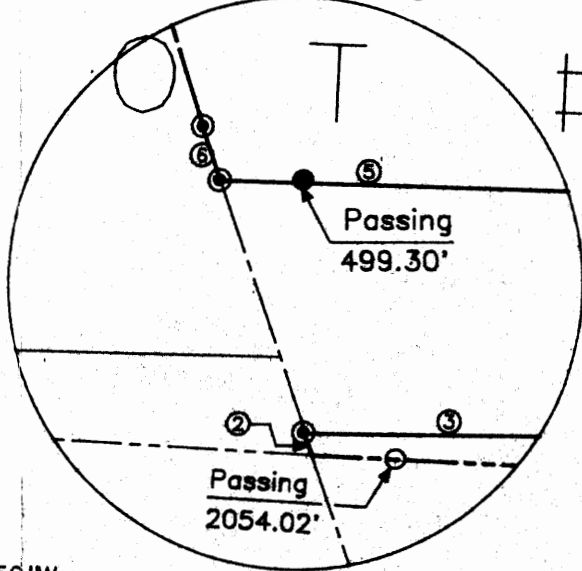

DESCRIPTION APPROVED
FOR AUDITORS TRANSFER

BY [Signature]
4-1-96

CALL DATA TABLE:

COURSE	BEARING	DISTANCE
1	N 86°51'10"W	2092.60'
2	N 18°46'30"W	10.22'
3	S 89°14'30"E	514.92'
4	N 05°33'50"W	110.75'
5	N 89°15'00"W	541.74'
6	N 18°48'00"W	34.15'
7	N 18°06'40"W	450.44'
8	N 19°37'20"W	57.26'
9	N 24°11'00"W	90.93'
10	N 30°23'20"W	101.25'
11	N 32°08'20"W	312.15'
12	N 31°48'50"W	231.01'
13	N 33°56'20"W	259.08'
14	N 26°42'00"W	112.70'
15	N 17°08'10"W	137.76'
16	S 88°04'40"E	379.14'
17	N 02°52'50"E	680.82'
18	S 87°40'30"E	2618.19'
19	S 02°47'30"W	691.16'
20	S 02°47'30"W	1700.32'

See Blowup

B. Bendure
Vol. 819, Page 135

D. Fink
Vol. 421, Page 42

REFERENCES NOT SHOWN OR LISTED:

- A previous survey completed by John R. Marshall, PLS #5307, of 1.00 acres, on 6-28-73, of the Ernest Zwahlen III property as described in deed reference Deed Book Volume 1039, Page 327.
- A previous survey completed by Richard Max Graves PLS #5792, of 1.334 acres, on 9-15-79.
- A previous survey completed by Richard Max Graves PLS #5792, of 5.00 acres, on 10-24-81.
- A previous survey completed by Timothy H. Linn PLS #7113, of 49.26 & 70.67 acres, on 12-30-87.
- A survey completed by Alexander Holmes, of the Southwest Quarter of Township #1, Range #9, in 1808.
- Muskingum County Tax Maps of the area.
- A USGS 7 1/2 Min Topo Quad Map (Gratiot).

This plat was prepared by C. R. Harkness Surveying & Mapping Inc. in accordance with Chapter 4733-37 of the Administrative Code, from an actual survey and is intended to be used in the legal transfer of the property shown and to be intended to show all or any easements of record, unless otherwise indicated.

OFFICE COPY
NOT RECORDABLE

Charles R. Harkness/PLS #6885

SURVEY FOR:

Bill Hill
Flint Ridge Road
Hopewell, Ohio 43746

SECTION: Qtr Twp #3 TOWNSHIP: #1 RANGE: #9
TWP: Hopewell COUNTY: Muskingum STATE OF OHIO

Survey Date: 2-28-96 Draw date 3-29-96 By: SBT

C. R. HARKNESS SURVEYING & MAPPING INC.
768 DRYDEN ROAD
Zanesville, Ohio 43701 Phone (614) 454-6367

Job Number:
#700

Drawing/Sheet No.
Plat #01