

to a point on the east right of way line of Raiders Road;

Thence along the east right of way line of said road the following ten courses:

- 1.) North 51 degrees 04 minutes 56 seconds West, 3.03 feet to a point;
- 2.) South 38 degrees 55 minutes 04 seconds West, 625.00 feet to a point;
- 3.) North 51 degrees 04 minutes 56 seconds West, 10.00 feet to a point;
- 4.) South 38 degrees 55 minutes 04 seconds West, 450.00 feet to a point;
- 5.) South 51 degrees 04 minutes 56 seconds East, 10.00 feet to a point;
- 6.) South 38 degrees 55 minutes 04 seconds West, 349.01 feet to a point;
- 7.) Along a curve to the left having a radius of 1869.86 feet and an arc length of 1199.89 feet, and a chord which bears South 20 degrees 32 minutes 03 seconds West, 1179.41 feet to a point;
- 8.) South 02 degrees 09 minutes 03 seconds West, 738.83 feet to a point;
- 9.) Along a curve to the right having a radius of 1472.39 feet and an arc length of 446.99 feet, and a chord which bears South 10 degrees 50 minutes 52 seconds West, 445.27 feet to a point on the northwest corner of lands presently owned by Harold and Nancy Fawcett, (OR 1796-906);

Thence across Raiders Road, North 41 degrees 52 minutes 02 seconds West, 91.90 feet to the principal place of beginning, containing 7.68 acres more or less;

Subject to all legal recorded easements and right of ways.

Iron pins set are 5/8 inch rebars, 30 inches long, with plastic identification caps.

Bearings are based on the Ohio State Plane Coordinate System, NAD 83, South Zone, Grid North, as per GPS Observations.

This description is written based on a field survey completed August 24, 2012, and previous field surveys by Jack D. Newcome, Reg. No. 7321.

OFFICE COPY
NOT RECORDABLE

Jack D. Newcome, Reg. No. 7321

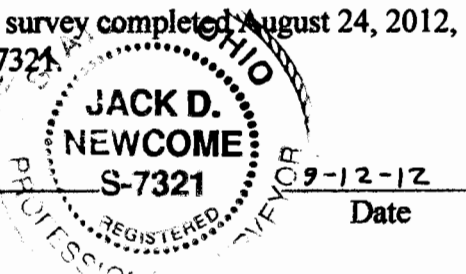

Parcel No.s

All of: 10-04-04-16-000 +- 0.77 Acres
All of: 10-04-07-09-000 +- 18.24 Acres
All of: 10-04-07-21-000 +- 0.05 Acres
All of: 10-04-07-10-000 +- 52.25 Acres
All of: 10-04-06-01-000 +- 198.49 Acres
All of: 10-04-06-15-000 +- 0.79 Acres
All of: 10-04-06-14-000 +- 0.50 Acres
All of: 10-04-15-03-000 +- 13.72 Acres
All of: 10-04-15-18-000 +- 2.37 Acres
Part of: 10-04-06-04-000 +- 12.84 Acres
Part of: 29-20-71-23-000 +- 16.05 Acres
Total - 585.05 Acres

All of: 10-04-05-15-000 +- 0.09 Acres
All of: 10-04-06-13-000 +- 0.54 Acres
All of: 10-04-06-18-000 +- 0.86 Acres
All of: 10-04-07-12-000 +- 24.49 Acres
All of: 10-04-07-22-000 +- 1.98 Acres
All of: 10-04-06-17-000 +- 0.17 Acres
All of: 10-04-06-07-000 +- 30.77 Acres
All of: 10-04-15-05-000 +- 75.67 Acres
Part of: 10-04-06-05-000 +- 73.83 Acres
All of: 29-50-01-01-001 +- 59.38 Acres
All of: 29-50-01-02-001 +- 1.20 Acres

DESCRIPTION

APPROVED

By: *[Signature]* 9/12/12