

SITUATED IN:

State of Ohio, County of Muskingum, Township of Licking, South Half of Quarter Township 1, and being part of Lot 6 of Robert's Survey, Township 2, Range 9, United States Military Lands

BASIS OF BEARINGS

Bearings are based on the Ohio State Plane Coordinate System, NAD 83, South Zone, Grid North as per GPS observations.

BUDS, Inc.  
OR 2835-396, Parcel 7  
+- 5.01 Acres

BUDS, Inc.  
OR 2835-396, Parcel 7

Jonah R. and  
Meghan Green  
OR 2982-277

John A. and  
Nancee L. Bay  
OR 1877-442

REFERENCES

All Official and Deed Records shown on this plat.

PARCEL NO.

Part of 35-10-71-05-000 +- 5.01 Acres  
(0.19 Ac. in R\W of Twp. Rd. 119)

LEGEND

- △ Railroad Spike Set
- Iron Pin Found
- ⊞ Stone Found
- Axle Found
- Iron Pipe Found
- ▲ Railroad Spike Found
- ⊙ Iron Pin Set, 5/8" rebar
- ⊠ Monument Found

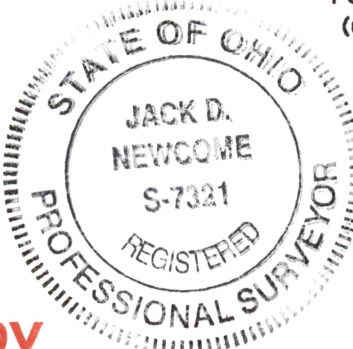

OFFICE COPY  
NOT RECORDABLE  
5-4-21  
Jack D. Newcome  
Date

Reg. Surveyor No. 7321

DESCRIPTION  
APPROVED  
By: M. S. Shaw

Stone Found at the Southwest  
Corner of Lot 6, of Robert's Survey,  
T 2, R 9, U. S. M. L.

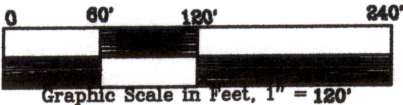

Newcome Surveying Company  
6515 Ballard Road  
Nashport, Ohio  
740-452-5796

