

Survey of Remainder of Michael S. and Lisa K. Havens Lands in Muskingum, Twp., Muskingum Co.

Situated in the State of Ohio, County of Muskingum, Township of Muskingum, Quarter Township 3, Military Lot 7, and being part of Lot 5, of Plow Share Acres Subdivision, (Pl. Bk. 12, Pg. 62, and 63), Township 2, Range 8, United States Military Lands, and being part of the lands presently owned by Michael S. and Lisa K. Havens, as per Deed Record 1147, Page 461, and being more particularly described as follows:

Beginning for reference and the principal place of beginning, at an iron pipe found on the Northeast corner of Lot 5, of Plow Share Acres Subdivision, (Pl. Bk. 12, Pg. 62, and 63), and being a on the west right of way of Winter Wood Drive, (Twp. Rd. 1515);

Thence along the east line of said Lot 5, and the west right of way of Winter Wood Drive, (Twp. Rd. 1515), South 02 degrees 20 minutes 17 seconds West, 259.75 feet to a point on the Southeast corner of Lot 5, from which an iron pipe found bears South 87 degrees 59 minutes 41 seconds East, 0.22 feet;

Thence along the south line of said Lot 5, North 87 degrees 59 minutes 41 seconds West, 486.78 feet to a point in the centerline of a stream, passing an iron pin set at 471.84 feet;

Thence through said Lot 5, and along the centerline of said stream, the following three courses:

- 1.) North 01 degrees 12 minutes 27 seconds West, 51.07 feet to a point;
- 2.) North 14 degrees 21 minutes 19 seconds West, 38.48 feet to a point;
- 3.) North 14 degrees 11 minutes 32 seconds East, 175.78 feet to a point on the north line of Lot 5, of said Plow Share Acres;

Thence along the north line of said Lot 5, South 87 degrees 59 minutes 43 seconds East, 464.88 feet to the principal place of beginning, passing iron pins found at 18.87 feet, and 45.67 feet, containing 2.90 acres, more or less, and being part of Auditor's Parcel Number 44-14-02-14-000.

Subject to all legal recorded easements and right of ways.

Iron pins set are 5/8 inch rebars , 30 inches long, with plastic identification caps.

Bearings are based on the Ohio State Plane Coordinate System, NAD 83, South Zone, Grid North as per GPS observations.

This description is written based on a field survey completed August 24, 2020, by Jack D. Newcome, Reg. No. 7321.

**OFFICE COPY**

**NOT RECORDABLE**

Jack D. Newcome, Reg. No. 7321

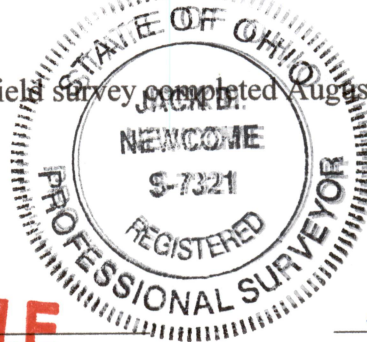

9-9-20

Date

DESCRIPTION

APPROVED

By: Ag 9/1/2020