

51-08-01-16-000 A

1. N 87°42'53" W a distance of 77.84 feet to an axle found;
2. S 02°44'55" W a distance of 146.96 feet to an axle found;
3. S 86°25'36" E a distance of 79.34 feet to an axle found on the southwest corner of the lands now owned by Christopher D. & Lori L. Snyder (OR 2369-737);

Thence with the south line of said Snyder's lands, S 87°47'10" E a distance of 65.91 feet to an axle found on the west line of the lands now owned by Sonora M. E. Church (DR 101-405);

Thence with the common line of said Church/Porter's lands the following two (2) courses:

1. S 01°18'53" W a distance of 21.36 feet to an iron pin set;
2. S 77°55'19" E a distance of 133.26 feet to an iron pin set on the west line of Jacob Bowers Add. (Plat Book 1, Page 57);

Thence with the west line of said Jacob Bowers Add., S 02°02'27" W a distance of 79.72 feet to an iron pin set on the northeast corner of the lands now owned by Larry Guy Whissel & Brenda Whissel (DR 994-282);

Thence with the perimeter of said Whissel's lands and then onto the lands now owned by Rebecca S. Whissel (OR 1747-808) the following two (2) courses:

1. N 87°57'33" W a distance of 80.00 feet to an iron pin set;
2. S 02°02'27" W a distance of 280.00 feet to an iron pin set on the south line of said Porter's lands, also being the south line of said Section 6;

Thence with the south line of said Section 6, the following two (2) courses:

1. N 87°57'33" W a distance of 668.75 feet to an iron pin found;
2. N 87°23'12" W a distance of 1531.37 feet to the principal place of beginning, containing a total of 78.277 acres more or less, subject to all legal highways and easements of record.

All bearings described herein are based on the Ohio State Plane Grid Coordinates, NAD83, Ohio South per GPS Observation.

All iron pins set are 5/8 inch by 30 inch steel rebar with plastic identification caps marked MCPEEK PS8517.

The above described 78.277 acre tract is based on a field survey made by McPeck Land Surveying, LLC on October 14<sup>th</sup>, 2020.

**OFFICE COPY**

Brian Kelly McPeck, PS 8517

**NOT RECORDABLE**

Parcel No.

All of: 51-08-01-16-000(+/- 78.277 ac.)

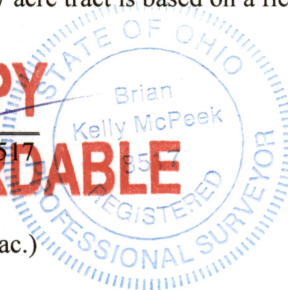

10/14/20  
Date

DESCRIPTION

APPROVED

By: A. B. [Signature]