

thence with the perimeter of said exception the following four (4) courses:

1. S 80°09'02" W a distance of 225.00 feet to an iron pin found (no cap);
2. N 09°35'33" W a distance of 120.00 feet to an iron pin found (no cap);
3. N 82°50'40" E a distance of 235.23 feet to an iron pin found (biedenbach);
4. S 04°20'20" E a distance of 109.45 feet to the place of beginning, containing a total of 0.605, acres more or less, subject to all legal highways and easements of record.

Containing a total of 73.130 acres more or less, subject to all legal highways and easements of records.

All bearings described herein are based on the Ohio State Plane Grid Coordinates, NAD83, Ohio South per GPS Observation.

All iron pins set are 5/8 inch by 30 inch steel rebar with plastic identification caps marked MCPEEK PS8517.

The above described 73.130 acre tract is based on a field survey made by McPeek Land Surveying, LLC on June 20th, 2024.

**OFFICE COPY
NOT RECORDABLE**
Brian Kelly McPeek, PS 8517

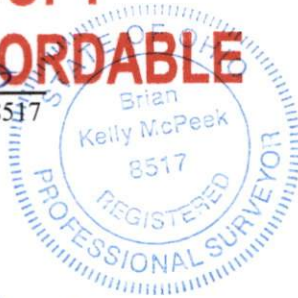

6/27/24
Date

DESCRIPTION

APPROVED

By: AK 7/8/24