

51-80-22-03-006



www.mcpeeklandsurveying.com
email: brian@mcpeeklandsurveying.com
340 Robin Hood Ln., * Zanesville, Oh 43701 * 740.704.6073

James Duane Davis & Janice A. Davis
OR 2472-513
+/-3.527 Ac.

Situated in the State of Ohio, County of Muskingum, Township of Perry, Northeast Quarter of Section 22, T1, R6 and also being part of the lands now owned by James Duane Davis & Janice A. Davis (OR 2472-513) of the Muskingum County Recorders Office and more particularly described as follows.

Beginning for reference at the northeast corner of the northeast quarter of said Section 22, thence S 35°00'05" W a distance of 1450.96 feet to an iron pin set within said Davis' lands and the principal place of beginning;

thence with a line going through said Davis' lands the following four (4) courses:

1. S 40°22'15" E a distance of 81.21 feet to an iron pin set;
2. S 00°05'21" E a distance of 254.15 feet to an iron pin set;
3. S 67°07'32" W a distance of 140.19 feet to an iron pin set;
4. N 89°03'57" W a distance of 364.04 feet to a point in the center of Long Road (T-209), passing an iron pin set at 350.86 feet;

thence with the center of said Long Road the following four (4) courses:

1. N 01°44'09" W a distance of 91.59 feet to a point;
2. N 02°53'54" W a distance of 72.27 feet to a point;
3. N 05°35'19" W a distance of 30.14 feet to a point;
4. N 09°26'10" W a distance of 56.56 feet to a point;

thence leaving the center of said Long Road and going through said Davis' lands, N 75°55'17" E a distance of 473.01 feet to the place of beginning, passing an iron pin set at 19.59 feet, containing 3.527 acres more or less, subject to all legal highways and easements of record.

All bearings described herein are based on the Ohio State Plane Grid Coordinates, NAD83, Ohio South per GPS Observation.

All iron pins set are 5/8 inch by 30 inch steel rebar with plastic identification caps marked MCPEEK PS8517.

The above described 3.527 acre parcel is based on a field survey made by Brian K. McPeek, PS 8517 of McPeek Land Surveying, LLC on September 24th, 2019.

Parcel No.

Part of: 51-80-22-03-000 (+/-3.527 Ac.)

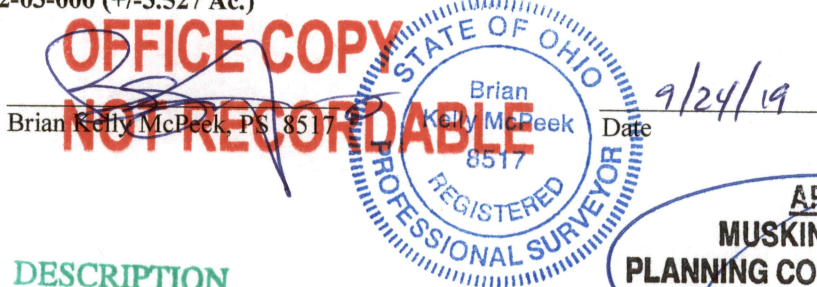

DESCRIPTION

APPROVED

By: [Signature]

APPROVED
MUSKINGUM COUNTY
PLANNING COMMISSION DIRECTOR

Date

Fee Paid