

62-84-01-10-001



www.mcpeeklandsurveying.com  
email: brian@mcpeeklandsurveying.com  
340 Robin Hood Ln., \* Zanesville, Oh 43701 \* 740.704.6073

**Gregory D. Smith & Derek V. Smith**  
**OR 2478-718**  
**+/-12.251 Acres**

Situated in the State of Ohio, County of Muskingum, Township of Springfield, South Half of Section 5, T11, R13 being part of the lands now owned by Gregory D. Smith & Derek V. Smith as recorded in OR 2478-718 of the Muskingum County Recorder's Office and more particularly described as follows.

Beginning for reference at an iron pin found at the southwest corner of the southeast quarter of said Section 5, thence N 56°01'22" E a distance of 576.51 feet to an iron pin set on the south line of said Smith's lands and the principal place of beginning;

Thence going through said Smith's lands the following two (2) courses:

1. N 08°21'09" W a distance of 383.06 feet to an iron pin set;
2. S 88°24'26" W a distance of 923.86 feet to a point in the road bed of Granger Hill Road (T-129), passing an iron pin set at 902.68 feet;

Thence with the east line of the land now owned Michael M. & Wendi C. Smith (OR 2889-498) also being in the road bed of said Granger Hill Road, N 10°55'22" W a distance of 59.56 feet to a point at the northwest corner of said Smith's lands;

Thence with the north line of said Smith's lands, N 88°21'16" E a distance of 1627.24 feet to an iron pin found on the north west corner of the lands now owned by Steven P. Wayne (OR 1818-507), passing an iron pin found at 25.01 feet;

Thence with the west line of said Wayne's lands the following three (3) courses:

1. S 52°07'46" E a distance of 359.00 feet to an iron pin found;
2. S 50°07'46" E a distance of 355.10 feet to an iron pin found;
3. S 38°26'06" E a distance of 111.71 feet to an iron pin set at the southeast corner of said Smith's lands;

Thence with the south line of said Smith's lands, N 86°30'26" W a distance of 1263.85 to the place of beginning, containing a total of 12.251 acres more or less, subject to all legal highways and easements of record.

All bearings described herein are based on the Ohio State Plane Grid Coordinates, NAD83, Ohio South, Grid North per GPS Observation.

All iron pins set are 5/8 inch by 30 inch steel rebar with plastic identification caps marked MCPEEK PS8517.

The above described 12.251 acre parcel is based on a field survey made by McPeek Land Surveying on June 5<sup>th</sup>, 2020.

**OFFICE COPY**  
**NOT RECORDABLE**

Brian Kelly McPeek, PS 8517

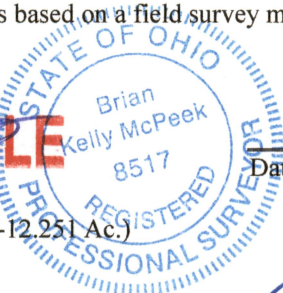

6/12/20  
Date

**Parcel No.** Part of: 62-84-01-10-000 (+/-12.251 Ac.)

DESCRIPTION

APPROVED

By: 6/17/hw

**APPROVED**  
**MUSKINGUM COUNTY**  
**PLANNING COMMISSION DIRECTOR**

6/29/2020  
Date

Fee Paid