

66-27-04-34-001 A

Situated in the State of Ohio, County of Muskingum, Village of New Concord, and being a part of the Southwest Quarter of Section 1, Union Township, Township 1, Range 5, United States Military Lands; and being part of lands currently owned by Muskingum College (DR 191-127), and being more particularly described as follows:

Beginning for reference at the northeast corner of Lot 1, Dr. Henry McCreary's 1st Addition to New Concord as the same is designated on Muskingum County Plat Book 3, Page 123, from which an iron pin found on the northwest corner of The United Presbyterian Church of New Concord (DB 197-544) bears North 84 degrees 22 minutes 13 seconds East a distance of 96.44 feet;

thence along the north line of said Lot 1, also being the south right of way of High Street, South 84 degrees 38 minutes 13 seconds West 23.00 feet to an iron pin found;

thence crossing High Street, North 47 degrees 51 minutes 11 seconds East 66.80 feet to a point on the north right of way of High Street, also being the southeast corner of lands currently owned by Muskingum College (DR 191-127), and the principal place of beginning;

thence through the lands of said Muskingum College the following twenty one courses:

- 1) South 84 degrees 38 minutes 13 seconds West 40.36 feet to a point;
- 2) North 11 degrees 21 minutes 41 seconds East 13.27 feet to a point;
- 3) North 37 degrees 51 minutes 00 seconds West 140.31 feet to a point;
- 4) with a curve to the right having a radius of 312.00 feet, an arc length of 246.57 feet, a chord bearing North 15 degrees 33 minutes 49 seconds West, and a chord length of 240.20 feet;
- 5) North 07 degrees 04 minutes 34 seconds East 35.13 feet to a point;
- 6) with a curve to the left having a radius of 288.00 feet, an arc length of 52.97 feet, a chord bearing North 01 degrees 48 minutes 27 seconds East, and a chord length of 52.89 feet;
- 7) North 61 degrees 13 minutes 40 seconds West 58.95 feet to a point;
- 8) South 84 degrees 48 minutes 42 seconds West 141.63 feet to a point;
- 9) North 04 degrees 16 minutes 43 seconds West 52.68 feet to a point;
- 10) North 84 degrees 57 minutes 34 seconds East 196.67 feet to a point;
- 11) North 02 degrees 45 minutes 51 seconds West 80.23 feet to a point;
- 12) North 05 degrees 53 minutes 01 seconds West 23.80 feet to a point;
- 13) with a curve to the left having a radius of 45.00 feet, an arc length of 20.79 feet, a chord bearing North 19 degrees 07 minutes 05 seconds West, and a chord length of 20.60 feet;
- 14) North 32 degrees 21 minutes 10 seconds West 25.05 feet to a point;
- 15) North 84 degrees 51 minutes 42 seconds East 22.68 feet to a point;
- 16) with a curve to the right having a radius of 112.00 feet, an arc length of 62.61 feet, a chord bearing South 18 degrees 52 minutes 32 seconds East, and a chord length of 61.79 feet;
- 17) South 02 degrees 51 minutes 44 seconds East 175.41 feet to a point;
- 18) with a curve to the right having a radius of 312.00 feet, an arc length of 54.12 feet, a chord bearing South 02 degrees 06 minutes 25 seconds West, and a chord length of 54.05 feet;
- 19) South 07 degrees 04 minutes 34 seconds West 35.13 feet to a point;
- 20) with a curve to the left having a radius of 288.00 feet, an arc length of 227.60 feet, a chord bearing South 15 degrees 33 minutes 49 seconds East, and a chord length of 221.72 feet;
- 21) South 37 degrees 51 minutes 00 seconds East 170.80 feet to the principal place of beginning, containing 0.639 acres, more or less, subject to all easements and right of ways, written or implied.

Bearings are based on the Ohio State Plane Coordinate System, South Zone, North American Datum 1983, as per GPS observations made October 21, 2019.

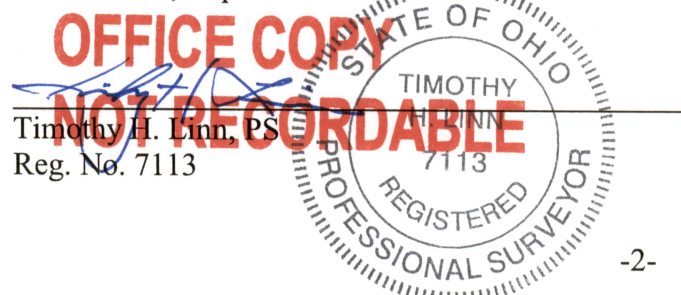

11/11/19  
Date

DESCRIPTION

APPROVED

By: *DeWitt Long*