



www.mcpeeklandsurveying.com
email: brian@mcpeeklandsurveying.com
340 Robin Hood Ln., * Zanesville, Oh 43701 * 740.704.6073

Charlotte Ann Sharp
OR 2189-278
+/- 4.840 Acres

Situated in the State of Ohio, County of Muskingum, Township of Washington, being part of the 3rd Quarter Township, Township 1, Range 7 and being all of the land now owned by Charlotte Ann Sharp as recorded in OR 2189-278 of the Muskingum County Recorders Office and more fully described as follows.

Beginning for reference at the southwest corner of Lot 3, John C. Howards Sub. (DR 9-394) and going South 54 degrees 26 minutes 34 seconds West, 374.61 feet to an iron pin found on the south side of Wedgewood Drive and on the northwest corner of the lands now owned by Barbara L. Dailey (DR 1146-774) and the principal place of beginning;

thence with the the common line of said Sharp & Dailey's lands the following two (2) courses:

1. South 02 degrees 23 minutes 13 seconds West, 238.66 feet to a pipe found;
2. South 89 degrees 41 minutes 49 seconds East, 90.81 feet to an iron pin set on the northwest corner of the lands now owned by Larzelere Real Estate Company, Ltd. (OR 1956-566);

thence with the west line of said Larzelere Real Estate's lands, South 01 degrees 35 minutes 13 seconds West, 349.13 feet to a point on the northeasterly corner of the lands now owned by Westwood Baptist Church, Inc. (OR 2487-258), said point is referenced by an iron pin set which bears, South 02 degrees 22 minutes 00 seconds West, 233.52 feet;

thence with the common line of said Sharp & Westwood Baptist Church's lands, South 62 degrees 25 minutes 17 seconds West, 451.48 feet to a point which lies in the west bound lane of Interstate 70, said point is referenced by an iron pin set which bears, South 01 degrees 26 minutes 54 seconds West, 53.86 feet;

thence with the west line of said Sharp's lands, North 01 degrees 26 minutes 54 seconds East, 560.29 feet to a pipe found on the south line of the land now owned by Paul A. Zemba & Frances K. Zemba (DR 994-351);

thence with the common line of said Sharp and Zemba's lands the following two (2) courses:

1. South 89 degrees 41 minutes 49 seconds East, 173.39 feet to an iron pin set;
2. North 02 degrees 23 minutes 13 seconds East, 236.11 feet to an axle found on the south line of said Wedgewood Drive;

thence with the south line of said Wedgewood Drive, North 89 degrees 11 minutes 47 seconds East, 131.62 feet to the place of beginning, containing 4.840 acres more or less, where 0.716 acres lies in Muskingum County Parcel 70-48-03-12-000 and 4.124 acres lies in Muskingum County Parcel 70-48-03-13-000 (0.913 acres of the 4.124 acres lies within the right of way of I-70) subject to all legal highways and easements of record.

All bearings described herein are based on the Ohio State Plane Grid Coordinates, NAD83, Ohio South per GPS Observation.

All iron pins set are 5/8 inch by 30 inch steel rebar with plastic identification caps marked MCPEEK PS8517.

The above described 4.840 acre parcel is based on a field survey made by Brian K. McPeek, PS 8517 of McPeek Land Surveying, LLC on July 28th, 2015.

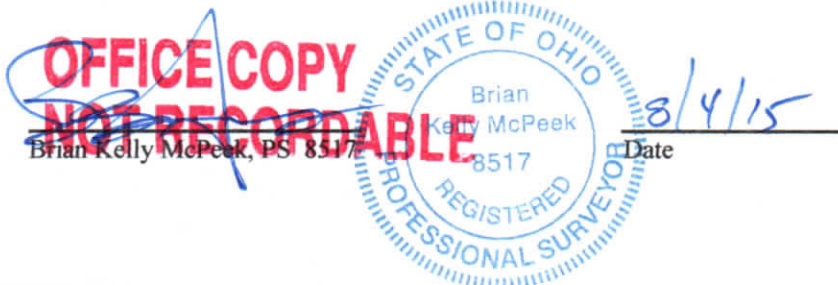

Parcel No.

All of: 70-48-03-12-000 (+/- 0.716 Ac.)

All of: 70-48-03-13-000 (+/- 4.124 Ac.)

Total +/- 4.840 Ac.

DESCRIPTION
APPROVED
By: *[Signature]* 8/5/2015



SITUATED IN

The State of Ohio, County of Muskingum
Township of Washington and being part of
the 3rd Qtr. Twp., T1, R7.

RESURVEY

BASIS OF BEARING

Bearings are based on State Plane Grid Coordinates,
NAD83, Ohio South, per GPS Observation.

Southwest Corner of Lot 3
John C. Howards Sub.
DR 9-394.

LEGEND

- Iron Pin Found
- Pipe Found w/cap
- ⌵ Property Hook
- ⊙ Iron Pin Set
- Axle Found

DESCRIPTION
APPROVED
By: *[Signature]* 8/15/2015

Barbara L.
Dailey
DR 1146-774

Paul A. Zemba &
Frances K. Zemba
DR 994-351

70-48-03-12-000
±0.716 Ac.

OR 2189-278

Susan A. Zemba
OR 1683-421

70-48-03-13-000
±4.124 Ac.

Charlotte Ann Sharp
OR 2189-278
±4.840 Ac. (Total)

Larzelere Real Estate Company, Ltd.
OR 1956-566

560.29'
N 01°26'54" E

LIMITED ACCESS RIGHT OF WAY FOR INTERSTATE 70
(CALCULATED)

subject to a perpetual easement and right
of way for public highway and road purposes
to the state of Ohio (DR 513-595)

±0.913 Ac. of
70-48-03-13-000
in Right of Way

58+28.4
50.3' Lt.

WEST BOUND LANE OF I-70

Westwood Baptist Church, Inc.
OR 2487-258

S 01°26'54" W
53.86'

(ref pin set)

(ref pin set)

PARCEL NO.

All of: 70-48-03-12-000(±0.716 Ac)
All of: 70-48-03-13-000(±4.124 Ac) Total(±4.840 Ac)

GRAPHIC SCALE

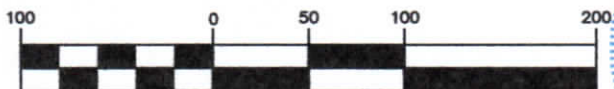

(IN FEET)
1 inch = 100 ft.



**MCPECK
LAND
SURVEYING**

www.mcpecklandsurveying.com
email: brian@mcpecklandsurveying.com
340 Robin Hood Ln., * Zanesville, Oh 43701 * 740.704.6073