

TRACT TWO:

Being all of Lot 1 and part of Lot 2 of Samuel Atkinson's plat of Georgetown as designated and delineated in Re-plat Book 1, Page 236, also being all of the lands now owned by Fred A. Roush as recorded in the following Muskingum County Records: DR 892-155, OR 1798-808, and OR 1847-501, being more particularly described as follows:

Beginning for reference at the southeast corner of Lot 2 of Samuel Atkinson's plat of Georgetown as designated and delineated in Re-plat Book 1, Page 236, from which an iron pin found bears South 02 degrees 04 minutes 12 seconds East, a distance of 14.68 feet;

thence along the east line of said Lot 2 and the west line of Marble Alley (16.5' R/W), North 02 degrees 04 minutes 12 seconds West 20.85 feet to the northeast corner of lands now owned by Lance and Nicole Shirer (OR 2391-743), and the principal place of beginning;

thence along said Shirer's south line, South 88 degrees 15 minutes 55 seconds West 165.00 feet to a point on the west line of said Lot 2 and east right of way of Putnam Avenue (66' R/W), passing an iron pin found at 1.00 foot;

thence along said east right of way of Putnam Avenue, North 02 degrees 04 minutes 14 seconds West 87.23 feet to a point on the southwest corner of lands now owned by Fred A. Roush (OR 1847-500);

thence along the south line of said Roush's land, North 87 degrees 56 minutes 17 seconds East 165.00 feet to the west line of said Marble Alley;

thence along the said west line of Marble Alley, South 02 degrees 04 minutes 12 seconds East 88.15 feet to the principal place of beginning,

containing 0.33 acres more or less, subject to all legal road right of ways and applicable easements, written or implied.

TRACT TWO PARCEL NUMBERS:

All of Parcel No.:	80-81-06-02-13-000 (0.091 ac)	Part of Lot One
All of Parcel No.:	80-81-06-02-14-000 (0.117 ac)	Part of Lot One
All of Parcel No.:	80-81-06-02-15-000 (0.125 ac)	Part of Lot Two
Total	0.33 acres	

Iron pins set are 5/8 inch diameter by 30 inch long rebar with a plastic identification cap.

Bearings are based on Ohio State Plane Coordinate System, South Zone, NAD 83, from GPS observations made on March 4, 2013.

This description is written based on a survey completed March 8, 2013 by Timothy H. Linn, Reg. No. 7113.

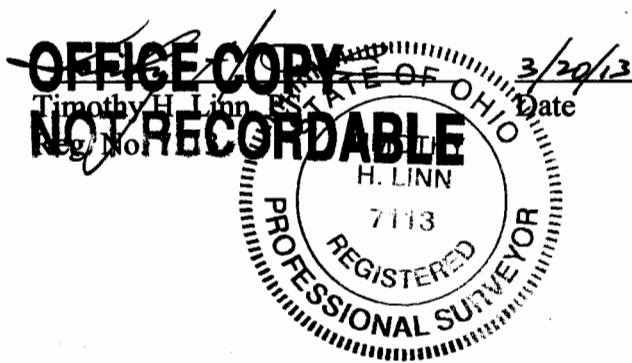

DESCRIPTION
APPROVED
By: [Signature] 3/22/2013