

81-18-02-08.000



www.mcpeeklandsurveying.com  
email: brian@mcpeeklandsurveying.com  
340 Robin Hood Ln., \* Zanesville, Oh 43701 \* 740.704.6073

**Nicole Theresa Wolfinger & Peter Jason Hutson**  
**OR 1897-892**  
**+/-0.240 Acres**

Situated in the State of Ohio, County of Muskingum, City of Zanesville, Part of Out Lot 27 of the Town of Putnam and being all of the lands now owned by Nicole Theresa Wolfinger & Peter Jason Hutson, (OR 1897-892) of the Muskingum County Recorders Office and more particularly described as follows.

Beginning for reference at a pipe found at the northeast corner of Out Lot 27, thence with the west line of Woodlawn Avenue, S02°08'16"E, a distance of 398.65 feet to a pipe found on the southeast corner of the lands now owned by Putnam Presbyterian Church (Trust Presbyterian Church) and the principal place of beginning;  
thence continuing with the west line of said Woodlawn Avenue, S02°08'16"E, a distance of 61.00 feet to a point on the northeast corner of the lands now owned by Tobin L. Settles (OR 2039-473), said point is referenced by an iron pin found that bears, N66°27'08"E, a distance of 0.43 feet;  
thence with the north line of said Settles lands, S87°58'52"W feet, a distance of 168.27 feet to an iron pin found on the southeast corner of the lands now owned by The Board of County Commissioners of Muskingum County (DR 558-441);  
thence with the west line of said Wolfinger/Hutson, N01°53'17"W, a distance of 61.00 feet to a point on the south line of said Putnam Presbyterian Church's lands;  
thence with the common line of said Putnam Presbyterian Church's lands and the lands of said Wolfinger/Hutson, N87°58'52"E, a distance of 168.00 feet to the place of beginning, passing an iron pin set at 5.00 feet, containing 0.240 acres more or less, subject to all legal highways and easements of record.

All bearings described herein are based on the Ohio State Plane Grid Coordinates, NAD83, Ohio South per GPS Observation.

All iron pins set are 5/8 inch by 30 inch steel rebar with plastic identification caps marked MCPEEK PS8517.

The above described 0.240 acre parcel is based on a field survey made by Brian K. McPeek, PS 8517 of McPeek Land Surveying, LLC on October 20th, 2017.

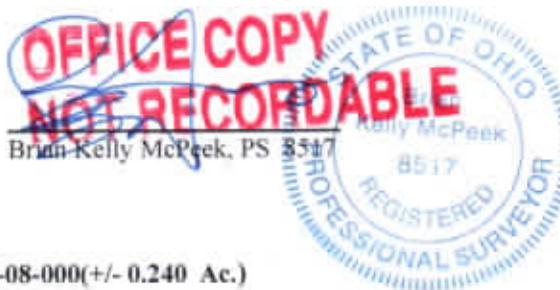

10/24/17  
Date

Parcel No.

All of: 81-18-02-08-000(+/- 0.240 Ac.)

DESCRIPTION  
APPROVED  
By: [Signature] 11/3/2017

www.mcpeeklandsurveying.com  
email: brian@mcpeeklandsurveying.com  
340 Robin Hood Ln.,\* Zanesville, Oh 43701 \* 740.704.6073



WOODLAWN AVE. (66')

$$\begin{array}{r} \text{OL } 22 \\ \text{SE Cmr. OL } 2 \\ \hline \text{NE Cmr. OL } 2 \\ \text{OL } 27 \end{array}$$

SE Cnr. OL 22  
NE Cnr. OL 27

POB

N 87°58'52" E 168.00' (Total)

S 87°58'52" W 168.27

DESCRIPTION  
APPROVED  
By: PM

Tobin L. Settles  
OR 2039-473