

thence along said Muskingum County Land Reutilization Corporation land the following three courses:

- 1) North 01 degrees 25 minutes 09 seconds East 121.00 feet to an iron pin set, passing an iron pin found at 101.75 feet;
- 2) North 89 degrees 32 minutes 07 seconds West 113.62 feet to an iron pin set;
- 3) North 04 degrees 05 minutes 17 seconds East 11.88 feet to the principal place of beginning;

containing 0.187 acres, more or less, subject to all easements and right of ways, written or implied.

Iron pins set are 5/8 inch x 30 inch long rebar with a plastic ID cap.

Bearings are based on Ohio State Plane Coordinate System, NAD 83, South Zone, Grid North, as per GPS observations made on December 30, 2020.

This description is written based on a survey completed January 14, 2021 by Timothy H. Linn, Reg. No. 7113.

OFFICE COPY

NOT RECORDABLE
Timothy H. Linn, PS, Reg. No. 7113

1/19/21
Date

Parcel No.:

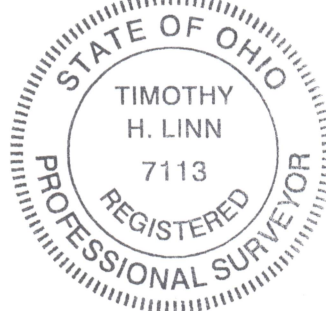
All of: 81-52-05-07-000 +/- 0.187 ac.



DESCRIPTION

APPROVED

By: 