

Survey Split of Red Door Professional Solutions LLC Lands on Somers Street in Zanesville

Situated in the State of Ohio, County of Muskingum, City of Zanesville, and being all of Lot 35, and part of Lot 36, of Kathie Heights Subdivision, as per Plat Book 8, Pg. 7, Township 1, Range 8, United States Military Lands, and being part of the lands presently owned by Red Door Professional Solutions LLC, as per Official Record 3158, Page 898, and being more particularly described as follows:

Beginning for reference and the principal place of beginning, at an iron pipe found at the northwest corner of Lot 35, of Kathie Heights Subdivision, (Pl. Bk. 8, Pg. 7);

Thence along the south line of Somers Street, (R\W 40'), South 88 degrees 05 minutes 59 seconds East, 50.00 feet to a point;

Thence along a curve to the left with a delta angle of 45 degrees 33 minutes 01 seconds, an arc length of 47.70 feet, a radius of 60.00 feet, and a chord which bears North 69 degrees 07 minutes 23 seconds East, 46.46 feet to an iron pin set on the north line of Lot 36;

Thence through Lot 36, and being the lands presently owned by Red Door Professional Solutions LLC, (OR 3198-898), South 30 degrees 04 minutes 25 seconds East, 138.66 feet to an iron pin set, on the north line of lands presently owned by Zanesville Metropolitan Housing Authority, (DR 1149-506);

Thence along the north line of said Housing Authority, and the south lines of Lot 36, and 35, North 88 degrees 12 minutes 27 seconds West, 167.44 feet to an iron pipe found, on the southeast corner of Lot 24, passing an iron pipe found at 47.60 feet;

Thence along the east line of Lot 24, and the east line of lands presently owned by Kimberly Patton, (OR 2605-866), North 02 degrees 34 minutes 23 seconds East, 99.96 feet to the principal place of beginning, containing 0.319 Acres, more or less, and being all of Auditor's Parcel Number 86-24-05-04-000 +- 0.219 Acres, and part of Auditor's Parcel Number 86-24-05-03-000 +- 0.100 Acres.

Subject to all legal recorded easements and right of ways.

Iron pins set are 5\8 inch rebars, 30 inches long, with plastic identification caps.

Bearings are based on the Ohio State Plane Coordinate System, NAD 83(2011), South Zone, Grid North, as per G.P.S. observations.

This description is written based on a field survey completed December 4, 2023 by Jack D. Newcome, Reg. No. 7321

Jack D. Newcome

Jack D. Newcome, Reg. No. 7321

12-4-23

Date

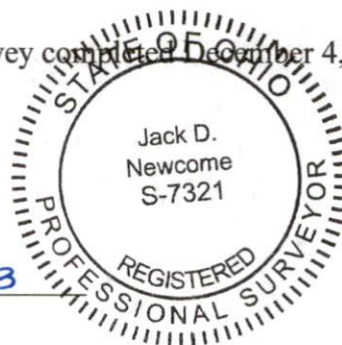

APPROVED BY CITY PLANNING COMMISSION,
ZANESVILLE, OHIO;
NO PLAT REQUIRED

Dore Miller 1-3-2024

DESCRIPTION
APPROVED

By: *MB* 1-3-2024