

thence along the west line of said Garner's lands, South 01 degrees 35 minutes 50 seconds West 104.34 feet to a PK nail set on said Garner's southwest corner and the north line of said Beverly Avenue;

thence along the north line of said Beverly Avenue, North 88 degrees 09 minutes 27 seconds West 200.08 feet to the place of beginning, passing an axle found at 100.55 feet on the southwest corner of said Lot 18;

containing 1.203 acres, more or less, subject to all easements and right of ways, written or implied.

Iron pins set are 5/8 inch rebar, 30 inches long, with plastic identification caps.

Bearings are based on the Ohio State Plane Coordinate system, NAD 83, South Zone, Grid South, as per GPS observations made on March 27, 2020.

This description is written based on a survey completed April 30, 2021 by Timothy H. Linn, Reg. No. 7113.

OFFICE COPY
NOT RECORDABLE
Timothy H. Linn, PS, Reg. No. 7113

PARCEL NO.:

All of: 86-28-01-01-000 +/-0.143 ac.
All of: 86-28-01-02-000 +/-0.088 ac.
All of: 86-28-01-04-000 +/-0.033 ac.
All of: 86-28-01-05-000 +/-0.148 ac.
All of: 86-28-01-06-000 +/-0.149 ac.
All of: 86-28-01-07-000 +/-0.047 ac.
All of: 86-28-01-29-000 +/-0.149 ac.
All of: 86-28-01-30-000 +/-0.148 ac.
All of: 86-28-01-31-000 +/-0.150 ac.
All of: 86-28-01-32-000 +/-0.148 ac.
Total +/-1.203 ac.

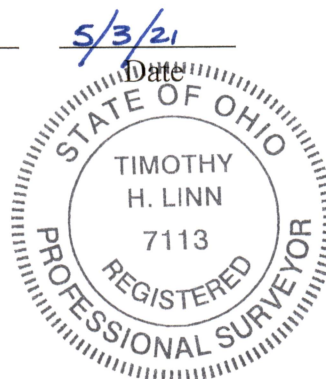

DESCRIPTION
APPROVED

By: Ms S J Linn