

**+ - 5.93 Acre Split from the State of Ohio, Department of Natural Resources**

Situated in the State of Ohio, County of Muskingum, Township of Adams, and being part of the Northwest Quarter of Section 16, Township 3, Range 6, United States Military Lands, and being part of the lands presently owned by the State of Ohio, Department of Natural Resources as per Official Record 1130, Page 799, and being more particularly described as follows:

Beginning for reference and the principal place of beginning, at an iron pipe found at the Northeast corner of the Northwest Quarter of Section 16;

Thence along the mid-section line, South 01 degrees 48 minutes 42 seconds West, 530.70 feet to a point in Bethesda Church Road, passing a monument found at 5.00 feet;

Thence through lands presently owned by the State of Ohio, Department of Natural Resources, (OR 1130-779) the following two courses:

- 1.) North 87 degrees 31 minutes 55 seconds West, 496.70 feet to an iron pin set, passing an iron pin set at 21.27 feet;
- 2.) North 02 degrees 43 minutes 29 seconds East, 518.50 feet to an iron pipe found on the southwest corner of lands presently owned by John E. and Julia Vansickle, (DR 1044-277);

Thence along the south line of said Vansickle lands, South 88 degrees 57 minutes 31 seconds East, 488.45 feet to the principal place of beginning, passing an iron pin found at 458.45 feet, containing 5.93 acres more or less;

Subject to all legal recorded easements and right of ways.

Iron pins set are 5/8 inch rebars, 30 inches long, with plastic identification caps.

Bearings are based on the north line of Section 16, as being South 88 degrees 57 minutes 31 seconds East, as per previous survey of the Tri-Valley Wildlife Area by J. D. Newcome.

This description is written based on a field survey completed Jan 23, 2012, by Jack D. Newcome, Reg. No. 7321.

**OFFICE COPY**

**NOT RECORDABLE**

Jack D. Newcome, Reg. No. 7321

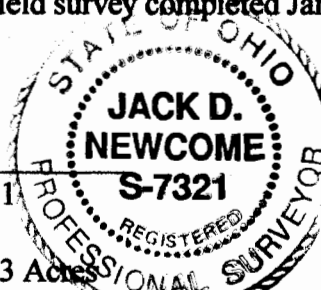

2-3-12  
Date

Parcel No.- Part of: 02-40-16-03-000 +- 5.93 Acres

Note: Not to be used as a separate building site or transferred as an independent parcel in the future without planning commission approval in accordance with applicable subdivision requirements. Parcel to be combined to parcel no. 02-40-15-10-000

**APPROVED**

**MINOR LOT SPLIT ONLY**

**MUSKINGUM COUNTY**

**PLANNING COMMISSION DIRECTOR**

2/9/12  
Date

Fee Paid

DESCRIPTION

APPROVED

By:

*[Signature]* 2/7/12