

Jerry and Kelly Waters  
Part of Parcel No. 06-50-16-01-015  
10.00 Acres

Situated in the State of Ohio, County of Muskingum, Township of Blue Rock:  
Being a part of the southwest and the northwest Quarters of Section Sixteen (16 ),  
Township Twelve (12 ), Range Twelve (12 ) of the Congress Lands East of the Scioto  
River and part of a 56.462 acre parcel owned by Rodney G. Driggs and Recorded in Deed  
Book 1130, Page 136 of the Muskingum County Deed Records bounded and described as  
follows:

Beginning at an iron pin set at the southwest corner of the northwest quarter of  
section 16, said pin bears the following 2 courses and distances from the southwest  
corner of said section 16:

1- N 2°41' 16"E 1091.10 feet

2- N 1°34'58" E 1544.19 feet; thence N 1° 34' 58" E ( the base of bearings for this  
description is state plane grid from a solar observation ) along the west line of said 16  
and the west line of the grantors property 241.26 feet to a point in the center of Shaver  
Road and passing through an iron pin found at 193.23 feet; thence along the center of  
said road the south line of property owned by D. Kelly et al ( Vol. 1136, Pg. 922 ), the  
south line of property owned by Samuel and Barbara Swartz ( Vol. 896, Pg. 33 and 795,  
Pg. 175 ) the following 11 courses and distances:

1- S 62° 14' 15" E 86.82 feet to a point which bears N 80° 26' 00" W 84.82 feet from an  
iron pin set

2- S 70° 04' 58" E 156.93 feet to a point

3- S 55° 56' 56" E 56.75 feet to a point

4- S 49° 48'58" E 34.61 feet to a point

5- S 45° 04' 22" E 69.62 feet to a point

6- S 39° 47' 33" E 130.73 feet to a point which bears S 3° 44' 15" E 29.95 feet from an  
iron pin set

7- S 42° 05' 14" E 113.65 feet to a point

8- S 45°35' 09" E 75.80 feet to a point which bears N 66° 11' 01" W 53.33 feet from an  
iron pin set

9- S 53° 01' 10 E" 123.94 feet to a point

10- S 62° 45' 03" E 97.59 feet to a point

11- S 73° 39' 24" E 66.74 feet to a point at the northwest corner of a 2.593 acre parcel  
owned by Jerry and Kelly Waters ( Vol. 1532, Pg. 319 ); thence S 41° 21 30" W along  
the westerly line of said Waters property 450.07 feet to an iron pin found and passing  
through an iron pin found at 25.23 feet; thence N 75° 17' 53"W 552.92 feet to an iron pin  
set on the west line of the southwest quarter of said section 16; thence N 1° 34' 58" E  
along the west line of said section 529.56 feet containing ten and no hundredths ( 10.00 )  
acres.

Part of Auditors Parcel No. 06-50-16-01-015.

Subject to all legal right of ways and easements on record.

All iron pins set are 5/8" rebar with plastic cap Graves No. 5792.

This description was written May 28, 2002 from a field survey made by Richard

Max Graves Registered Sueveyor No. 5792.

DESCRIPTION APPROVED  
FOR AUDITOR'S TRANSFER  
BY 

6-21-2002

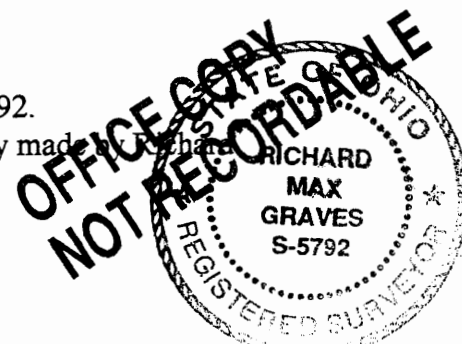

- 5/8" x 30" REBAR SET CAPPED GRAYES #5792
- REBAR FOUND - CAPPED BIEDENBACK #5718
- REBAR FOUND CAPPED #5792

1" = 100'



A horizontal graphic scale bar with alternating black and white segments. It is marked with '0', '50', '100', and '200' at regular intervals.

OL. 1130, Pg. 136  
OL. 1532, Pg. 319

SGS PHILO QUAD.  
BLUE ROCK TAX MAP 06-50

AP SHOWING 10.00 AC. SURVEY  
ART OF PROPERTY OWNED BY  
ODNEY G. DRIGGS VOL. 1130, Pg. 136  
✓ THE N.W. QTR. & S.W. QTR. OF SEC. 16  
WP. 12, RA. 12 OF THE CONGRESS LANDS  
AST OF THE SCIOTO RIVER  
344E ROCK TWP. MUSKINGUM CO., OHIO



=HARD MAX GRAVES  
 3ISTERED SURVEYOR  
 25 KENLO WOODS DR  
 SHPORT, MO 64522  
 YZ8, 2000

RODNEY G. DRIGGS  
VOL. 1130, Pg. 136 56.462 AC.

DESCRIPTION APPROVED  
FOR AUDITOR'S TRANSFER

BY ASL  
6-21-2002

HALF SEC. 0 LINE

16