



Paul & David Abele
OR 1761-208
+/- 0.652 Ac.

Being a part of the Southwest Quarter of Sec. 14, Township 12, Range 12, Blue Rock Township, Muskingum County, also being part of the lands now owned by Paul & David Abele, OR 1761-208, Parcel Number 06-60-14-05-000 more fully described as follows.

Beginning for reference at a concrete monument found at the northeast corner of the southwest quarter of Section 14, also being in the northwest corner of the lands now owned by Paul & David Abele (OR 1761-208, Parcel No.: 06-60-14-08-000), thence with the west line of said Abele's lands, South 02 degrees 16 minutes 35 seconds West, 438.60 feet to an iron pin found;

thence continuing with said west line of Abele's lands, south 02 degrees 26 minutes 05 seconds West, 537.27 feet to an iron pin found and the principal place of beginning;

thence with the common line of Paul & David Abele's parcels 06-60-14-08-000 and 06-60-14-05-000, South 02 degrees 10 minutes 04 seconds West, 112.26 feet to a point in the center of a stream, passing an iron pin set at 98.05 feet;

thence leaving said common line and going through said parcel no.: 06-60-14-05-000 with the center of said stream the following 6 courses:

1. North 72 degrees 00 minutes 50 seconds West, 36.54 feet to a point;
2. North 83 degrees 06 minutes 41 seconds West, 52.71 feet to a point
3. North 82 degrees 11 minutes 28 seconds West, 46.57 feet to a point;
4. South 79 degrees 48 minutes 01 seconds West, 76.52 feet to a point;
5. South 71 degrees 23 minutes 39 seconds West, 49.02 feet to a point;
6. South 40 degrees 21 minutes 14 seconds West, 74.43 feet to a railroad spike set in the cent of Cutler Lake Road (CR-45);
7. thence with the center of said Cutler Lake Road, North 16 degrees 50 minutes 35 seconds West, 131.42 feet to a point on the southwest corner of the lands now owned by Paul R. & Sue A. Abele (DR 1129-282);

thence leaving said center of Cutler Lake Road and with the south line of said Paul and Sue Abele's lands North 82 degrees 01 minutes 43 seconds East, 348.89 feet to the point of beginning, passing an iron pin found at 17.41 feet, containing 0.652 acres more or less, subject to all legal highways and easements of record.

Not to be used as a separate building site or transferred as an independent parcel in the future without a planning commission approval in accordance with applicable subdivision regulations. Parcel to be transferred to Auditor's Parcel No.: 06-60-14-11-000.

All bearings described herein are based on the Ohio State Plane Ground Coordinates, NAD83, Ohio South per GPS Observation.

All iron pins set are 5/8 inch by 30 inch steel rebar with plastic identification caps marked MCPEEK PS8517.

The above described 0.652 acre parcel is based on a field survey made by McPeek Land Surveying on March 13th , 2013.

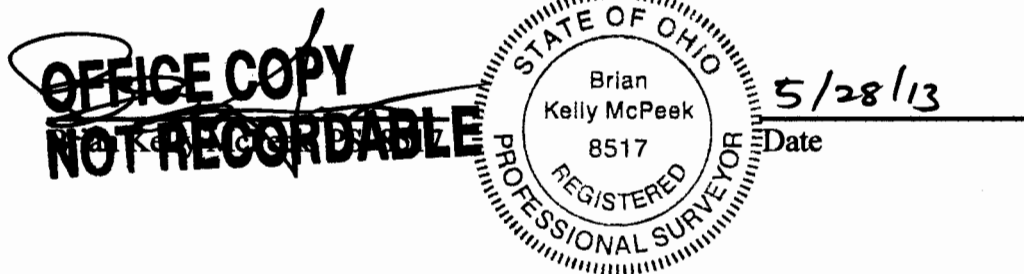

Parcel No.

Part of: 06-60-14-05-000 (+/- 0.652 ac.) to be transferred to
Auditor's Parcel No.: 06-60-14-11-000

DESCRIPTION

APPROVED

By: [Signature] 5/28/13

APPROVED
MUSKINGUM COUNTY
PLANNING COMMISSION DIRECTOR

[Signature]

5/28/13
Date

Fee Paid



SITUATED IN

The State of Ohio, County of Muskingum
Township of Blue Rock, and being a part
of the SW Qtr. of Sec. 14, T12, R12.

BASIS OF BEARING

Bearings are based on State Plane Ground Coordinates,
NAD83, Ohio South, per GPS Observation.

REFERENCES

* As Noted on Plat
www.muskingumcountyauditor.org
www.mceo.org
<http://recorder.muskingumcounty.org>

APPROVED
MUSKINGUM COUNTY
PLANNING COMMISSION DIRECTOR

5/28/13

Date

Fee Paid

LEGEND

- Iron Pin Set, 5/8" rebar (MCPEEK 8517)
- Iron Pin Found
- Concrete Monument
- Z— Property Hook

Approved for Transfer
No On-Lot Sewage
Zanesville-Muskingum Co.
Health Department

5/28/13
Date

Paul R. & Sue A. Abele
OR 1129-282
06-60-14-11-000

POB

Paul & David Abele
OR 1761-208
06-60-14-08-000

Paul & David Abele
OR 1761-208
06-60-14-05-000

±0.652 Ac.

Paul & David Abele
OR 1761-208
06-60-14-05-000

DESCRIPTION
APPROVED
By: *[Signature]*



ADJOINER STATEMENT

Not to be used as a separate building
site or transferred as an independent
parcel in the future without planning
commission approval in accordance with
applicable subdivision regulations.

PARCEL NO.

Part of: 06-60-14-05-000(±0.652ac.)
to be transferred to 06-60-14-11-000

GRAPHIC SCALE

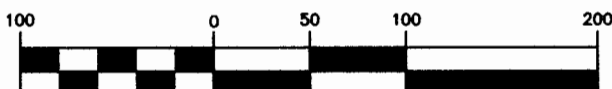

(IN FEET)

1 inch = 100 ft.

OFFICE COPY

NOT RECORDABLE

Reg. Surveyor No. 8517

MCPEEK
LAND
SURVEYING

mcpeeklandsurveying.com

423 Smithfield Ave., Zanesville, Ohio 43701

740.704.6073