

DESCRIPTION OF SURVEY FOR ERNIE HILL

JOB#2118-1

Situated in the State of Ohio, County of Muskingum, Township of Blue Rock:

Being part of Fractional Section 32, Township 12, Range 12, of the Congress lands East of the Scioto River, further **being all of** the Ernie Hill property recorded in **Official Record Volume 2111, Page 362** of said county's deed records, further **being all of** Muskingum County Auditor's **Parcel Number 06-70-32-31-000**, and more particularly described as follows;

Commencing at an iron pin (found) at 22 feet Left of Centerline Station 533+03.90 for State Route 60 (South River Road);

TIE-1 THENCE North 73 degrees 57 minutes 14 seconds East 24.02 feet along a line of the Lori A Role and Chad A Leach Trustees property recorded in Official Record Volume 2323, Page 82 and for the Danielle Lynn Hargraves and Jason M James property recorded in Official Record Volume 2358, Page 420 to an unmarked point in the centerline of said road;

TIE-2 THENCE South 39 degrees 41 minutes 49 seconds East 307.85 feet along said centerline to the unmarked place of beginning for the property herein intended to be described, further being a common corner for said Hill property and for the Douglas A Elekes and Judith A Elekes property recorded in Official Record Volume 2246, Page 86;

#1- THENCE South 39 degrees 41 minutes 49 seconds East 95.00 feet continuing along said centerline to an unmarked common corner for said Hill property and for the Martha A Poole property recorded in Deed Book Volume 575, Page 707;

#2- THENCE South 51 degrees 16 minutes 12 seconds West 90.00 feet leaving said road and along the common line for said Hill and Poole properties to the low water mark of the Muskingum River, passing iron pins (found) at 21.08 feet and 72.20 feet;

#3- THENCE North 39 degrees 41 minutes 31 seconds West 95.42 feet along said low water mark to a common corner for said Hill and Elekes properties;

#4- THENCE North 51 degrees 32 minutes 03 seconds East 90.00 feet leaving said river and along said Hill and Elekes properties to the place of beginning, passing iron pins (found) at 21.80 feet, and 68.16 feet **containing 0.20 acres**, of which 0.09 acres are within the right of way of State Route 60 (South River Road).

The bearings within this description are based on State Plane Coordinate Grid (Ohio South 1983) derived from GPS Observations. Iron pins (set) are 5/8" rebar with identification caps (C.R.Harkness P.L.S.6885).

This description was written by Charles R. Harkness Professional Land Surveyor #6885 from an actual survey completed on January 16, 2014 in accordance with Chapter 4733-37 of the Administrative Code, and is intended to be used for the legal transfer of the property described and does not intend to describe any apparent easements nor easements of record, unless otherwise indicated.

OFFICE COPY
NOT RECORDABLE

DESCRIPTION

APPROVED

By:

Charles R. Harkness
1/16/2014



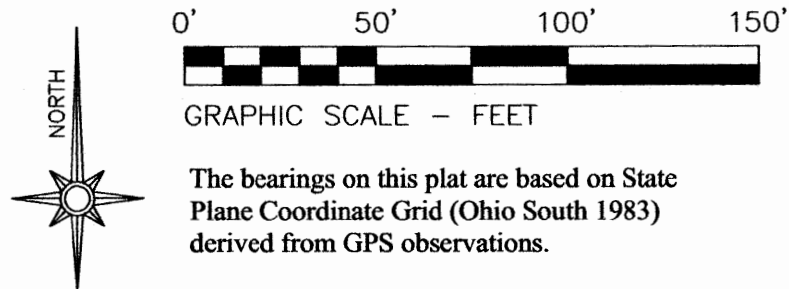

LEGEND

- PIN (SET) 5/8" REBAR CAPPED (C R HARKNESS PLS #6885)
- PIN (FOUND)
- △ POINT (UNMARKED)
- PIPE (FOUND)
- NU PIN (FOUND) NOT USED

Situated in the State of Ohio, County of Muskingum, Township of Blue Rock:

SURVEY 1

Being part of Fractional Section 32, Township 12, Range 12, of the Congress Lands East of the Scioto River, further **being all of** the Ernie Hill property recorded in **Official Record Volume 2111, Page 362** of said county's deed records, further **being all of** Muskingum County Auditor's **Parcel Number 06-70-32-31-000**:

SURVEY 2

Being part of Fractional Section 32, Township 12, Range 12, of the Congress Lands East of the Scioto River, further **being all of** the Matha A Poole property recorded in **Deed Book Volume 575, Page 707**, of said county's deed records, further **being all of** Muskingum County Auditor's **Parcel Number 06-70-32-30-000**:

SURVEYOR'S NOTES AND REFERENCES:

Muskingum County Tax Maps and Orthophotos of the area.

Right of way plans for State Route 60. Prior survey by Charles R Harkness PLS #6885 of the Richard Hunt property (Job #564 dated 2/10/1994).

Note #1- Commencing Point as referenced in deeds and surveys in the area.

Note #2- Low water mark (LWM) taken from County GIS Data. Water levels were high the date of survey. Other Low water marks were previously established by survey or deed.

This plat was prepared by C.R. Harkness Surveying & Mapping Inc. in accordance with Chapter 4733-37 of the Administrative Code, and is intended to be used for the legal transfer of the parcel surveyed and does not show any apparent easements nor easements of record, unless otherwise indicated.

Charles R. Harkness
Charles R. Harkness PLS #6885

SURVEY FOR:

Ernie Hill



HARKNESS SURVEYING & MAPPING, INC.
8205 OLD TOWN ROAD
ROSEVILLE, OHIO 43777
PHONE/FAX (740) 849-0122



SURVEYED:01/16/14 DRAWN:01/17/14

JOB NUMBER
Job#2118

DRAWING / SHEET #
Plat #01

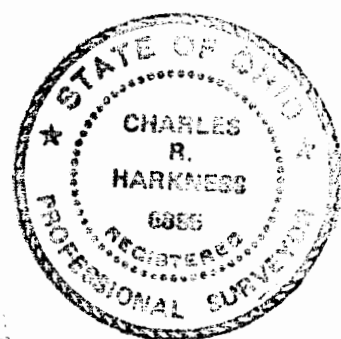

Gerald R Croston
DB Vol. 955,
Page 128.

Danielle Lynn Hargraves
& Jason M James
OR Vol. 2358, Page 420.

Lori A Rolfe &
Chad A Leach Trustees
OR Vol. 2323, Page 82.

Brenda Rose
OR Vol. 2008, Page 467.

Thomas A Vogelmeier
& Cathy J Vogelmeier
OR Vol. 2027, Page 286.

SURVEY1
Ernie Hill
OR Vol. 2111, Page 362.
Parcel #06-70-32-31-000

SURVEY 2
Martha A Poole
DB Vol. 575, Page 707.
Parcel #06-70-32-30-000

0.21 Acres

0.20 Acres