

DESCRIPTION

APPROVED

By: 

9/09/21

1. (L19) North  $12^{\circ}22'53''$  East, a distance of 40.39 feet to a point;
2. Following a curve (C3) to the left, having a delta angle of  $021.3369^{\circ}$ , a radius 1011.74 feet, an arc length 376.77 feet, a chord bearing North  $01^{\circ}42'47''$  East, and a chord distance 374.60 feet, returning to the POINT OF BEGINNING of the PARCEL herein described.

The above described area is contained within Muskingum County Auditor's Parcel Number 08-20-17-82-000, and contains 0.766 acres (33,372 square feet) of land, with 0.652 acre (28,387 square feet) in Section 14, and 0.114 acre (4,984 square feet) in Section 17.

Capped Rebar Set in the above description are 5/8 inch x 30 inch long rebar set with plastic caps marked "UTI BOUNDARY MONUMENT".

The basis of bearing in this description is based on the Ohio State Plane Coordinates, South Zone, NAD83(2011), with distances expressed in US Survey Feet, Grid.

Centerline stationing is based on Ohio Department of Transportation District 5 MUS-555-5.86 (1939), with references to highway monuments found in plans for projects MUS- 555-6.43 (2008), and MUS-555-8.00 (2014).

Railroad stationing is based on Zanesville and Western Railway Company, Cannelville Branch – Main Line Valuation Sheet V-305, 15f.

The description was prepared in February 2021 by James E. Deitrick, P.S. No. 8664, and is based on a field survey performed by James E. Deitrick, P.S. No. 8664 in December, 2020 and January, 2021.

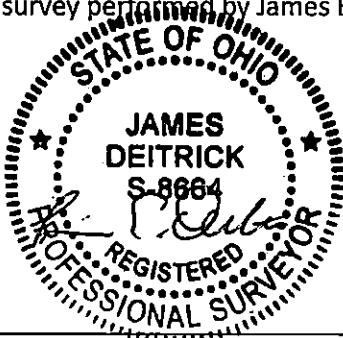

9/8/21

James E. Deitrick, Professional Surveyor #8664



9/10/21  
Date

Fee Paid