

SNR

### 35.00 Acre Split of Dan and Rebecca Terrible Property

Situated in the State of Ohio, County of Muskingum, Township of Brush Creek, and being part of the Northwest Quarter of Section 13, and the Northeast Quarter of Section 14, Township 11, Range 13, Congress Lands East of the Scioto River, and being part of the lands presently owned by Dan J. and Rebecca S. Terrible(OR 1507-566), and being more particularly described as follows:

Beginning for reference and the principal place of beginning, at an iron pin found at the southwest corner of the Northeast Quarter of Section 14;

Thence along south and east line of lands presently owned by G. K. and M. K. Campbell(OR 1140-564), the following two courses:

- 1.) North 46 degrees 06 minutes 57 seconds East, 1323.67 feet to an iron pin set;
- 2.) North 13 degrees 53 minutes 18 seconds West, 41.35 feet to an iron pin set;

Thence through said Terrible lands the following four courses:

- 1.) South 62 degrees 27 minutes 27 seconds East, 1041.72 feet to an iron pin set;
- 2.) South 77 degrees 11 minutes 41 seconds East, 1123.60 feet to an iron pin set, passing the section line at 661.99 feet;
- 3.) North 89 degrees 23 minutes 36 seconds East, 717.06 feet to an iron pin set;
- 4.) South 46 degrees 53 minutes 27 seconds East, 219.51 feet to an iron pin found on the north line of lands presently owned by J. A. and A. J. Krouskoupf(OR 2025-245);

Thence along the north line of said Krouskoupf lands, South 88 degrees 16 minutes 50 West, 1321.37 feet to a point on the northeast corner of lands presently owned by J. C. Matesich Jr. Trustee(DR 1104-564), and said point being in the water of an old strip mine pit, from which an iron pin set bears North 01 degrees 20 minutes 02 seconds West, 10.57 feet;

Thence along the north line of said Matesich lands, South 88 degrees 58 minutes 44 seconds West, 2520.31 feet to the principal place of beginning, containing 35.00 acres more or less, 5.27 acres in section 13, and 29.73 acres in section 14.

Subject to all legal right of ways and easements written or implied.

Iron pins set are 5/8" rebars 30" long, with plastic I. D. Caps.

Bearings are based on the south line of the Northeast Quarter of Section 14, as per previous survey performed by S. Walton, and being South 88 degrees 58 minutes 44 seconds West.

**OFFICE COPY  
NOT RECORDABLE**  
Jack D. Newcome  
Reg. Surveyor No. 7321

8-30-06  
Date

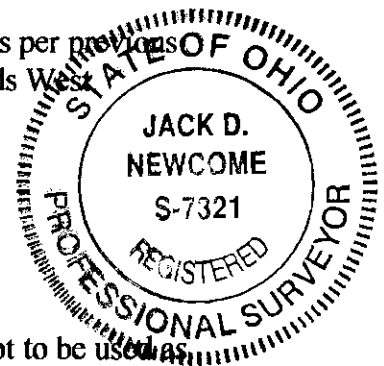

(Note: This surveyed tract to be conveyed to adjoining property owner, and not to be used as a separate building site, nor transferred as an independent parcel in the future without Planning Commission approval.

Parcel No.s Part of: 08-08-20-13-11-000(+5.27 Acres)  
Part of: 08-08-20-14-01-000(+ 29.73 Acres)

APPROVED FOR CLOSURE

EXEMPT FROM  
PLANNING COMMISSION

*A-L Swinburn*  
8-30-2006

*A-L Swinburn*  
8-30-2006

**OFFICE COPY  
NOT RECORDABLE**

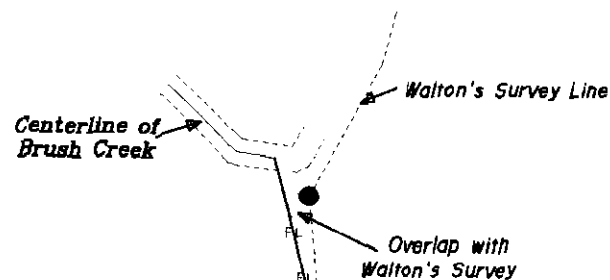

△	Railroad Spike Set
●	Iron Pin Found
田	Stone Found
○	Axle Found
○	Iron Pipe Found
▲	Railroad Spike Found
◎	Iron Pin Set, 5/8" rebar
⊗	Monument Found

State of Ohio, County of Muskingum, Township of Brush Creek, and being part of the Northwest Quarter of Section 13, and the Northeast Quarter of Section 14, Township 11, Range 13, Congress Lands East of the Scioto River.

Bearings are based on the south line of the Northeast Quarter of Section 14, as per previous survey performed by S. Walton, and being South 88 degrees 58 minutes 44 seconds West.

G. K. and M. K.  
Campbell  
OR 1140-584

J. E. Holsky  
DR 1041-295

D. J. and R. S.  
Terrible  
OR 1507-588

D. J. and R. S.  
Terrible  
OR 1507-588

**Dan J. and  
Rebecca S.  
Terrible  
OR 1507-566  
+- 35.00 Acres**

S 46°53'27"E  
219.51'

N 89°23'36"E  
717.06'

J. A. and A. J.  
Krouskoupf  
OR 2025-245

J. A. and A. J.  
Krouskoupf  
OR 2025-245

J. C. Matesich Jr. Trustee  
DR 1104-564

**Iron pin found at the Southwest Corner  
of the Northeast Quarter of Section 14,  
Township 11, Range 13, Congress Lands  
East of the Scioto River.**

**EXEMPT FROM  
PLANNING COMMISSION**

APPROVED FOR CLOSURE

A. L. Seemant A. L. Seemant  
8-30-2006 11 8-30-2006 11

8-30-2006 17  
OFFICE COPY  
NOT RECORDED  
30-06  
D. Newcome

Reg. Surveyor No. 7321

**PARCEL NO.S**

Part of: 08-08-20-13-11-000 +- 5.27 Ac.  
Part of: 08-08-20-14-01-000 +- 29.73 Ac.

**(Note: This surveyed tract to be conveyed to adjoining property owner and not to be used as a separate building site, nor transferred as an independent parcel in the future without Planning Commission approval.)**

## REFERENCES

OR 1507-586  
DR 1140-584  
OR 1538-203  
DR 1041-295  
Tax Map 80-20

**Newcome Surveying Company**  
**6515 Ballard Road**  
**Nashport, Ohio**  
**740-452-5796**

