

DESCRIPTION OF SURVEY FOR WILSON/DEITRICK/DALTON JOB# 1255-5

Situated in the State of Ohio, County of Muskingum, Township of Brush Creek,

Being part of Southwest Quarter of Section #17, and part of the Northwest Quarter of Section #24, Township #11, Range #13, of the Congress Lands East of the Scioto River, **being part of** the Kay Wilson, Robert Deitrick, an Anna Dalton property recorded in Deed Book Volume 1056, Page 437 of said county's deed records, further being **part of** Muskingum County Auditor's Parcel Number 08-40-24-19-000, and all of Parcel #08-20-17-33-000 more particularly described as follows;

- Beginning at a stone (found) marked at the common corner for Sections #16, #17, #24, & #25 of said Township and Range;
- #1- **THENCE North 02 degrees 50 minutes 55 seconds East 663.63 feet** along the common line for Sections #16 & #17 to a stone (found marked) at the common corner for the D Toole property recorded in Deed Book Volume 539, Page 771 and for the T & B Taylor property recorded in Deed Book Volume 1101, Page 27, both located in said Section #16;
 - #2- **THENCE North 02 degrees 42 minutes 55 seconds East 616.49 feet** continuing along the common line for Sections #16 & #17 to an iron pin (set) at the Southwest corner of the V Thompson and L Kinner property recorded in Deed Book Volume 1158, Page 933, passing an iron pin (found disturbed by tree growth) at 592.72 feet being the common corner of said T & B Taylor property and for the L & L Taylor property recorded in Deed Book Volume 1097, Page 481;
 - #3- **THENCE South 87 degrees 17 minutes 05 seconds East 412.50 feet** into Section #17, and along the South line of said Thomas/Kinner property to unmarked point in a small tributary to Brush Run, passing an iron pin (set) at 340.07 feet;
 - #4- **THENCE North 02 degrees 42 minutes 55 seconds East 148.50 feet** along the East line of said Thomas/Kinner property to an unmarked point in the center line of Restless Road (County Road #74), (old location formerly known as Jeffery Mills to Stovertown Road), passing iron pins (set) at 30.79 feet and 106.10 feet;
 - #5- **THENCE South 58 degrees 07 minutes 00 seconds East 493.25 feet** along said road and common line for said Wilson/Deitrick/Dalton property and for the A Willey property recorded in Deed Book Volume 696, Page 4, and the L & R Morrison property recorded in Official Record Volume 1538, Page 956, to the unmarked common corner for said Morrison property and for the Equicredit Corp property recorded in Official Record Volume 1653, Page 228, from which an iron pin (found) at a common corner for said Morrison and Equicredit properties bears for reference North 30 degrees 47 minutes 15 seconds East 21.60 feet, also transiting from the old location to the existing roadbed at approximately 200 feet;
 - #6- **THENCE along a curve to the left having, a chord bearing South 61 degrees 17 minutes 25 seconds East 337.46 feet**, a radius of 2234.77 feet, and arc length of 337.79 feet, continuing along said road and common line for said Wilson/Deitrick/Dalton and Equicredit properties to the unmarked Northwest corner of the Andrea Rupe property recorded in Deed Book Volume 878, Page 239;
 - #7- **THENCE South 31 degrees 28 minutes 55 seconds West 276.84 feet** along a line of said Rupe property to an iron pin (found), passing an iron pin (found) at 13.13 feet;
 - #8- **THENCE South 44 degrees 39 minutes 00 seconds East 928.16 feet** along a line of said Rupe property to an iron pin (found);
 - #9- **THENCE South 01 degrees 55 minutes 30 seconds West 183.56 feet** along a line of said Rupe property to an iron pin (set) on the common line for Sections #17 & #24, passing an iron pin (found) at 180.03 feet;
 - #10- **THENCE South 86 degrees 47 minutes 35 seconds East 382.99 feet** along the common line for Sections #17 & #24 to an iron pin (set) on the West line of the R Kessler property recorded in Deed Book Volume 1085, Page 334, from which an iron pin (found) at the previously reported Northwest corner of said Kessler property bears for reference North 10 degrees 30 minutes 40 seconds West 4.94 feet;
 - #11- **THENCE South 10 degrees 30 minutes 40 seconds East 342.79 feet** along the West line of said Kessler property to an unmarked point in the center line of Baughman Run Road (County Road #32), passing an iron pin (set) at 307.79 feet;

- #12- THENCE along a curve to the right having, a chord bearing South 67 degrees 58 minutes 40 seconds West 192.80 feet**, a radius of 726.13 feet, and arc length of 193.37 feet, continuing along said road and common line for said Wilson/Deitrick/Dalton property and for the F & B Harper property, recorded in Deed Book Volume 1131, Page 723 to the unmarked Northwest corner of said Harper property, from which an iron pin (found) on the West line of said Harper property bears for reference South 23 degrees 50 minutes 05 seconds East 20.00 feet;
- #13- THENCE along a curve to the right having, a chord bearing South 78 degrees 58 minutes 30 seconds West 85.34 feet**, a radius of 726.13 feet, and arc length of 85.39 feet, continuing along said road and through said Wilson/Deitrick/Dalton property to an unmarked point;
- #14- THENCE along a curve to the right having, a chord bearing South 86 degrees 15 minutes 00 seconds West 231.60 feet**, a radius of 1700.00 feet, and arc length of 231.78 feet, continuing along said road and through said Wilson/Deitrick/Dalton property to an unmarked point, from which an iron pin (set) for reference bears South 78 degrees 02 minutes 50 seconds East 63.64 feet;
- #15- THENCE along a curve to the right having, a chord bearing North 72 degrees 52 minutes 35 seconds West 210.21 feet**, a radius of 360.00 feet, and arc length of 213.32 feet, continuing along said road and through said Wilson/Deitrick/Dalton property to an unmarked point;
- #16- THENCE North 55 degrees 54 minutes 05 seconds West 91.34 feet** continuing along said road and through said Wilson/Deitrick/Dalton property to an unmarked point,
- #17- THENCE along a curve to the left having a chord bearing North 75 degrees 22 minutes 15 seconds West 203.32 feet**, a radius of 305.00 feet, and arc length of 207.28 feet, continuing along said road and through said Wilson/Deitrick/Dalton property to an unmarked point, from which an iron pin (set) for reference bears North 38 degrees 02 minutes 25 seconds East 26.35 feet;
- #18- THENCE South 85 degrees 09 minutes 35 seconds West 463.99 feet** continuing along said road and through said Wilson/Deitrick/Dalton property to an unmarked point,
- #19- THENCE along a curve to the left having, a chord bearing South 82 degrees 53 minutes 30 seconds West 461.25 feet**, a radius of 5829.57 feet, and arc length of 461.37 feet, continuing along said road and through said Wilson/Deitrick/Dalton property to an unmarked point, from which an iron pin (set) for reference bears South 77 degrees 38 minutes 40 seconds West 131.70 feet;
- #20- THENCE along a curve to the right having a chord bearing South 88 degrees 00 minutes 10 seconds West 287.64 feet**, a radius of 1120.00 feet and arc length of 288.44 feet, into Section #24, along said road, and through said Wilson/Deitrick/Dalton property to an unmarked point on the common line for said Sections #24 & #25;
- #21- THENCE North 03 degrees 38 minutes 55 seconds East 500.13 feet** along the common line for said Sections #24 & #25 to the place of beginning, passing an iron pin (found) at 30.19 feet, containing 37.85 acres in Section #17 and 20.23 acres in Section #24 for a **total of 58.08 acres**.

The bearings within this description are based on State Plane Coordinate Grid derived from GPS Observations. Iron pins (set) are 5/8" rebar with identification caps (C.R.Harkness P.L.S.6885).

This description was written by Charles R. Harkness Professional Land Surveyor #6885 from an actual survey completed on April 28, 2003, in accordance with Chapter 4733-37 of the Administrative Code, and is intended to be used for the legal transfer of the property described and does not intend to describe all or any easements of record, nor encroachments unless otherwise indicated.

**OFFICE COPY
NOT RECORDABLE**
Charles R. Harkness PLS #6885

DESCRIPTION APPROVED
FOR AUDITOR'S TRANSFER
BY CHS
5-19-2003

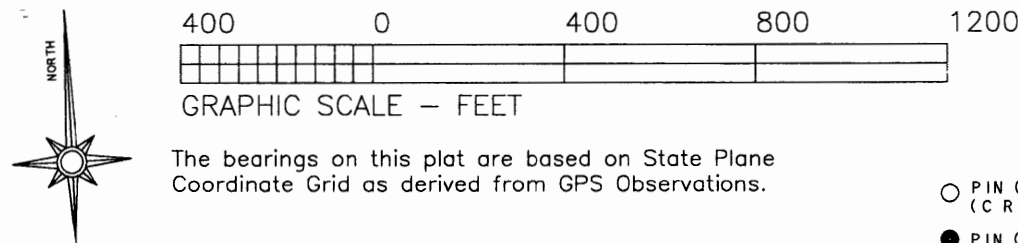

LEGEND

- PIN (SET) 5/8" REBAR CAPPED (C R HARKNESS PLS#6885)
- PIN (FOUND)
- POINT (UNMARKED)
- STONE (FOUND MARKED)
- PIPE (FOUND)
- RAILROAD SPIKE (FOUND DISTURBED)

COURSE BEARING DISTANCE

4 N 02°42'55"E 148.50'
PASSING PIN SET AT 30.79'
PASSING PIN SET AT 106.10'
6CH S 61°17'25"E 337.46'
LT RAD=2234.77' ARC=337.79'
R1 N 30°47'15"E 21.60'
R2 N 10°30'40"W 4.94'
12CH S 67°58'40"W 192.80'
RT RAD=726.13' ARC=193.37'
R3 S 23°50'05"E 20.00'
13CH S 78°58'30"W 85.34'
RT RAD=726.13' ARC=85.39'
14CH S 86°15'00"W 231.60'
RT RAD=1700.00' ARC=231.78'
R4 S 78°02'50"E 63.64'
15CH N 72°52'35"W 210.21'
RT RAD=360.00' ARC=213.32'
16 N 55°54'05"W 91.34'
17CH N 75°22'15"W 203.32'
LT RAD=305.00' ARC=207.28'
R5 N 38°02'25"E 26.35'
19CH S 82°53'30"W 461.25'
LT RAD=5829.57' ARC=461.37'
R6 S 77°38'40"W 131.70'
20CH S 88°00'10"W 287.64'
RT RAD=1120.00' ARC=288.44'
A N 53°57'40"E 181.94'
B S 23°50'05"E 156.00'
PASSING PIN (FOUND) AT 20.00'
C N 44°22'50"E 171.67'

Situated in the State of Ohio, County of Muskingum, Township of Brush Creek:

Being part of Southwest Quarter of Section #17, and part of the Northwest Quarter of Section #24, Township #11, Range #13, of the Congress Lands East of the Scioto River, being part of the Kay Wilson, Robert Deitrick, an Anna Dalton property recorded in Deed Book Volume 1056, Page 437 of said county's deed records, further being all of Muskingum County Auditor's Parcel Number 08-20-17-33-000 and part of Parcel Number 08-40-24-19-000;

SURVEYOR'S NOTES & REFERENCES:

Muskingum Co. Tax Maps and Orthophotos of the area. 3-D TopoQuads by DeLorme (Ohio).
Plat of John Baughman's Lots PB 1, Page 323. Re-Plat Book 1, Page 278.
Deed References (Type Vol - Page), (DB 46-417), (DB 46-442), (DB 514-950).
Muskingum County Common Pleas Court Case Record 116, Page 81 State of Ohio Verses Alfred L Mautz et al. Valuation Map for the Zanesville & Western Railroad (AKA New York Central Railroad). Survey completed by L Peter Dinan PLS #5451 dated 2/28/2001 of a 5.26 acre parcel from the C Goss property. Survey completed by Charles R Harkness PLS #6885 dated 8/31/1985 of the V Archer property location in the SE & SW Qtrs of Sec #17. Survey completed by Richard Max Graves PLS #5792 dated 6/21/1991 of the R & A Taylor property located in Section #16.
REF #1- V Thomas & L Kinner DB Vol. 1158, Page 933.
REF #2- R Kessler DB Vol. 1085, Page 334.
REF #3- F & B Harper DB Vol. 1131, Page 723. Including Lot #5 of John Baughman's Lots
REF #4- Lot #2 of John Baughman's Lots, owned by Donald Pletcher DB Vol. 1034, Page 311
REF #5- Lot #1 of John Baughman's Lots, owned by owned by D & L Ruble DB Vol. 1161, Page 869. Previous survey completed by Donald Graham PLS #7952 dated 11/23/1999 was not in agreement with the established Qtr Sec Line, nor with other field or platted information pertaining to John Baughman's Lots.
Note #1- Location of Bush Run and tributary are for graphical information only.

DESCRIPTION APPROVED
FOR AUDITOR'S TRANSFER
BY

5-14-2003

This plat was prepared by C. R. Harkness Surveying & Mapping Inc. in accordance with Chapter 4733-37 of the Administrative Code, and is intended to be used for the legal transfer of the property described and does not intend to describe all or any easements or record any encroachments unless otherwise indicated.

Charles R. Harkness PLS #6885

SURVEY FOR:
WILSON/DEITRICK/DALTON

SURVEY DATE: 4/28/2003 DRAWN DATE: 5/10/2003

SEC: #17 & #24 TWP: #11 R: #13 TWP: Brush Creek CO: Muskingum

CHARLES R. HARKNESS
SURVEYING & MAPPING, INC.
768 DRYDEN ROAD
ZANESVILLE, OHIO 43701
PHONE (740) 454-6367

JOB NUMBER DRAWING / SHEET NUMBER
JOB #1255 Plat #05

