

DESCRIPTION OF SURVEY FOR FREDERICK S WEAVER JR JOB#1875-1

Situated in the State of Ohio, County of Muskingum, Township of Brush Creek:

Being part of the Northwest Quarter, of Section 24, of Township 11, Range 13, of the Congress Lands East of the Scioto River, **being part of** the Frederick S Weaver Jr and Patricia J Weaver property recorded in Deed Book Volume 944, Page 241, of said county's deed records, further being part of Muskingum County **Auditor's Parcel Number 08-40-24-32-000**, and more particularly described as follows;

Commencing at the unmarked Center of Section 24;

- TIE-1 THENCE North 86 degrees 28 minutes 05 seconds West 187.29 feet** along the common line for the Southwest and Northwest Quarters of Section 24 to the unmarked place of beginning for the property herein intended to be described, also being a common corner for said Weaver property and for the Ronald L Welch and Erin E Welsh property recorded in Official Record Volume 1813, Page 700, further being on the West right of way for State Route 555 (Center Road);
- #1- THENCE North 86 degrees 28 minutes 05 seconds West 239.00 feet** continuing along said Quarter Section line to an iron pin (found) at a common corner for said Weaver property and for the Robert Lee Deitrick property recorded in Official Record Volume 1789, Page 110;
- #2- THENCE North 02 degrees 15 minutes 45 seconds East 379.11 feet** into said Northwest Quarter and along said Weaver and Deitrick properties to an iron pin (set);
- #3- THENCE South 88 degrees 47 minutes 30 seconds East 202.55 feet** crossing said Weaver property to an iron pin (set) on the common line for said Weaver and Welsh properties and West right of way of said road;
- #4- THENCE South 10 degrees 26 minutes 55 seconds East 192.29 feet** along said Weaver and Welsh properties and right of way to a concrete monument (found);
- #5- THENCE South 03 degrees 56 minutes 25 seconds West 200.65 feet** continuing along said properties and right of way to the place of beginning, passing a concrete monument (found) at 142.17 feet, **containing 2.05 acres.**

The bearings within this description are based on State Plane Coordinate Grid (Ohio South 1983) derived from GPS Observations. Iron pins (set) are 5/8" rebar with identification caps (C.R.Harkness P.L.S.6885).

This description was written by Charles R. Harkness Professional Land Surveyor #6885 from an actual survey completed on November 15, 2010 in accordance with Chapter 4733-37 of the Administrative Code, and is intended to be used for the legal transfer of the property described and does not intend to describe all or any easements of record, nor encroachments unless otherwise indicated.

OFFICE COPY
NOT RECORDABLE
Charles R. Harkness P.L.S. #6885



DESCRIPTION
APPROVED
By: *[Signature]* 12/7/2010

APPROVED
MUSKINGUM COUNTY
PLANNING COMMISSION DIRECTOR

12/15/10
Date

Fee Paid

**APPROVED
MUSKINGUM COUNTY
PLANNING COMMISSION DIRECTOR**

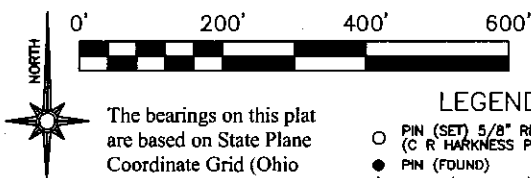

The bearings on this plat are based on State Plane Coordinate Grid (Ohio South 1983) derived from GPS observations.

- LEGEND**
- PIN (SET) 5/8" REBAR CAPPED (C R HARKNESS PLS#6885)
 - PIN (FOUND)
 - △ POINT (UNMARKED)
 - PIPE (FOUND)
 - ⊙ CONCRETE MONUMENT (FOUND)
 - X- FENCE OCCUPATION

Date 12/15/10

Fee Paid

Robert Lee Deltrick
OR Vol. 1789,
Page 110.

Situated in the State of Ohio, County of Muskingum, Township of Brush Creek:

Being part of the Northwest Quarter, Section 24, Township 11, Range 13, of the Congress Lands East of the Scioto River, being a division of the Fredrick S Weaver Jr. and Patricia J Weaver property recorded in Deed Book Volume 944, Page 241 of said county's deed records, further being a division of Muskingum County Auditor's Parcel Number 08-40-24-32-000:

SURVEYOR'S NOTES AND REFERENCES:

Muskingum County Tax Maps and Orthophotos of the area. Railroad Val Map V-305/15g of the Zanesville and Western Railway Company now The New York Central Railroad Company. Right of way plays for State Route 555 on file with ODOT District 5 Office.

Note #1- Each proposed split has a separate approved on lot septic system and water well.

CURVE	CHORD BEAR	LENGTH	RADIUS	ARC LEN
C1 RT	N 02°49'50" E	52.30'	2632.85'	52.30'
C2 RT	N 03°41'20" E	26.64'	2637.85'	26.64'
C3 RT	N 05°41'00" E	157.07'	2637.85'	157.10'
C4 RT	N 09°11'00" E	165.10'	2637.85'	165.13'
C5 RT	N 11°29'40" E	47.64'	2637.85'	47.64'
C6 RT	N 20°11'55" E	270.04'	948.04'	270.96'
C7 RT	N 36°34'30" E	270.04'	948.04'	270.96'
LINE	BEARING	DISTANCE		
A	S 26°28'00" E	37.76'		

Approved For Transfer
On-Lot Sewage O.K.

Date 12/15/10

Zanesville - Muskingum Co
Health Department

DESCRIPTION
APPROVED
BY: [Signature] 12/17/10

Robert Lee Deltrick
OR Vol. 1789,
Page 110.

Clarence A Goss Trustee
OR Vol. 1685, Page 559.

Stovertown St Johns
Evangelical Lutheran Church
OR Vol. 1578, Page 98.

Ronald L Welch
& Erin E Welch
OR Vol. 1813,
Page 700.

Kevin S McGee
& Beth A McGee
OR Vol. 1760, Page 178.

Crystal D Russell &
Timothy J Russell
OR Vol. 1814,
Page 602.

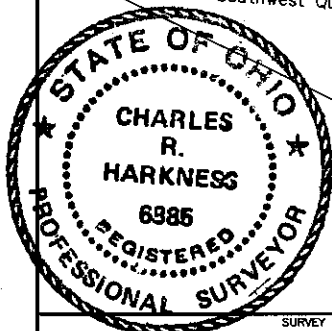

SURVEY FOR:
Frederick S Weaver Jr. & Patricia J Weaver

SECTION: 24 TOWNSHIP: 11 RANGE: 13 TOWNSHIP: Brush Creek
COUNTY: Muskingum STATE OF OHIO

Survey Date: 11/15/2010 Drawn Date: 11/17/2010

**C R HARKNESS SURVEYING
& MAPPING, INC.**
8205 OLD TOWN ROAD,
ROSEVILLE, OHIO 43777
PHONE/FAX (740) 849-0122

Job Number:
Job #1875

Drawing/Sheet No.
Plat #01

This plat was prepared by C.R. Harkness Surveying & Mapping, Inc. in accordance with Chapter 4733-37 of the Ohio Administrative Code, and is intended to be used for the legal transfer of land and to describe all or any easements, rights, or interests in land, unless otherwise indicated.

Charles R. Harkness PLS #6885

**OFFICE COPY
NOT RECORDABLE**