

# Baseline Surveying, Inc.

Land Surveying and Construction Layout

3010 East Pike  
Zanesville, OH 43701

Email: bei@rroho.com  
Telephone (740) 453-4850

**CONTAINING 3.734 ACRES. SUBJECT TO ALL APPLICABLE EASEMENTS.**

NOT TO BE USED AS A SEPARATE BUILDING SITE OR TRANSFERRED AS AN INDEPENDENT PARCEL IN THE FUTURE WITHOUT PLANNING COMMISSION APPROVAL IN ACCORDANCE WITH APPLICABLE SUBDIVISION REGULATIONS.

ALL IRON PINS SET ARE 5/8 INCH X 30 INCH REBAR WITH PLASTIC IDENTIFICATION CAPS (BASELINE PS6923-PS8536).

BEARINGS ARE BASED ON OHIO STATE PLANE COORDINATE SYSTEM 1983 (2011), OHIO SOUTH ZONE, GRID, DERIVED FROM A GPS OBSERVATION.

I, JASON LEACHMAN, PS 8536, HEREBY CERTIFY TO THE BEST OF MY KNOWLEDGE AND BELIEF THE SURVEY AND DESCRIPTION TO BE CORRECT AS PREPARED BY ME, THIS 18TH DAY OF DECEMBER 2020, FROM A FIELD SURVEY COMPLETED BY ME ON THE 18TH DAY OF DECEMBER 2020.

**OFFICE COPY  
NOT RECORDABLE**

JASON LEACHMAN  
PROFESSIONAL SURVEYOR 8536

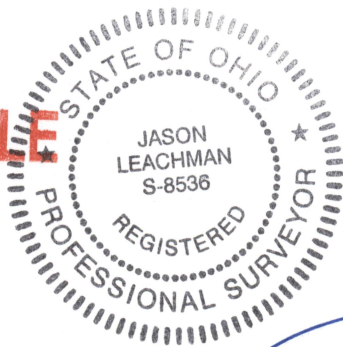

DESCRIPTION  
APPROVED

By: [Signature]

**APPROVED**  
MUSKINGUM COUNTY  
PLANNING COMMISSION DIRECTOR

Date: 12/18/21 Fee Paid: -