

Thence, with the westerly lines of Buckeye Community Thirty Seven LP (O.R. 2626 Pg. 260), the following (2) two courses:

- 1.) **South 5 degrees 59 minutes 02 seconds West, 74.36 feet** to a set 5/8" iron pin;
- 2.) **Thence, South 2 degrees 31 minutes 44 seconds West, 139.00 feet** to the **true point of beginning**.

Containing 10.701 Acres, of which, 9.066 acres are in Parcel No. 17-94-03-02-000, 1.635 acres are in Parcel No. 17-94-03-02-002 and being subject to all legal roads, easements and restrictions of record.

“Bearings are based on the Ohio State Plane Coordinate System, Ohio South Zone, NAD83 (CORS), as established using GPS Observations processed against the Ohio CORS network, with the center line of Kopchak Road as bearing North 31 degrees 12 minutes 22 seconds East, and are used to denote angles only.”

All iron pins set are 5/8" X 30" rebar with a 2" Aluminum ID cap stamped “Boeshart S-6512”.

I, Paul J. Boeshart, hereby certify that the above description represents a true and correct survey and all measurements were made under my direct supervision in accordance with Chapter 4733-37 of the Ohio Administration Code in April, 2021.

OFFICE COPY
NOT RECORDABLE
Paul J. Boeshart
Paul J. Boeshart, Professional Land Surveyor
Registration No. S-6512

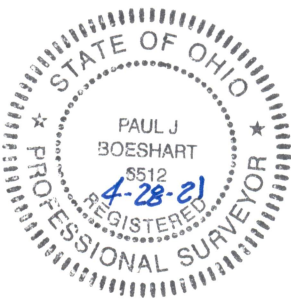

DESCRIPTION
APPROVED
By: *[Signature]*

APPROVED
MUSKINGUM COUNTY
PLANNING COMMISSION DIRECTOR
[Signature]
Date: 4/30/21 Fee Paid