

## DESCRIPTION OF 1.021 ACRES

Situated in the State of Ohio, County of Muskingum, City of Zanesville, and Township of Falls, Fourth Quarter, Township 1, Range 8, and being all of that 0.808 acres described in deed to St Thomas Catholic Church, of record in Deed Volume 309, Page 311, all being of record in the Recorder

**BEGINNING** at an iron pin set a the common corner of said 0.808 acres and that 1.637 acre described in deed to William M. Welch, Jr. of record in Deed Volume 2641, Page 571, also being in the south right of way line of State Route 40;

Thence South 63°29'34" East, a distance of 181.96 feet, with the north line of said 0.808 acres and the south right of way line of State Route 40, to an iron pin set;

Thence South 51°27'34" East, a distance of 36.19 feet, with the north line of said 0.808 acres and the south right of way line of State Route 40, to an iron pin set at a corner of that 58.57 acres described in deed the Mt Calvary Cemetery Association of Muskingum County, of record in Deed Volume 73, Page 342;

Thence with the line common to said 0.808 acres and said 58.57 acres the following courses:

South 38°32'28" West, a distance of 213.38 feet, to an iron pin set;

North 56°39'35" West, a distance of 215.78 feet, to an iron pin set at a common corner of said 1.637 acres and said 0.808 acres;

Thence North 38°45'26" East, a distance of 195.00 feet, with the line common to said 0.808 acres and said 1.637 acres, to the **POINT OF TRUE BEGINNING**, containing 1.021 acres, more or less, of which 0.505 acre of said 1.021 acres being all of Parcel 83-31-03-01-000 and 0.516 acre of said 1.021 acres being all of Parcel 17-99-04-04-000.

Subject to all easements, rights of way and restriction of record. All iron pins set are 5/8-inch rebar, 30 inches in length, with a yellow cap bearing name "CEC INC".

The above description was prepared from field measurements made under my direct supervision and in accordance with chapter 4733-37 of the Ohio Administrative Code.

The above bearings are based on the bearing of North 57°18'34" East, for the centerline of State Route 40 as established by a network of GPS observations performed in May 2018.



CIVIL & ENVIRONMENTAL CONSULTANTS, INC.

**OFFICE COPY**  
**NOT RECORDABLE** 6/28/2018  
Mark Alan Smith, P.S. \_\_\_\_\_ Date  
Registered Surveyor No. 8232

DESCRIPTION

APPROVED

By: 

POLK SCRAP IRON INC.  
D.V. 1789, PG.33  
1.43 ACRES

362.22'  
N 48°10'26" E

N 32°41'26" E  
75.00'

S 57°18'34" E 856.70'

DESCRIPTION

APPROVED

By: *Mark Alan Smith*

A=309.17'  
R=2864.79'  
Δ=6°11'00"  
CHB=S60°24'04"E  
CH=309.02'

S 37°30'15" W  
210.50'

STATE ROUTE 40  
(S.H. (I.C.H.) 1 SEC 1, PT)

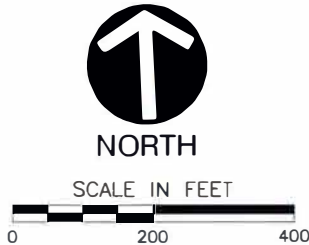

# PLAT OF SURVEY

STATE OF OHIO, COUNTY OF MUSKINGUM, CITY OF ZANESVILLE,  
TOWNSHIP OF FALLS AND SPRINGFIELD  
QTR 4, TWP 1, RANGE 8  
SECTION 2, TOWNSHIP 16, RANGE 14

## BASIS OF BEARINGS

THE BEARINGS SHOWN ON THIS SURVEY ARE BASED ON THE BEARING OF NORTH 57°18'34" EAST, FOR THE CENTERLINE OF STATE ROUTE 40, AS DETERMINED BY GPS OBSERVATIONS, OHIO STATE PLANE, SOUTH ZONE.

## IRON PINS

WHERE INDICATED HEREON, UNLESS OTHERWISE NOTED, ARE TO BE SET AND ARE 5/8" SOLID REBAR, THIRTY INCHES LONG WITH YELLOW PLASTIC CAP BEARING THE INITIALS "CEC INC".

## PERTINENT DOCUMENTS

DEEDS OF RECORD, MUSKINGUM COUNTY RECORDER'S OFFICE, RECORD SURVEYS & TAX MAPS, MUSKINGUM COUNTY MAP ROOM.

## LEGEND

- IRON PIN FOUND
- STONE FOUND
- IRON PIN SET
- ▲ NAIL FOUND
- △ NAIL SET



WE HEREBY CERTIFY THAT THE FOREGOING BOUNDARY SURVEY WAS PREPARED WITH ACTUAL FIELD MEASUREMENTS IN ACCORDANCE WITH CHAPTER 4733-37 OHIO ADMINISTRATIVE CODE.

**OFFICE COPY NOT RECORDABLE**

MARK ALAN SMITH  
PROFESSIONAL SURVEY NO.: S-8232

LINE TABLE		
LINE #	DIRECTION	LENGTH
L1	S 63°29'34" E	181.96'
L2	S 51°27'34" E	36.19'
L3	S 38°32'28" W	213.38'
L4	N 56°39'35" W	215.78'
L5	N 38°45'26" E	195.00'
L6	S 51°27'34" E	42.77'
L7	S 38°32'28" W	334.60'

59.573 ACRES (TOTAL)

THE MT CALVARY CEMETERY  
ASSOCIATION OF MUSKINGUM COUNTY  
D.V. 73, PG. 342  
58.57 ACRES (PER AUDITOR)  
PARCEL 17-99-04-03-000  
PARCEL 62-13-01-28-000  
PARCEL 83-31-03-45-000

FALLS TOWNSHIP - 4TH QTR, TOWNSHIP 1, RANGE 8  
SPRINGFIELD TOWNSHIP - SECTION 2, TOWNSHIP 16, RANGE 14  
PARCEL 17-99-04-03-000 - 43.136 ACRES (ALL)  
PARCEL 62-13-01-28-000 - 11.779 ACRES (ALL)

MT. CALVARY CEMETERY ASSOCIATION OF MUSKINGUM COUNTY  
D.V. 524, PG. 371  
LOT 5 AND 6  
PARCEL: 62-13-01-07-000 - 1.223 ACRES  
PARCEL: 62-13-01-08-000 - 1.223 ACRES

P.O.B.

ST THOMAS CATHOLIC CHURCH  
0.808 ACRES  
D.V.309, PG. 311  
P. ARCEL: 83-31-03-01-000 0.505 ACRES (ALL)  
PARCEL: 17-99-04-04-000 0.516 ACRES (ALL)

WILLIAM M. WELCH, JR.  
D.V. 2641, PG. 571  
1.637 ACRES

P.O.B.

1.021 ACRES

HOWARD L. FRYE  
ERIN C. FRYE  
D.V. 1587, PG. 652  
0.259 ACRES

JEAN M. NORRIS  
D.V. 1160, PG. 807  
0.31 ACRES

MEADOW LOT  
SUBDIVISION  
P.B.3, PG. 3

PRODUCERS SERVICE L.L.C.  
D.V. 1985, PG. 195  
SIXTH PARCEL - 2.25 ACRES

CITY OF ZANESVILLE  
PARCEL 83-31-03-45-000  
2.212 ACRES (ALL)

POLK SCRAP IRON INC.  
D.V. 1789, PG.33  
52 ACRES

N 01°44'14" E 1135.34'

N 87°45'37" W  
46.20'

FALLS TOWNSHIP - 4TH QTR, TOWNSHIP 1, RANGE 8  
SPRINGFIELD TOWNSHIP - SECTION 2, TOWNSHIP 16, RANGE 14

ZAAC REALTY, LTD  
D.V. 1886, PG. 312  
28.98 ACRES

N 01°32'26" E  
291.79'

N 88°27'34" W 399.55'

ZAAC REALTY, LTD  
D.V. 1886, PG. 312  
LOT 7

N 01°32'26" E  
292.38'

N 88°27'34" W

LOT 6  
1.223 AC  
BY SURVEY

LOT 5  
1.223 AC  
BY SURVEY

292.38'

S 01°32'26" W

CHARLES  
MCLOUGHLIN JR  
D.V. 2134, PG. 297  
LOT 4

CHARLES  
MCLOUGHLIN JR  
D.V. 2134, PG. 297  
LOT 3

L

CHARLES  
MCLOUGHLIN JR  
D.V. 2134, PG. 297  
LOT 2

1185.10'

N 88°27'34" W

364.32' PROSPECT STREET P.B.2, PG. 23



Civil & Environmental Consultants, Inc.

250 Old Wilson Bridge Road · Suite 250 · Worthington, OH 43085  
614-540-6633 · 888-598-6808  
www.cecinc.com

MT CALVARY CEMETERY  
MUSKINGUM COUNTY, OHIO

PLAT OF SURVEY

DRAWN BY: MAS | CHECKED BY: RWM | APPROVED BY: DRAFT | DRAWING NO.:  
DATE: JUNE 2018 | DWG SCALE: 1"=200' | PROJECT NO: 180-898

1 OF 1

P:\2018\180-898\Survey\Draw\180898SV-SRXY.dwg(LAYOUT) | LS (6/28/2018 - msmith) - LP: 6/28/2018 9:11 AM



P:\2018\180-898-Survey\Drawings\180898SY-SRVY.dwg(LAYOUT) LS:\6/28/2018 - msmith) - LP: 6/28/2018 9:11 AM

POLK SCRAP IRON INC.  
D.V. 1789, PG. 33  
52 ACRES

ZAAC REALTY, LTD  
D.V. 1886, PG. 312  
28.98 ACRES

POLK SCRAP IRON INC.  
D.V. 1789, PG. 33  
1.43 ACRES

DESCRIPTION  
APPROVED

By: *[Signature]*

LINE TABLE		
LINE #	DIRECTION	LENGTH
L1	S 63°29'34" E	181.96'
L2	S 51°27'34" E	36.19'
L3	S 38°32'28" W	213.38'
L4	N 56°39'35" W	215.78'
L5	N 38°45'26" E	195.00'
L6	S 51°27'34" E	42.77'
L7	S 38°32'28" W	334.60'

A=309.17'  
R=2864.79'  
Δ=6°11'00"  
CHB=S60°24'04"E  
CH=309.02'

59.573 ACRES (TOTAL)

THE MT CALVARY CEMETERY  
ASSOCIATION OF MUSKINGUM COUNTY  
D.V. 73, PG. 342  
58.57 ACRES (PER AUDITOR)  
PARCEL 17-99-04-03-000  
PARCEL 62-13-01-28-000  
PARCEL 83-31-03-45-000

MT. CALVARY CEMETERY ASSOCIATION OF MUSKINGUM COUNTY  
D.V. 524, PG. 371  
LOT 5 AND 6  
PARCEL: 62-13-01-07-000 - 1.223 ACRES  
PARCEL: 62-13-01-08-000 - 1.223 ACRES

P.O.B.

ZAAC REALTY, LTD  
D.V. 1886, PG. 312  
LOT 7

LOT 6  
1.223 AC  
BY SURVEY

LOT 5  
1.223 AC  
BY SURVEY

CHARLES  
MCLOUGHLIN JR  
D.V. 2134, PG. 297  
LOT 4

CHARLES  
MCLOUGHLIN JR  
D.V. 2134, PG. 297  
LOT 3

CHARLES  
MCLOUGHLIN JR  
D.V. 2134, PG. 297  
LOT 2

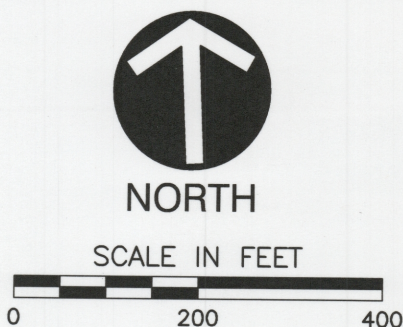

## PLAT OF SURVEY

STATE OF OHIO, COUNTY OF MUSKINGUM, CITY OF ZANESVILLE,  
TOWNSHIP OF FALLS AND SPRINGFIELD  
QTR 4, TWP 1, RANGE 8  
SECTION 2, TOWNSHIP 16, RANGE 14

### BASIS OF BEARINGS

THE BEARINGS SHOWN ON THIS SURVEY ARE BASED ON  
THE BEARING OF NORTH 57°18'34" EAST, FOR THE  
CENTERLINE OF STATE ROUTE 40, AS DETERMINED BY GPS  
OBSERVATIONS, OHIO STATE PLANE, SOUTH ZONE.

### IRON PINS

WHERE INDICATED HEREON, UNLESS OTHERWISE NOTED,  
ARE TO BE SET AND ARE 5/8" SOLID REBAR, THIRTY  
INCHES LONG WITH YELLOW PLASTIC CAP BEARING THE  
INITIALS "CEC INC".

### PERTINENT DOCUMENTS

DEEDS OF RECORD, MUSKINGUM COUNTY RECORDER'S  
OFFICE, RECORD SURVEYS & TAX MAPS, MUSKINGUM  
COUNTY MAP ROOM.

### LEGEND

- IRON PIN FOUND
- STONE FOUND
- IRON PIN SET
- ▲ MAG NAIL FOUND
- △ MAG NAIL SET

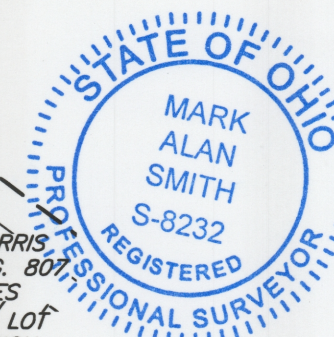

WE HEREBY CERTIFY THAT THE FOREGOING  
BOUNDARY SURVEY WAS PREPARED WITH  
ACTUAL FIELD MEASUREMENTS IN  
ACCORDANCE WITH CHAPTER 4733-37  
OHIO ADMINISTRATIVE CODE.

**OFFICE COPY  
NOT RECORDABLE**

MARK ALAN SMITH  
PROFESSIONAL SURVEY NO.: S-8232



Civil & Environmental Consultants, Inc.

250 Old Wilson Bridge Road · Suite 250 · Worthington, OH 43085

614-540-6633 · 888-598-6808

www.cecinc.com

MT CALVARY CEMETERY  
MUSKINGUM COUNTY, OHIO

PLAT OF SURVEY

DRAWN BY:	MAS	CHECKED BY:	RWM	APPROVED BY:	DRAFT	DRAWING NO.:
DATE:	JUNE 2018	DWG SCALE:	1"=200'	PROJECT NO:	180-898	1 OF 1