

Re-Survey of Jinx A. Thompson Lands in Hopewell Township, Muskingum County

Situated in the State of Ohio, County of Muskingum, Township of Hopewell, Quarter Township 1, and being a part of Lot 16, Lot 17, and Lot 25, Quarter Township 2, and being a part of the Southwest Quarter of Section 8, the Northwest Quarter of Section 13, and the Northeast Quarter of Section 14, Quarter Township 3, and being a part of Lot 7, Township 1, Range 9, United States Military Lands, and being all the lands presently owned by Jinx A. Thompson as per Deed Record 1150, Page 603,(1½ Interest), and Deed Record 1626, Page 775,(1½ Interest), and being more particularly described as follows:

Beginning for reference and the principal place of beginning at a stone found at the Southeast Corner of the Northwest Quarter of Section 13, Township 1, Range 9, United States Military Lands;

Thence along the south line of said northwest quarter and the north line of lands presently owned by Jennifer E. and Scott T. Bare Jr., (OR 2602-887), North 88 degrees 17 minutes 56 seconds West, 600.83 feet to an iron pin found;

Thence along the north lines of said Bare lands the following four courses:

- 1.) South 40 degrees 33 minutes 23 seconds West, 332.85 feet to an iron pin found;
- 2.) South 40 degrees 33 minutes 19 seconds West, 667.88 feet to a 15" diameter Oak tree, passing an iron pin found at 642.76 feet;
- 3.) South 74 degrees 07 minutes 03 seconds West, 429.29 feet to a 24" diameter Hickory tree, passing iron pins found at 15.12 feet and 415.52 feet ;
- 4.) North 88 degrees 02 minutes 27 seconds West, 1003.28 feet to a point on the east line of lands presently owned by Terry A Blackstone,(OR 1543-274), passing an iron pins found at 21.38 feet and 978.27 feet;

Thence along the east line of said Blackstone lands, North 03 degrees 18 minutes 17 seconds East, 905.66 feet to an iron pin set on the southeast corner of lands presently owned by Eric S. Hartman,(DR 1084-295);

Thence the lines of said Hartman lands the following two courses:

- 1.) North 07 degrees 11 minutes 10 seconds West, 585.76 feet to an iron pin set;
- 2.) North 77 degrees 55 minutes 12 seconds West, 404.67 feet to a pointed iron pin found on the southeast corner of lands presently Amy Bowman,(OR 2626-127);

Thence along the lines of said Bowman lands the following four courses:

- 1.) North 03 degrees 50 minutes 46 seconds East, 142.52 feet to an iron pin set;
- 2.) South 85 degrees 53 minutes 21 seconds West, 164.28 feet to an iron pin set;
- 3.) North 02 degrees 37 minutes 30 seconds East, 25.11 feet to a pipe found;
- 4.) South 87 degrees 32 minutes 57 seconds West, 91.70 feet to a point in the centerline of Macedonia Road,(Twp. Rd. 609), passing an iron pin set at 50.35 feet;

Thence along the centerline of said road the following four courses:

- 1.) North 03 degrees 22 minutes 59 seconds East, 407.04 feet to a point;
- 2.) North 02 degrees 22 minutes 54 seconds East, 162.68 feet to a point;
- 3.) North 02 degrees 31 minutes 41 seconds West, 68.92 feet to a point;
- 4.) North 08 degrees 52 minutes 01 seconds West, 61.24 feet to a point on the southwest corner of lands presently owned by John Richard Scott, (DR 969-55);

Thence along the lines of said Scott lands the following five courses:

- 1.) South 88 degrees 31 minutes 19 seconds East, 307.74 feet to an iron pin set, passing an iron pin set at 43.83 feet;
- 2.) South 02 degrees 45 minutes 30 seconds East, 160.00 feet to an iron pin set;
- 3.) South 88 degrees 09 minutes 18 seconds East, 3046.06 feet to an iron pin set;
- 4.) North 03 degrees 14 minutes 33 seconds East, 1329.13 feet to an iron pin set;
- 5.) North 88 degrees 12 minutes 20 seconds West, 696.06 feet to an iron pin found on the southeast corner of lands presently owned by Eloise Ruth Bishop, (OR 2567-121);

Thence along the lines of said Bishop lands the following three courses:

- 1.) North 03 degrees 38 minutes 09 seconds East, 729.66 feet to an iron pin set;
- 2.) North 07 degrees 25 minutes 11 seconds East, 471.59 feet to an iron pin set;
- 3.) South 87 degrees 08 minutes 42 seconds East, 674.27 feet to an iron pin found on the southwest corner of lands presently owned by Timothy Matthew Bishop, (OR 2557-812);

Thence along the south line of said Bishop lands, South 88 degrees 39 minutes 01 seconds East, 2470.95 feet to an iron pin found on the west line of lands presently owned by the United States of America, (DR 494-235);

Thence along the west lines of said U. S. A. lands the following fourteen courses:

- 1.) South 74 degrees 07 minutes 03 seconds West, 102.60 feet to an aluminum pin found;
- 2.) South 62 degrees 34 minutes 57 seconds East, 15.87 feet to an aluminum pin found;
- 3.) South 57 degrees 41 minutes 35 seconds East, 203.33 feet to an aluminum pin found;
- 4.) South 42 degrees 09 minutes 36 seconds East, (crossing Pleasant Valley Road, Co. Road 47) 237.48 feet to an aluminum pin found;
- 5.) South 29 degrees 31 minutes 09 seconds West, 119.34 feet to an aluminum pin found;
- 6.) South 31 degrees 59 minutes 22 seconds West, (crossing said Pleasant Valley Road), 312.86 feet to a concrete monument found;
- 7.) South 61 degrees 06 minutes 34 seconds West, 196.83 feet to an iron pin found;
- 8.) South 89 degrees 19 minutes 41 seconds East, 41.86 feet to a concrete monument found;
- 9.) South 60 degrees 42 minutes 50 seconds West, 36.82 feet to a concrete monument found;
- 10.) South 12 degrees 28 minutes 12 seconds West, 55.67 feet to a concrete monument found;
- 11.) South 86 degrees 30 minutes 05 seconds West, 14.26 feet to a concrete monument found;
- 12.) South 50 degrees 12 minutes 51 seconds West, 106.24 feet to an iron pin found;
- 13.) South 78 degrees 31 minutes 39 seconds West, 118.26 feet to an iron pin found;
- 14.) South 73 degrees 02 minutes 08 seconds East, 219.23 feet to a concrete monument found on the north line of lands presently owned by George V. Thompson, (OR 2620-879);

Thence along the lines of said Thompson lands the following three courses:

- 1.) South 85 degrees 03 minutes 53 seconds West, 228.09 feet to an iron pin found;
- 2.) South 38 degrees 56 minutes 10 seconds West, 276.65 feet to an iron pin found;
- 3.) South 54 degrees 13 minutes 06 seconds West, 297.00 feet to an iron pin found on the northeast corner of lands presently owned by Letterina and Richard T. Franz, Co-Trustees, (DR 1162-216);

Thence along the north line of said Franz lands, South 54 degrees 31 minutes 43 seconds West, 2271.61 feet to a point in a creek, on the northwest corner of said Franz lands, passing iron pins set at 37.50 feet, and 2237.95 feet;

Thence along the west line of said Franz lands, South 03 degrees 14 minutes 32 seconds West, 382.81 feet to a stone found on the northwest corner of lands presently owned by Ryan and Shelli Corl, (OR 2549-655);

Thence along the west line of said Corl lands, South 01 degrees 01 minutes 32 seconds West, 658.80 feet to the principal place of beginning, containing 252.40 acres , more or less, and being all of Auditors Parcel Numbers 25-30-03-02-000 +- 34.19 Acres, 25-30-14-18-000 +- 11.38 Acres,(0.24 Acres in R\W of Twp. Rd. 609) , 25-30-14-20-000 +- 1.10 Acres,(+- 0.07 Acres in R\W Twp. Rd. 609), 25-30-13-06-000 +-80.36 Acres, 25-30-13-03-000 +-38.02 Acres, 25-16-08-17-000 +-11.61 Acres, 25-16-08-15-000 +-7.41 Acres, 25-16-01-16-000 +- 66.19 Acres, and 25-20-01-23-000 +- 2.14 Acres, (+- 0.21 Acres in R\W of Co. Rd. 47);

Subject to all legal recorded easements and right of ways.

Iron pins set are 5/8 inch rebars , 30 inches long, with plastic identification caps.

Bearings are based on the Ohio State Plane Coordinate System, NAD 83, South Zone, Grid North, as per GPS observations.

This description is written based on a field survey completed January 31, 2018 by Jack D. Newcome, Reg. No. 7321.

**OFFICE COPY
NOT RECORDABLE**

Jack D. Newcome, Reg. No. 7321

Date

2-7-18

DESCRIPTION

APPROVED

By:

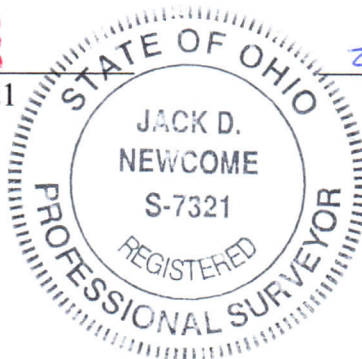

SITUATED IN:

State of Ohio, County of Muskingum, Township of Hopewell, Quarter Township 1, and being a part of Lot 16, Lot 17, and Lot 25, Quarter Township 2, and being part of the Southwest Quarter of Section 8, the Northwest Quarter of Section 13, and the Northeast Quarter of Section 14, Quarter Township 3, and being a part Lot 7, Township 1, Range 9, United States Military Lands.

LEGEND

- ▲ Railroad Spike Set
- Iron Pin Found
- ⊞ Stone Found
- Axle Found
- Iron Pipe Found
- ▲ Railroad Spike Found
- Iron Pin Set, 5/8" rebar
- ⊞ Monument Found

Centerline of
Macedonia Road
(Twp. Rd. 609)
R\W 40'
Assumed

John Richard Scott
DR 969-55
25-30-14-20-000

Amy Bowman
OR 2626-127

Eric S. Hartman
DR 1084-295

Terry A.
Blackstone
OR 1543-274

John Richard Scott
DR 969-55

Jinx A. Thompson
DR 1150-603(1\2 Int.)
DR 1626-775(1\2 Int.)
+ - 252.40 Acres

NW Qrt. Section 13,
Lot 7, Qrt. Twp. 3

25-30-03-02-000

Jennifer E. and
Scott T. Bare Jr.
OR 2602-887

Eloise Ruth Bishop
OR 2567-121

Timothy Matthew Bishop
OR 2557-812

25-16-01-16-000

Lot 16
Lot 25

25-30-13-03-000

Richard T. and
Letterina Franz
Co-Trustees
DR 1162-216

Ryan and Shelli Cori
OR 2549-655

**Southeast Corner of the
Northwest Quarter of
Section 13, T 1, Range 9,
U. S. M. L.**

Scott T. Bare Jr. et al
OR 2681-736

OFFICE COPY
RECORDED

Jack D. Newcome

Date

Reg. Surveyor No. 7321

DESCRIPTION

APPROVED

By: *[Signature]*

BASIS OF BEARINGS

Bearings are based on the Ohio
State Plane Coordinate System, NAD
83, South Zone, Grid North as per
GPS observations.

REFERENCES

DR 1150-603
DR 1626-775
OR 2602-887
OR 2627-127
OR 2549-655
OR 2620-879
DR 494-235
OR 2557-812
Dillon Topo Map,
Sheets 72, and 77

PARCEL NO.S

All of: 25-30-03-02-000 +- 34.19 Ac.
All of: 25-30-14-18-000 +- 11.36 Ac.
(+- 0.24 Acres in R\W Twp. Rd. 609)
All of: 25-30-14-20-000 +- 1.10 Ac.
(+- 0.07 Acres in R\W Twp. Rd. 609)
All of: 25-30-13-06-000 +- 80.36 Ac.
All of: 25-30-13-03-000 +- 38.02 Ac.
All of: 25-16-08-17-000 +- 11.61 Ac.
All of: 25-16-08-15-000 +- 7.41 Ac.
All of: 25-16-01-16-000 +- 66.19 Ac.
All of: 25-20-01-23-000 +- 2.14 Ac.
(+- 0.21 Acres in R\W of Co. Rd. 47)



Newcome Surveying Company
6515 Ballard Road
Nashport, Ohio
740-452-5796

COURSE BEARING DISTANCE

L-1	N 03°50'46"E	142.52'
L-2	S 85°53'21"W	164.28'
L-3	N 02°37'30"E	25.11'
L-4	S 87°32'57"W	50.35'
L-5	S 87°32'57"W	41.35'
L-6	N 03°22'59"E	407.04'
L-7	N 02°22'54"E	162.68'
L-8	N 02°31'41"W	68.92'
L-9	N 08°52'01"W	61.24'
L-10	S 88°31'19"E	43.83'
L-11	S 88°31'19"E	263.91'
L-12	S 02°45'30"E	160.00'

COURSE BEARING DISTANCE

L-13	S 74°07'03"W	102.60'
L-14	S 62°34'57"E	15.87'
L-15	S 57°41'35"E	203.33'
L-16	S 42°09'36"E	237.48'
L-17	S 29°31'09"W	119.34'
L-18	S 31°59'22"W	312.86'
L-19	S 61°06'34"W	196.83'
L-20	S 89°19'41"E	41.86'
L-21	S 60°42'50"W	36.82'
L-22	S 12°28'12"W	55.67'
L-23	S 86°30'05"W	14.26'
L-24	S 50°12'51"W	106.24'
L-25	S 78°31'39"W	118.26'
L-26	S 73°02'08"E	219.23'
L-27	S 85°03'53"W	228.09'
L-28	S 38°56'10"W	276.65'

0 350' 700' 1400'

Graphic Scale in Feet 1"=700'

25-30-03-02-000
25-30-14-18-000
25-30-14-20-000
25-30-18-06-000
25-30-13-03-000
25-16-08-17-000

25-16-08-15-000
25-16-01-16-000
25-20-01-23-000

Corrective Description of a Re-Survey of Jinx A. Thompson Lands in Hopewell Township

Situated in the State of Ohio, County of Muskingum, Township of Hopewell, Quarter Township 1, and being a part of Lot 16, Lot 17, and Lot 25, Quarter Township 2, and being a part of the Southwest Quarter of Section 8, the Northwest Quarter of Section 13, and the Northeast Quarter of Section 14, Quarter Township 3, and being a part of Lot 7, Township 1, Range 9, United States Military Lands, and being all the lands presently owned by Jinx A. Thompson as per Official Record 2773, Page 195, and previous Deed Record 1150, Page 603,(1/2 Interest), and previous Deed Record 1626, Page 775,(1/2 Interest), and being more particularly described as follows:

Beginning for reference and the principal place of beginning at a stone found at the Southeast Corner of the Northwest Quarter of Section 13, Township 1, Range 9, United States Military Lands;

Thence along the south line of said northwest quarter and the north line of lands presently owned by Jennifer E. and Scott T. Bare Jr., (OR 2602-887), North 88 degrees 17 minutes 56 seconds West, 600.83 feet to an iron pin found;

Thence along the north lines of said Bare lands the following four courses:

- 1.) South 40 degrees 33 minutes 23 seconds West, 332.85 feet to an iron pin found;
- 2.) South 40 degrees 33 minutes 19 seconds West, 667.88 feet to a 15" diameter Oak tree, passing an iron pin found at 642.76 feet;
- 3.) South 74 degrees 07 minutes 03 seconds West, 429.30 feet to a 24" diameter Hickory tree, passing iron pins found at 15.12 feet and 415.52 feet ;
- 4.) North 88 degrees 02 minutes 27 seconds West, 1003.27 feet to a point on the east line of lands presently owned by Terry A Blackstone,(OR 1543-274), passing an iron pins found at 21.38 feet and 978.27 feet;

Thence along the east line of said Blackstone lands, North 03 degrees 18 minutes 17 seconds East, 905.66 feet to an iron pin set on the southeast corner of lands presently owned by Eric S. Hartman,(DR 1084-295);

Thence the lines of said Hartman lands the following two courses:

- 1.) North 07 degrees 11 minutes 09 seconds West, 585.75 feet to an iron pin set;
- 2.) North 77 degrees 55 minutes 12 seconds West, 404.67 feet to a pointed iron pin found on the southeast corner of lands presently Amy Bowman,(OR 2626-127);

Thence along the lines of said Bowman lands the following four courses:

- 1.) North 03 degrees 50 minutes 46 seconds East, 142.52 feet to an iron pin set;
- 2.) South 85 degrees 53 minutes 21 seconds West, 164.28 feet to an iron pin set;
- 3.) North 02 degrees 37 minutes 30 seconds East, 25.11 feet to a pipe found;
- 4.) South 87 degrees 32 minutes 57 seconds West, 91.70 feet to a point in the centerline of Macedonia Road,(Twp. Rd. 609), passing an iron pin set at 50.35 feet;

Thence along the centerline of said road the following four courses:

- 1.) North 03 degrees 22 minutes 59 seconds East, 407.04 feet to a point;
- 2.) North 02 degrees 22 minutes 54 seconds East, 162.68 feet to a point;
- 3.) North 02 degrees 31 minutes 41 seconds West, 68.92 feet to a point;
- 4.) North 08 degrees 52 minutes 01 seconds West, 61.24 feet to a point on the southwest corner

25-30-03-02-000 A
25-30-14-18-000 A
25-30-14-20-000 A
25-30-13-06-000 A
25-30-13-03-000 A
25-16-08-17-000 A

25-16-08-15-000 A
25-16-01-16-000 A
25-20-01-23-000 A

of lands presently owned by John Richard Scott, (DR 969-55);

Thence along the lines of said Scott lands the following five courses:

- 1.) South 88 degrees 31 minutes 19 seconds East, 307.74 feet to an iron pin set, passing an iron pin set at 43.83 feet;
- 2.) South 02 degrees 45 minutes 30 seconds East, 160.00 feet to an iron pin set;
- 3.) South 88 degrees 09 minutes 18 seconds East, 3046.06 feet to an iron pin set;
- 4.) North 03 degrees 14 minutes 33 seconds East, 1329.13 feet to an iron pin set;
- 5.) North 88 degrees 12 minutes 20 seconds West, 696.06 feet to an iron pin found on the southeast corner of lands presently owned by Eloise Ruth Bishop, (OR 2567-121);

Thence along the lines of said Bishop lands the following three courses:

- 1.) North 03 degrees 38 minutes 09 seconds East, 729.66 feet to an iron pin set;
- 2.) North 07 degrees 25 minutes 11 seconds East, 471.59 feet to an iron pin set;
- 3.) South 87 degrees 08 minutes 42 seconds East, 674.27 feet to an iron pin found on the southwest corner of lands presently owned by Timothy Matthew Bishop, (OR 2557-812);

Thence along the south line of said Bishop lands, South 87 degrees 54 minutes 59 seconds East, 2373.15 feet to an iron pin found on the west line of lands presently owned by the United States of America, (DR 494-235);

Thence along the west lines of said U. S. A. lands the following thirteen courses:

- 1.) South 62 degrees 34 minutes 57 seconds East, 15.87 feet to an aluminum pin found;
- 2.) South 57 degrees 41 minutes 35 seconds East, 203.33 feet to an aluminum pin found;
- 3.) South 42 degrees 09 minutes 36 seconds East, (crossing Pleasant Valley Road, Co. Road 47) 237.48 feet to an aluminum pin found;
- 4.) South 29 degrees 31 minutes 09 seconds West, 119.34 feet to an aluminum pin found;
- 5.) South 31 degrees 59 minutes 22 seconds West, (crossing said Pleasant Valley Road), 312.86 feet to a concrete monument found;
- 6.) South 61 degrees 06 minutes 34 seconds West, 196.83 feet to an iron pin found;
- 7.) South 89 degrees 19 minutes 41 seconds East, 41.86 feet to a concrete monument found;
- 8.) South 60 degrees 42 minutes 50 seconds West, 36.82 feet to a concrete monument found;
- 9.) South 12 degrees 28 minutes 12 seconds West, 55.67 feet to a concrete monument found;
- 10.) South 86 degrees 30 minutes 05 seconds West, 14.26 feet to a concrete monument found;
- 11.) South 50 degrees 12 minutes 51 seconds West, 106.24 feet to an iron pin found;
- 12.) South 78 degrees 31 minutes 39 seconds West, 118.26 feet to an iron pin found;
- 13.) South 73 degrees 02 minutes 08 seconds East, 219.23 feet to a concrete monument found on the north line of lands presently owned by George V. Thompson, (OR 2620-879);

Thence along the lines of said Thompson lands the following three courses:

- 1.) South 85 degrees 03 minutes 53 seconds West, 228.09 feet to an iron pin found;
- 2.) South 38 degrees 56 minutes 10 seconds West, 276.65 feet to an iron pin found;
- 3.) South 54 degrees 13 minutes 06 seconds West, 297.00 feet to an iron pin found on the northeast corner of lands presently owned by Letterina and Richard T. Franz, Co-Trustees, (DR 1162-216);

Thence along the north line of said Franz lands, South 54 degrees 31 minutes 43 seconds West, 2271.61 feet to a point in a creek, on the northwest corner of said Franz lands, passing iron pins set at 37.50 feet, and 2237.95 feet;

25-30-03-02-000 B
25-30-14-18-000 B
25-30-14-20-000 B
25-30-13-06-000 B
25-30-13-03-000 B
25-16-08-17-000 B

25-16-08-15-000 B
25-16-01-16-000 B
25-20-01-23-000 B

Thence along the west line of said Franz lands, South 03 degrees 14 minutes 32 seconds West, 382.81 feet to a stone found on the northwest corner of lands presently owned by Ryan and Shelli Corl, (OR 2549-655);

Thence along the west line of said Corl lands, South 01 degrees 01 minutes 32 seconds West, 658.80 feet to the principal place of beginning, containing 251.54 acres, more or less, and being all of Auditors Parcel Numbers 25-30-03-02-000 +- 34.19 Acres, 25-30-14-18-000 +- 11.38 Acres, (0.24 Acres in R\W of Twp. Rd. 609), 25-30-14-20-000 +- 1.10 Acres, (+- 0.07 Acres in R\W Twp. Rd. 609), 25-30-13-06-000 +- 80.36 Acres, 25-30-13-03-000 +- 38.02 Acres, 25-16-08-17-000 +- 11.61 Acres, 25-16-08-15-000 +- 7.41 Acres, 25-16-01-16-000 +- 65.33 Acres, and 25-20-01-23-000 +- 2.14 Acres, (+- 0.21 Acres in R\W of Co. Rd. 47);

Subject to all legal recorded easements and right of ways.

Iron pins set are 5/8 inch rebars, 30 inches long, with plastic identification caps.

Bearings are based on the Ohio State Plane Coordinate System, NAD 83, South Zone, Grid North, as per GPS observations.

This description is written based on a field survey completed January 31, 2018 by Jack D. Newcome, Reg. No. 7321.

OFFICE COPY

Jack D. Newcome
NOT RECORDABLE
Jack D. Newcome, Reg. No. 7321

5-24-18

Date

DESCRIPTION

APPROVED

By: *[Signature]* 5/24/2018



25-30-14-18-000 C

25-30-13-06-000 C

25-16-08-17-000 C

25-16-01-16-000 C

25-20-01-23-000 C

SITUATED IN:

State of Ohio, County of Muskingum, Township of Hopewell, Quarter Township 1, and being a part of Lot 16, Lot 17, and Lot 25, Quarter Township 2, and being part of the Southwest Quarter of Section 8, the Northwest Quarter of Section 13, and the Northeast Quarter of Section 14, Quarter Township 3, and being a part Lot 7, Township 1, Range 9, United States Military Lands.

DESCRIPTION
APPROVED

By: *[Signature]*

LEGEND

- ▲ Railroad Spike Set
- Iron Pin Found
- ⊞ Stone Found
- Axle Found
- Iron Pipe Found
- ▲ Railroad Spike Found
- ⊙ Iron Pin Set, 5/8" rebar
- ⊞ Monument Found

Centerline of
Macedonia Road
(Twp. Rd. 609)
R\W 40'
Assumed

John Richard Scott
DR 969-55
25-30-14-20-000

John Richard Scott
DR 969-55

Jinx A. Thompson
OR 2773-195
(Previous Deeds)
DR 1150-603(1\2 Int.)
DR 1626-775(1\2 Int.)
+/- 251.54 Acres

NW Qrt. Section 13,
Lot 7, Qrt. Twp. 3

Terry A.
Blackstone
OR 1543-274



Eloise Ruth Bishop
OR 2567-121

Timothy Matthew Bishop
OR 2557-812

Corrective Plat of Survey

BASIS OF BEARINGS

Bearings are based on the Ohio State Plane Coordinate System, NAD 83, South Zone, Grid North as per GPS observations.

REFERENCES

DR 1150-603
DR 1626-775
OR 2602-887
OR 2627-127
OR 2549-855
OR 2620-879
DR 494-235
OR 2557-812
Dillon Topo Map,
Sheets 72, and 77

PARCEL NO.S

All of: 25-30-03-02-000 +/- 34.19 Ac.
All of: 25-30-14-18-000 +/- 11.38 Ac.
(+/- 0.24 Acres in R\W Twp. Rd. 609)
All of: 25-30-14-20-000 +/- 1.10 Ac.
(+/- 0.07 Acres in R\W Twp. Rd. 609)
All of: 25-30-13-06-000 +/- 80.36 Ac.
All of: 25-30-13-03-000 +/- 38.02 Ac.
All of: 25-16-08-17-000 +/- 11.61 Ac.
All of: 25-16-08-15-000 +/- 7.41 Ac.
All of: 25-16-01-16-000 +/- 65.33 Ac.
All of: 25-20-01-23-000 +/- 2.14 Ac.
(+/- 0.21 Acres in R\W of Co. Rd. 47)

COURSE	BEARING	DISTANCE
L-1	N 03°50'46"E	142.52'
L-2	S 85°53'21"W	164.28'
L-3	N 02°37'30"E	25.11'
L-4	S 87°32'57"W	50.35'
L-5	S 87°32'57"W	41.35'
L-6	N 03°22'59"E	407.04'
L-7	N 02°22'54"E	162.68'
L-8	N 02°31'41"W	68.92'
L-9	N 08°52'01"W	61.24'
L-10	S 88°31'19"E	43.83'
L-11	S 88°31'19"E	263.91'
L-12	S 02°45'30"E	160.00'

COURSE	BEARING	DISTANCE
L-14	S 62°34'57"E	15.87'
L-15	S 57°41'35"E	203.33'
L-16	S 42°09'36"E	237.48'
L-17	S 29°31'09"W	119.34'
L-18	S 31°59'22"W	312.86'
L-19	S 61°06'34"W	196.83'
L-20	S 89°19'41"E	41.86'
L-21	S 60°42'50"W	36.82'
L-22	S 12°28'12"W	55.67'
L-23	S 86°30'05"W	14.26'
L-24	S 50°12'51"W	106.24'
L-25	S 78°31'39"E	118.26'
L-26	S 73°02'08"E	219.23'
L-27	S 85°03'53"W	228.09'
L-28	S 38°56'10"W	276.65'

**Southeast Corner of the
Northwest Quarter of
Section 13, T 1, Range 9,
U. S. M. L.**

Scott T. Bare Jr. et al
OR 2681-736

**OFFICE COPY
NOT RECORDABLE**

Jack D. Newcome

Date

Reg. Surveyor No. 7321



Newcome Surveying Company
6515 Ballard Road
Nashport, Ohio
740-452-5796