

25-35-01-14-000

Re-Survey of David J. and Ruth E. Mast Lands in Hopewell Township, Muskingum County

Situated in the State of Ohio, County of Muskingum, Township of Hopewell, Quarter Township 1, and being part of Lot 23, Township 1, Range 9, United States Military Lands, and being all of the lands presently owned by David J. and Ruth E. Mast, as per Deed Record 725, Page 341, and being more particularly described as follows:

Beginning for reference and the principal place of beginning, at a stone found at the southeast corner of Lot 23, Township 1, Range 9, United States Military Lands;

Thence along the south line of said Lot 23, and the north line of lands presently owned by Welsh East LLC, (OR 2629-950), North 87 degrees 42 minutes 52 seconds West, 418.57 feet to an iron pin found on the southeast corner of lands presently owned by Justin Polk, (OR 2777-271);

Thence along the east lines of said Polk lands, the following three courses:

- 1.) North 04 degrees 06 minutes 19 seconds East, 819.89 feet to an iron pin found;
- 2.) North 17 degrees 28 minutes 44 seconds West, 206.00 feet to an iron pin found;
- 3.) North 40 degrees 31 minutes 39 seconds East, 800.08 feet to an iron pin found on the west line of lands presently owned by Carl Keith and Gayle Lynn Kreager, (DR 906-269);

Thence along the east line of said Lot 23, and the west lines of said Kreager lands, and lands presently owned by, Kelvin G. and Patricia Kreager, (DR 906-271, OR 2848-323), John P. and Ann M. Janusz, (DR 1150-353), Antony L. Hutchison, (OR 2857-436), Jeffrey D. and Kelly Wiler, (OR 1776-704), and Robert L Shreve, (OR 2268-623), South 03 degrees 26 minutes 19 seconds West, 1642.06 feet, to the principal place of beginning, passing iron pins found at 95.51 feet, 211.07 feet, 432.43 feet, 672.04 feet, (offline to the west 0.38 feet), 1015.17 feet, and 1562.05 feet, containing 13.25 acres, more or less, and being all of Auditor's Parcel Number 25-35-01-14-000.

Subject to all legal recorded easements and right of ways.

Iron pins set are 5/8 inch rebars, 30 inches long, with plastic identification caps.

Bearings are based on the Ohio State Plane Coordinate System, NAD 83, South Zone, Grid North, as per GPS observations.

This description is written based on a field survey completed April 24, 2020, by Jack D. Newcome, Reg. No. 7321.

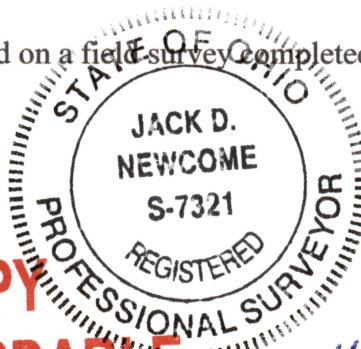

**OFFICE COPY**  
**NOT RECORDABLE**

Jack D. Newcome, Reg. No. 7321

4-29-20  
Date

DESCRIPTION

APPROVED

By: PC 8/4/20