

Baseline Surveying, Inc.

Land Surveying and Construction Layout

3010 East Pike
Zanesville, OH 43701

Email: bei@rohio.com

Telephone (740) 453-4850
Fax (740) 450-1000

MARY RITA BAUER
AUDITORS PARCEL NUMBERS
25-25-55-22-47-000 (ALL – 2.023 ACRES)

BEING PARCEL 1 AS CONVEYED TO MARY RITA BAUER IN O.R. VOLUME 2208, PAGE 634 OF THE MUSKINGUM COUNTY OFFICIAL RECORDS, SITUATED IN SECTION 22, TOWNSHIP 1, RANGE 9, OF THE UNITED STATES MILITARY LANDS, HOPEWELL TOWNSHIP, MUSKINGUM COUNTY, OHIO AND BEING FURTHER DESCRIBED AS FOLLOWS:

COMMENCING AT THE NORTHEAST CORNER OF SECTION 23;

THENCE WITH THE EAST LINE OF THE SAID SECTION, SOUTH 00 DEGREES 17 MINUTES 23 SECONDS EAST 2274.18 FEET (CALCULATED) TO A POINT IN THE CENTER OF HOPEWELL NATIONAL ROAD (COUNTY ROAD 415), PASSING AN IRON PIN SET AT 999.07 FEET (CALCULATED) AND EXISTING IRON PINS (5/8 INCH REBAR WITH WALTON CAP) AT 1072.07 FEET AND 2249.18 FEET.

THENCE LEAVING THE SAID SECTION LINE, NORTH 88 DEGREES 30 MINUTES 21 SECONDS EAST 1604.29 FEET TO A POINT IN THE CENTER OF THE SAID ROAD, SAID POINT BEING THE **PLACE OF BEGINNING** FOR THE TRACT HEREIN INTENDED TO BE DESCRIBED;

THENCE CONTINUING WITH THE SAID ROAD THE FOLLOWING TEN COURSES AND DISTANCES:

1. SOUTH 82 DEGREES 22 MINUTES 44 SECONDS EAST 36.80 FEET TO A POINT;
2. SOUTH 82 DEGREES 15 MINUTES 50 SECONDS EAST 14.48 FEET TO A POINT;
3. SOUTH 75 DEGREES 52 MINUTES 39 SECONDS EAST 27.01 FEET TO A POINT;
4. SOUTH 68 DEGREES 47 MINUTES 51 SECONDS EAST 27.15 FEET TO A POINT;
5. SOUTH 61 DEGREES 24 MINUTES 59 SECONDS EAST 24.57 FEET TO A POINT;
6. SOUTH 55 DEGREES 00 MINUTES 10 SECONDS EAST 25.14 FEET TO A POINT;
7. SOUTH 43 DEGREES 12 MINUTES 14 SECONDS EAST 27.47 FEET TO A POINT;
8. SOUTH 42 DEGREES 25 MINUTES 14 SECONDS EAST 26.22 FEET TO A POINT;
9. SOUTH 39 DEGREES 36 MINUTES 29 SECONDS EAST 108.13 FEET TO A POINT, SAID POINT BEING SOUTH 01 DEGREES 45 MINUTES 30 SECONDS EAST 35.00 FEET FROM AN EXISTING IRON PIN (5/8 INCH REBAR WITH FINLEY CAP);
10. SOUTH 38 DEGREES 59 MINUTES 42 SECONDS EAST 19.77 FEET TO A POINT;

THENCE LEAVING THE SAID ROAD, AND WITH THE NORTH LINE OF A PARCEL CONVEYED TO THE STATE OF OHIO IN DEED VOLUME 400, PAGE 105 THE FOLLOWING FIVE COURSES AND DISTANCES:

1. SOUTH 50 DEGREES 44 MINUTES 47 SECONDS WEST 51.33 FEET TO AN IRON PIN SET AT STATION 990+79.12, 273.44 FEET LEFT OF CENTERLINE OF U.S. ROUTE 40, PASSING AN IRON PIN SET AT 41.33 FEET;
2. SOUTH 22 DEGREES 58 MINUTES 13 SECONDS EAST 116.09 FEET TO AN EXISTING MONUMENT (CONCRETE);
3. SOUTH 02 DEGREES 01 MINUTES 47 SECONDS WEST 67.43 FEET TO AN EXISTING MONUMENT (CONCRETE) AT STATION 991+25, 100 FEET LEFT;
4. NORTH 85 DEGREES 01 MINUTES 01 SECONDS WEST 160.69 FEET TO AN EXISTING MONUMENT (CONCRETE) AT STATION 989+69.66, 110 FEET LEFT;
5. NORTH 84 DEGREES 47 MINUTES 27 SECONDS WEST 139.11 FEET TO AN EXISTING IRON PIN (5/8 INCH REBAR WITH DERWACTER CAP);

Baseline Surveying, Inc.

Land Surveying and Construction Layout

3010 East Pike
Zanesville, OH 43701

Email: bei@rrohio.com

Telephone (740) 453-4850
Fax (740) 450-1000

THENCE LEAVING THE SAID NORTH LINE AND WITH THE EAST LINE OF A PARCEL CONVEYED TO EDWARD M. KENNISON IN DEED VOLUME 1053, PAGE 184, NORTH 05 DEGREES 08 MINUTES 33 SECONDS EAST, PASSING AN EXISTING IRON PIN (5/8 INCH REBAR WITH DERWACTER CAP) AT 328.82 FEET, A TOTAL DISTANCE OF 369.11 FEET TO THE **PLACE OF BEGINNING**;

CONTAINING 2.023 ACRES (ALL OF PARCEL NUMBER 25-25-55-22-47-000), SUBJECT TO ALL LEGAL ROAD RIGHT OF WAYS OF HOPEWELL NATIONAL ROAD (COUNTY ROAD 415) AND ALL OTHER APPLICABLE EASEMENTS.

ALL IRON PINS SET ARE 5/8 INCH X 30 INCH REBAR WITH PLASTIC IDENTIFICATION CAPS (BASELINE PS6923/PS8536).

BEARINGS ARE BASED ON THE PREVIOUS SURVEY OF A 9.057 ACRE PARCEL, COMPLETED NOVEMBER 18, 1985 BY C.R. HARKNESS PS6885.

I, JASON LEACHMAN (PS#8536), HEREBY CERTIFY TO THE BEST OF MY KNOWLEDGE AND BELIEF THE SURVEY AND DESCRIPTION TO BE CORRECT AS PREPARED BY ME, THIS 30TH DAY OF SEPTEMBER, 2015, FROM A FIELD SURVEY COMPLETED THE 30TH DAY OF SEPTEMBER, 2015.

OFFICE COPY

NOT RECORDABLE
JASON LEACHMAN
REGISTERED SURVEYOR 8536



**DESCRIPTION
APPROVED**

By:  11/10/2015

AUDITORS PARCEL NUMBER
25-25-55-22-47-000 (ALL - 2.023 AC.)

BEARINGS ARE BASED ON THE PREVIOUS SURVEY OF A 9.057 ACRE PARCEL, COMPLETED NOVEMBER 18, 1985 BY C.R. HARKNESS PS6885.

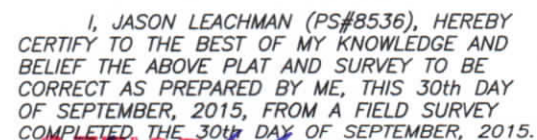

A circular professional seal for Jason Leachman, a Registered Professional Surveyor in the State of Ohio. The seal features the text "STATE OF OHIO" at the top, "JASON LEACHMAN" and "S-6536" in the center, and "REGISTERED PROFESSIONAL SURVEYOR" at the bottom, flanked by two stars. The seal is surrounded by a decorative border of small, repeating patterns.

phone: 740-453-4850, fax: 740-450-1000, email: BEI@rohoio.com

DRAWING NO:
Z:\5815\5815.dwg