

DESCRIPTION OF SURVEY FOR CARSON, TAYLOR, & LENHART

JOB#1837-3

Situated in the State of Ohio, County of Muskingum, Township of Hopewell:

Being part of the Southwest Quarter, of Section 7, of Township #18, Range #15, of the Congress Lands East of the Scioto River, **further being part of the Marilyn Carson, Thomas L Taylor, and Carol J Lenhart property** recorded in Official Record Volume 2283, Page 299, of said county's deed records, further being part of Muskingum County Auditor's Parcel Number 25-77-07-05-000, and more particularly described as follows;

Beginning at the unmarked center of said Section 7, also being in the roadbed of Mt Perry Road (County Road #30);

- TIE-** THENCE South 02 degrees 39 minutes 25 seconds West 965.74 feet along the common line for the Southwest and Southeast Quarters of Section 7 and within said roadbed to the unmarked place of beginning for the property herein intended to be described;
- #1-** THENCE South 02 degrees 39 minutes 25 seconds West 300.00 feet continuing along said Quarter Section line and within said roadbed an unmarked point;
- #2-** THENCE North 85 degrees 06 minutes 40 seconds West 709.16 feet leaving said roadbed, into said Southwest Quarter of Section 7 and through said Carson/Taylor/Lenhart property to an iron pin (set), passing an iron pin (set) at 25.77 feet;
- #3-** THENCE North 78 degrees 35 minutes 55 seconds West 335.29 feet continuing through said Carson/Taylor/Lenhart property to an iron pin (set);
- #4-** THENCE North 36 degrees 04 minutes 35 seconds East 361.71 feet continuing through said Carson/Taylor/Lenhart property to an iron pin (set);
- #5-** THENCE North 51 degrees 11 minutes 45 seconds East 78.08 feet continuing through said Carson/Taylor/Lenhart property to an iron pin (set);
- #6-** THENCE North 66 degrees 22 minutes 55 seconds East 74.91 feet continuing through said Carson/Taylor/Lenhart property to an iron pin (set);
- #7-** THENCE North 89 degrees 38 minutes 50 seconds East 69.84 feet continuing through said Carson/Taylor/Lenhart property to an iron pin (set);
- #8-** THENCE South 56 degrees 38 minutes 45 seconds East 86.42 feet continuing through said Carson/Taylor/Lenhart property to an iron pin (set);
- #9-** THENCE South 43 degrees 18 minutes 40 seconds East 209.01 feet continuing through said Carson/Taylor/Lenhart property to an iron pin (set);
- #10-** THENCE North 89 degrees 53 minutes 05 seconds East 421.28 feet continuing through said Carson/Taylor/Lenhart property to the place of beginning, passing an iron pin (set) at 395.83 feet, **containing 7.18 acres**, of which 0.14 acres are within the right of way for Mt Perry Road (County Road #30).

The bearings within this description are based on State Plane Coordinate Grid (Ohio South 1983) derived from GPS Observations. Iron pins (set) are 5/8" rebar with identification caps (C.R.Harkness P.L.S.6885).

This description was written by Charles R. Harkness Professional Land Surveyor #6885 from an actual survey completed on June 30, 2010 in accordance with Chapter 4733-37 of the Administrative Code, and is intended to be used for the legal transfer of the property described and does not intend to describe all or any easements of record, nor encroachments unless otherwise indicated.

OFFICE COPY
NOT RECORDABLE
Charles R. Harkness P.L.S. 6885



DESCRIPTION
APPROVED
By: *[Signature]* 7/27/10

APPROVED
MUSKINGUM COUNTY
PLANNING COMMISSION DIRECTOR
[Signature]

8/4/10
Date

Fee Paid

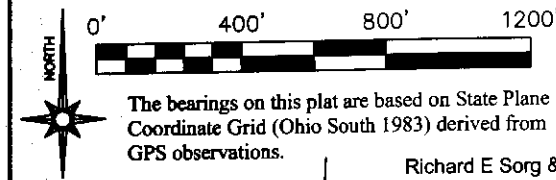

REDUCED SCALE 1"=530'

- LEGEND
- PIN (SET) 5/8" REBAR CAPPED (C.R. HARKNESS PLS#6885)
 - PIN (FOUND)
 - △ POINT (UNMARKED)
 - PIPE (FOUND)
 - ⊗ AXLE (FOUND)
 - X— FENCE OCCUPATION

Michael A Rodeheaver
OR 200810270023469.

Richard E Sorg & Rebecca M
Sorg & Jonathan Sorg
OR Vol. 1515, Page 95.

Steven J Hildebrand
OR Vol. 1734, Page 941.

NE QTR
SEC 7

Dennis G Porter
OR Vol. 1651,
Page 929.

Dennis G Porter
OR Vol. 1961,
Page 544.

Danny D Anderson
& Lisa R Anderson
OR Vol. 2241,
Page 203.

Arthur T Handel JR.
& Judith Handel
OR Vol. 1927,
Page 141.

Approved For Transfer
On-Lot Sewage O.K.

Date 8/2/10
Zanesville - Muskingum Co
Health Department

Situated in the State of Ohio, County of Muskingum, Township of Hopewell:

Being a division of the Southwest Quarter, of Section 7, Township 18, Range 15, of the Congress Lands East of the Scioto River, further being part of the Marilyn Carson & Thomas L Taylor & Carol J Lenhart property recorded in Official Record Volume 2283, Page 299 of said county's deed records, also being part of Muskingum County Auditor's Parcel Number 25-77-07-05-000:

SURVEYOR'S NOTES AND REFERENCES:

Muskingum County Tax Maps and Orthophotos of the area.
All other references are shown or listed.

Note #1- A deflection point along the Range line was recorded in a previous survey of the property by Terry Finley PLS#7222 dated August 1997. No attempt was made to resolve this apparent conflict.

Note #2- Right of way for Mt Perry Road is listed as 40 feet with the Muskingum County Engineer's Office.

Note #3- Survey 3 contains 0.14 acres within the RW for County Road 30.

Ref-1 Knox Energy INC.

OR Vol. 1829, Page 127.

Ref-2 Jordy S Anderson

OR Vol. 2241, Page 205.

Ref-3 Thomas L Taylor

OR Vol. 2262, Page 346.

Ref-4 Carol J Lenhart & Mark D Lenhart

OR Vol. 2189, Page 16.

Ref-5 Arthur T Handel JR & Judith Handel

OR Vol. 1927, Page 241.

Ref-6 Bruce R Bates & Tamara J Bates

OR Vol. 2143, Page 664.

CALL	BEARING	DISTANCE
A	N 43°18'40" W	209.01'
B	N 56°38'45" W	86.42'
C	S 89°38'50" W	69.84'
D	S 86°22'55" W	74.91'
E	S 51°11'45" W	78.08'
F	N 59°25'40" W	130.39'
G	N 87°20'35" W	247.08'
Passing Pin Found		25.20'
H	S 51°37'30" W	14.21'

This plat was prepared by C.R. Harkness
Surveying & Mapping Inc. in accordance
with Chapter 4733-37 of the Administrative
Code, and is intended to be used for the legal
transfer to describe all or any easements of
record, nor encroachments unless otherwise
indicated

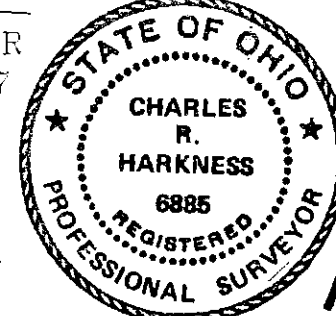

OFFICE COPY
NOT RECORDED
Carson & Taylor & Lenhart

SURVEY FOR

SECTION: 7 TOWNSHIP: Hopewell RANGE: 15 TOWNSHIP: 18
COUNTY: Muskingum STATE OF OHIO

Survey Date: June 30, 2010 Drawn Date: July 9, 2010

C R HARKNESS SURVEYING
& MAPPING, INC.
8205 OLD TOWN ROAD,
ROSEVILLE, OHIO 43777
PHONE/FAX (740) 849-0122

Job Number:
Job #1837

Drawing/Sheet No.
Plat #1

Licking County
Range 16 N 02°35'50" E
Range 15 N 03°46'30" E
Muskingum County
See Note #1
1077.58' 751.80'

Frances S
Robertson
DB Vol. 843,
Page 333.

Laura S Powell & Brian
M Powell OR
200110290038714.

Dollie M Jenkins OR
199710230004258.

SW COR
SEC 7

DESCRIPTION
APPROVED
By: [Signature]

Marilyn Carson & Thomas L
Taylor & Carol J Lenhart
OR Vol. 2283, Page 299.
Parcel #25-77-07-05-000

85.06 ACRES

Marilyn Carson & Thomas L
Taylor & Carol J Lenhart
OR Vol. 2283, Page 299.
Parcel #25-77-07-05-000

40.04 ACRES

NW QTR
SEC 18

Melvin Pettet & Vilma P Pettet
DB Vol. 1161, Page 402.

SW QTR
SEC 7

0.13 ACRES
In Rd RW

7.18 ACRES
Survey 3

20.16 ACRES
Survey 4

0.44 ACRES
In Rd RW

Passing
25.45'

0.09 ACRES
In Rd RW

Passing 335.27'

Mt Perry Road

NE QTR
SEC 18

Fee Paid

Date

8/2/10