

304 East High Avenue
New Philadelphia, Ohio 44663



Phone: (330) 364-1631
Fax: (330) 364-4031
E-Mail: mail.dei@adelphia.net

DESCRIPTION OF A 116.305 ACRE TRACT

Situated in the Township of Jackson, County of Muskingum and the State of Ohio.

Being part of the Southeast Quarter of Section 7, the Southwest Quarter of Section 8, the Northwest Quarter of Section 13, the Northeast Quarter of Section 14 and Part of Lot 16 in the First Quarter of Township 3, Range 9 in the United States Military District and being all of a 3 acre tract, all of a 2.65 acre tract, all of a 41.75 acre tract, all of a 6 acre tract, all of a 30 acre tract, all of a 30.70 acre tract, all of a 2.35 acre tract and all of a 3 acre tract as conveyed to Eileen Fairley Roberts by a deed recorded in Volume 575, Page 17 of the Muskingum County Deed Records, Auditor's Parcel Nos. 29-10-01-21-000, 29-10-07-22-000, 29-10-08-09-000, 29-10-08-10-000, 29-40-13-01-000, 29-40-13-02-000, 29-40-14-01-000, and being more fully described as follows:

Beginning at a point at the southwest corner of the aforementioned 30 acre tract, in the center of Hamby Hill Road (CR-38), the southeast corner of a 5.102 acre tract as conveyed to Thomas F. and Lois C. Tucker (Volume 953, Page 199) and the northwest corner of a 5.128 acre tract as conveyed to George F. and Martha L. Hardesty (Volume 946, Page 302), said point being located N 00° 02' 56" W, 1689.18 feet and S 89° 36' 33" E, 289.56 feet from a stone monument (found) at the southwest corner of the Northwest Quarter of Section 13;

thence from said beginning and with the southwesterly line of said 30 acre tract, the center of said Hamby Hill Road and the northeasterly line of said 5.102 acre tract (Volume 953, Page 199), N 33° 25' 55" W, 397.26 feet to a point on the southwesterly line of said 30 acre tract, in the center of said Hamby Hill Road, the northeast corner of said 5.102 acre tract (Volume 953, Page 199) and the southeast corner of a 5.102 acre tract as conveyed to Donald D. Hood (Volume 845, Page 265);

thence continuing with the southwesterly line of said 30 acre tract, the center of said Hamby Hill Road, the northeasterly line of said 5.102 acre tract (Volume 845, Page 265) and the southwesterly line of the aforementioned 2.35 acre tract, N 33° 31' 52" W, 400.10 feet to a point on the southwesterly line of said 30 acre tract, in the center of said Hamby Hill Road, the northeast corner of said 5.102 acre tract (Volume 845, Page 265), on the southwesterly line of said 2.35 acre tract and the southeast corner of a 5.25 acre tract as conveyed to Jimmie L. Dreibelbiss (Volume 1154, Page 610);

thence continuing with the center of said Hamby Hill Road, the southwesterly line of said 2.35 acre tract, the northeasterly line of said 5.25 acre tract, the southwesterly line of the aforementioned 2.65 acre tract, the southwesterly line of the aforementioned 3 acre tract, the northeasterly line of a 10 acre tract as conveyed to Gary Dayton (Volume 945, Page 340), N 33° 06' 03" W, 968.57 feet to a point in the center of said Hamby Hill Road, the northwest corner of said 3 acre tract, on the northeasterly line of said 10 acre tract and a southwest corner of a 69.916 acre tract as conveyed to Dale L. and Clara B Fairall (Volume 979, Page 251);

thence leaving the center of said Hamby Hill Road and with the north line of said 3 acre tract and the south line of said 69.916 acre tract, S 89° 44' 12" E, 686.78 feet to an iron pin (found) stamped "HARNESS 6885" at the northeast corner of said 3 acre tract, the southeast corner of said 69.916 acre tract, on the line dividing Sections 7 and 8 and on the west line of the aforementioned 41.75 acre tract and passing on line an iron pin (found) stamped "HARNESS 6885" at 32.45 feet;

thence with the east line of said 69.916 acre tract, the line dividing said Sections 7 and 8 and the west line of said 41.75 acre tract, N 00° 42' 12" E, 405.68 feet to an iron pin (set) on the east line of said 69.916 acre tract, on the line dividing said sections, at the northwest corner of said 41.75 acre tract and the southwest corner of a 41.75 acre tract as conveyed to Joe Asselin (Volume 1161, Page 288);

thence with the north line of said 41.75 acre tract (Volume 575, Page 17) and the south line of said 41.75 acre tract (Volume 1161, Page 288), S 89° 33' 02" E, 1946.56 feet to an iron pin (set) at the northeast corner of said 41.75 acre tract (Volume 575, Page 17), on the south line of said 41.75 acre tract (Volume 1161, Page 288) and the northwest corner of a 14 acre tract as conveyed to Joe Asselin (Volume 1161, Page 288);

thence with the east line of said 41.75 acre tract (Volume 575, Page 17), the west line of said 14 acre tract, S 01° 14' 21" W, 580.98 feet to an iron pin (set) on the east line of said 41.75 acre tract, at the southwest corner of said 14 acre tract and the northwest corner of the aforementioned 6 acre tract;

thence with the south line of said 14 acre tract and the north line of said 6 acre tract, S 89° 53' 53" E, 792.47 feet to an iron pin (set) at the southeast corner of said 14 acre tract, the northeast corner of said 6 acre tract, on the east line of the Southwest Quarter of Section 8, the west line of Lot 16 and on the west line of the aforementioned 3 acre tract;

thence with the east line of said 14 acre tract, the east line of said quarter section, the west line of said Lot 16 and the west line of said 3 acre tract, N 01° 14' 21" E, 330.22 feet to a point on the east line of said 14 acre tract, on the east line of said quarter section, on the west line of said lot, the northerly corner of said 3 acre tract and in the center of Wakatomika Creek;

thence with the east line of said 3 acre tract and the center of said Wakatomika Creek the following eight (8) courses: S 11° 25' 57" E, 312.75 feet to a point;

thence S 19° 20' 56" E, 112.34 feet to a point;

thence S 21° 38' 53" E, 478.12 feet to a point;

thence S 15° 24' 40" E, 101.84 feet to a point;

thence S 14° 22' 17" W, 172.21 feet to a point;

thence S 45° 22' 11" W, 142.13 feet to a point;

thence S 55° 24' 25" W, 61.22 feet to a point;

thence S 72° 43' 53" W, 142.91 feet to a point at the southwest corner of said 3 acre tract, in the center of said Wakatomika Creek, on the west line of said Lot 16, on the east line of said Southwest Quarter of Section 8, on the east line of the aforementioned 30.70 acre tract and a corner of a 94.585 acre tract as conveyed to Troy W. and Sheila R. Everett (Volume 1078, Page 609);

thence continuing with the center of said Wakatomika Creek, the south line of said 30.70 acre tract and the north line of said 94.585 acre tract the following three (3) courses: S 72° 46' 23" W, 700.00 feet to a point;

thence S 66° 03' 51" W, 620.91 feet to a point;

thence S 50° 07' 25" W, 231.22 feet to a point in the center of said Wakatomika Creek, the southwest corner of said 30.70 acre tract, on the north line of said 94.585 acre tract and a corner of a 3.48 acre tract as conveyed to Viola F. Hardesty (Volume 608, Page 210);

thence with the west line of said 30.70 acre tract and the east line of said 3.48 acre tract, N 01° 32' 04" E, 288.01 feet to a stone monument (found) on the west line of said 30.70 acre tract, at the northeast corner of said 3.48 acre tract and the southeast corner of said 30 acre tract and passing on line an iron pin (found) stamped "NEWCOME" at 105.12 feet;

thence with the north line of said 3.48 acre tract, the south line of said 30 acre tract and the north line of said 5.128 acre tract, N 89° 36' 33" W, 1022.56 feet to the Place of Beginning and passing on line a 5/8" iron pin (found) at 514.62 feet and an iron pin (set) at 998.82 feet, containing **116.305 acres**, more or less of which 2.996 acres is all of a 3 acre tract and 2.709 acres is all of a 2.65 acre tract in the Southeast Quarter of Section 7 (Parcel No. 29-10-07-22-000), 38.678 acres is all of a 41.75 acre tract (Parcel No. 29-10-08-09-000)

and 5.103 acres is all of a 6 acre tract (Parcel No. 29-10-08-10-000) in the Southwest Quarter of Section 8, 29.182 acres is all of a 30 acre tract (Parcel No. 29-40-13-02-000) and 30.083 acres is all of a 30.70 acre tract (Parcel No. 29-40-13-01-000) in the Northwest Quarter of Section 13, 2.455 acres is all of a 2.35 acre tract in the Northeast Quarter of Section 14 (Parcel No. 29-40-14-01-000) and 5.099 acres is all of a 3 acre tract in Lot 16, subject to all legal highways, easements, reservations and restrictions of record.

Bearings are oriented to the south line of a 69.916 acre tract as recorded in Volume 979, Page 251 of the Muskingum County Deed Records.

All iron pins set are 30" x $\frac{3}{4}$ " round steel bars with plastic caps stamped "D A Bower 5753".

Description prepared from a field survey by David A. Bower, Registered Surveyor No. 5753 in August 2006.

APPROVED FOR CLOSURE

DA B 10/13/2006

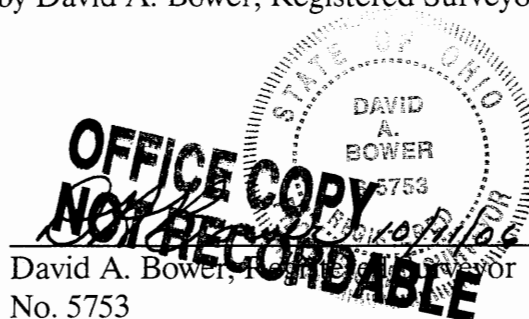

David A. Bower, Registered Surveyor
No. 5753

EXEMPT FROM
PLANNING COMMISSION

DA B 10/13/2006



Bearings are oriented to the south line of a 69.916 acre tract as recorded in Volume 979, Page 251. Iron pins (set) are 30"x3/4" steel rod with plastic cap stamped D.A. Bower, #5753.

EXEMPT FROM
PLANNING COMMISSION

STATE OF OHIO
DAVID A. BOWER
REGISTERED SURVEYOR #5753
**OFFICE COPY
NOT RECORDABLE**
DAVID A. BOWER, REGISTERED SURVEYOR #5753



FILE ID: MISC-225	SHEET 1 OF 1

**DIVERSIFIED
ENGINEERING
INC.** 304 East High Avenue
New Philadelphia, Ohio
Phone 330-364-1631