

## DESCRIPTION OF SURVEY FOR RAYMOND J. TOOLE

JOB #719-2

Situating in the State of Ohio, County of Muskingum, Township of Madison:

Being part of the Quarter Township #2, Township #2, Range #7, of the US Military District, being all of Parcel Two of the Raymond & Flossie Toole property described in deed reference Deed Book Volume 1086, Page 497 of said county's deed records, also being known as Muskingum County Auditor's Parcel Number 38-80-02-24-000, and more particularly described as follows;

Commencing (by deed) at a concrete monument 30 feet left of center line Station 10+53.31 of State Route #666 (North River Road) as shown on the location survey recorded in Plat Book 14, Page 61 of said county's plat records; thence N 80 48 10 E 30.00 feet (by deed) to the center of said State Route #666; thence S 09 11 50 E 56.63 feet (by deed) along said center line; thence S 06 41 50 E 147.84 feet (by deed) continuing along said center line; thence S 14 41 50 E 136.33 feet (by deed) continuing along said center line; thence S 18 34 20 E 696.21 feet (by deed) continuing along said center line; thence S 00 04 30 W 396.45 feet (by deed) continuing along said center line; thence S 01 48 50 W 1041.40 feet (by deed) continuing along said center line; thence N 88 11 20 W 20.00 feet (by deed) leaving said road to an iron pipe (found) at the Northeast corner of the Second Parcel of the H & C Smith property as described in deed reference Deed Book Volume 1090, Page 528; thence S 01 48 40 W 99.99 feet along the East line of said Smith Second Parcel to an iron pipe (found) at the Southeast corner of said Smith Second Parcel also being the Northeast corner of the First Parcel of said Smith deed; thence S 02 16 30 W 100.00 feet along the East line of said Smith First Parcel to an iron pin (set) at the Southeast corner of said Smith First Parcel; thence S 88 05 10 E 21.27 feet extending the South line of said Smith First Parcel to the center line of said State Route #666; thence S 02 23 30 W 101.61 feet along the center of said road to the place of beginning for the property herein intended to be described;

- #1- thence S 02 06 40 W 100.00 feet continuing along the center of said road;
- #2- thence N 87 11 20 W 306.36 feet along the common line of said Toole Parcel Two and Parcel Three to the East line of the Muskingum River;
- #3- thence N 03 25 20 E 100.00 feet along the East line of said river to the Southwest corner of said Toole Parcel One;
- #4- thence S 87 11 20 E 304.07 feet along the common line for said Toole Parcel Two and Parcel One to the place of beginning, containing 0.70 acres.

The bearings within the description are based on the East line of the H & C Smith property as described in deed reference Deed Book Volume 1090, Page 528. Bearings are shown in a format of Degrees, Minutes, and Seconds. Iron pins (set) are 5/8" rebar with identification caps (C.R.Harkness P.L.S.6885).

This description was written by Charles R. Harkness Professional Land Surveyor #6885 from an actual survey completed on May 7, 1995, in accordance with Chapter 4733-37 of the Administrative Code, and is intended to be used for the legal transfer of the property described and does not intend to describe all or any easements of record, nor encroachments unless otherwise indicated.

RECEIVED APPROVED  
FOR RECORDS TRANSFER







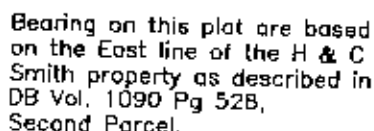



BY Charles R. Harkness  
5-17-96

OFFICE COPY  
NOT RECORDABLE

Charles R. Harkness PLS #6885



Concrete Monument 30' Lt CL  
Sta 10+53.31 SR #666, CL  
Survey plat recorded in PB 14,  
Pg 61.

- LEGEND
-  STONE (FOUND) WITH X - 
-  CONCRETE MONUMENT (FOUND)
-  AXLE (FOUND)
-  IRON PIPE (FOUND)
-  IRON PIN (FOUND)
-  RAILROAD SPIKE (FOUND)
-  PK NAIL (FOUND)
-  POINT
-  IRON PIN (SET) 5/8" REBAR  
WITH IDENTIFICATION CAP  
( C R HARKNESS PLS 5885 )

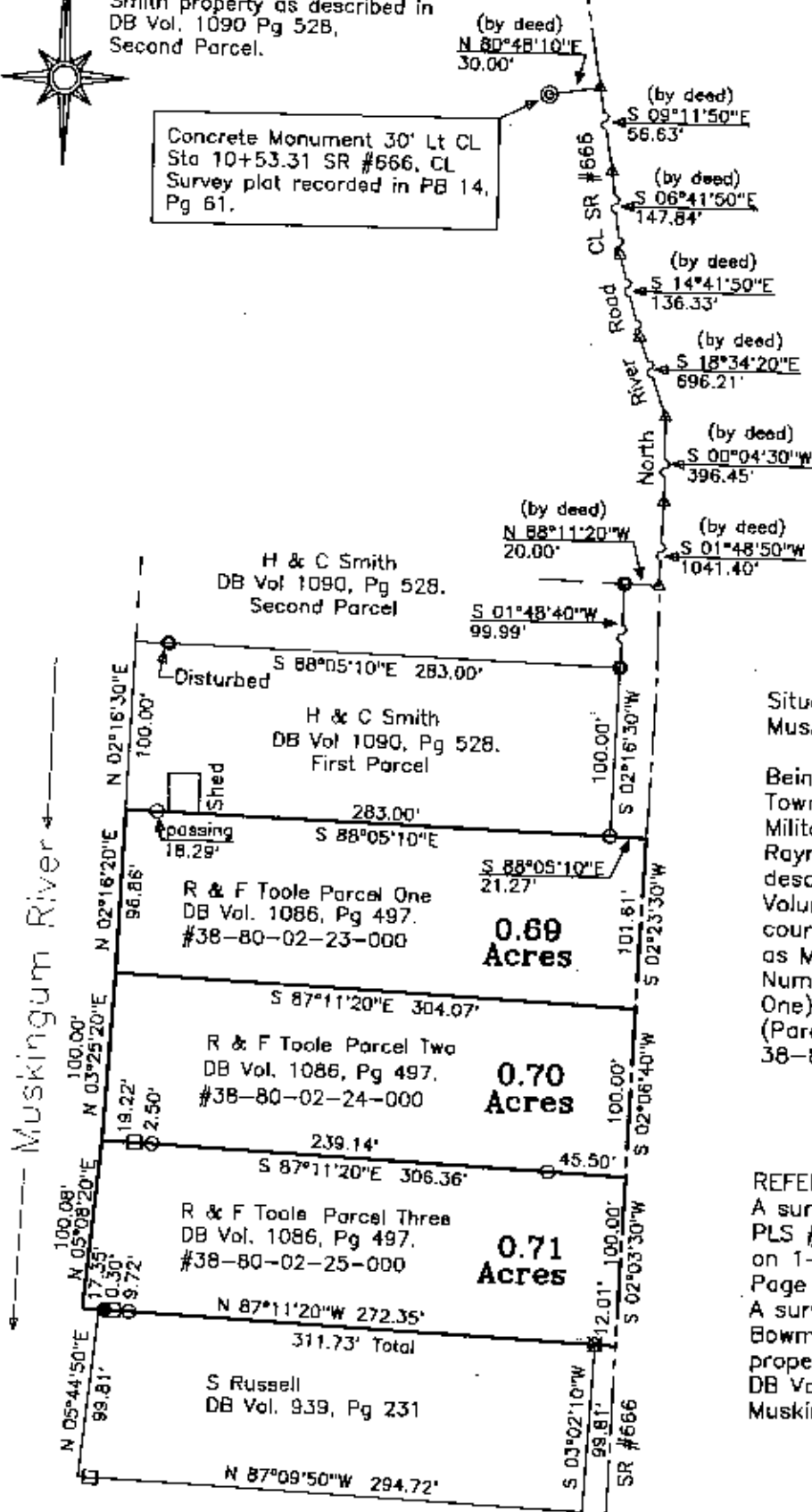

Situated in the State of Ohio, County of  
Muskingum, Township of Madison:

Being part of the Quarter Township #2,  
Township #2, Range #7, of the US  
Military District, being all of the  
Raymond & Flossie Toole property  
described in deed reference Deed Book  
Volume 1086, Page 497 of said  
county's deed records, also being known  
as Muskingum County Auditor's Parcel  
Number 38-80-02-23-000 (Parcel  
One), Number 38-80-02-24-000  
(Parcel Two), Number  
38-80-02-25-000 (Parcel Three);

REFERENCES NOT SHOWN OR LISTED:  
A survey completed by W J Biedenbach  
PLS #5718, of the Neal Smitley property,  
on 1-14-85, recorded in DB Vol. 939,  
Page 231.  
A survey completed by Stephen M.  
Bowman PLS #7135 of the A Hodel  
property, on 2/09/91, as described in  
DB Vol. 1090, Page 528.  
Muskingum County Tax Maps of the area.

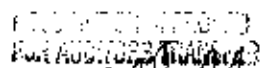

87

5-17 96

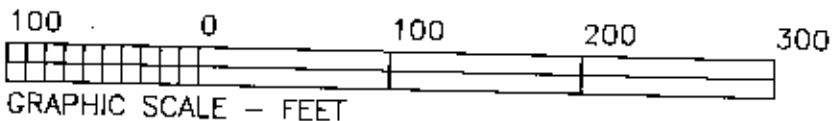

This plat was prepared by C. R. Harkness Surveying & Mapping Inc. in accordance with Chapter 4733-37 of the Administrative Code, from an actual survey and is intended to be used for the legal transfer of the property shown and does not intend to show all or any easements of record, nor encroachments unless otherwise indicated.

**OFFICE COPY  
NOT RECORDABLE**

Charles R. Harkness

SURVEY FOR:  
Raymond J. Toole  
7865 North River Road  
Zanesville, Ohio 43701

SECTION: Off Twp #2	TOWNSHIP: #2	RANGE: #7
TWP OF: Madison	COUNTY: Muskingum	STATE OF OHIO
Survey Date: 5/7/96	Drw date 5/16/96 By: CRH	

C. R. HARKNESS SURVEYING & MAPPING INC.  
768 DRYDEN ROAD  
Zanesville, Ohio 43701 Phone (614) 454-6367

Job Number:  
H719

Drawing/Sheet No.  
Plat #01