

APPROVED
MUSKINGUM COUNTY
PLANNING COMMISSION DIRECTOR

2/24/16
Date

Fee Paid

Survey Split from Carol A. Hamilton Lands in Monroe Township

Situated in the State of Ohio, County of Muskingum, Township of Monroe, and being part of the Northwest Quarter of Section 21, Township 3, Range 5, United States Military Lands, and being part of the lands presently owned by Carol A. Hamilton, Trustee of the Hamilton Family Trust Agreement as per Official Record 1901, Page 166, Tract Two, and being more particularly described as follows:

Beginning for reference at an iron pin found on the southwest corner of the Northwest Quarter of Section 21, Township 3, Range 5, United States Military Lands, from which a concrete monument found, marked Acheson Reference Monument No. 1, bears South 76 degrees 09 minutes 01 seconds West, 6.26 feet;

Thence along the section line, and the east line of lands presently owned by Paul Douglas, Paul R., and Shirley J. McCulley, (OR 1148-509), North 00 degrees 56 minutes 34 seconds East, 363.00 feet to an iron pin set, and being the principal place of beginning;

Thence continuing along the section line, and said McCulley lands, North 00 degrees 56 minutes 34 seconds East, 532.26 feet to a point in the centerline of Lookout Road, (Co. Rd. 101), passing an iron pin found at 498.12 feet;

Thence along the centerline of said road the following two courses:

- 1.) North 58 degrees 06 minutes 36 seconds East, 81.57 feet to a point;
- 2.) North 56 degrees 45 minutes 16 seconds East, 146.06 feet to a point;

Thence leaving said centerline and through the lands presently owned by Carol A. Hamilton, Trustee of the Hamilton Family Trust Agreement, (OR 1901-166, Tract Two), South 46 degrees 31 minutes 14 seconds East, 479.50 feet to an iron pin set on the north line of lands presently owned by Robert S., and Paul C. Dickson, (OR 2074-15), passing an iron pin set at 28.89 feet;

Thence along the north line of said Dickson lands, South 59 degrees 18 minutes 06 seconds West, 637.43 feet to the principal place of beginning, containing 4.53 acres, more or less, and being part of Auditor's Parcel Number 42-90-21-09-000, of which +- 0.12 acres is in the right of way of County Road 101.

Subject to all legal recorded easements and right of ways.

Iron pins set are 5/8 inch rebars, 30 inches long, with plastic identification caps.

Bearings are based on the Ohio State Plane Coordinate System, NAD 83, South Zone, Grid North, as per GPS observations.

This description is written based on a field survey completed February 19, 2016, by Jack D. Newcome, Reg. No. 7321.

OFFICE COPY
Jack D. Newcome

Jack D. Newcome, Reg. No. 7321

NOT RECORDABLE

DESCRIPTION

APPROVED

By: 2/24/16

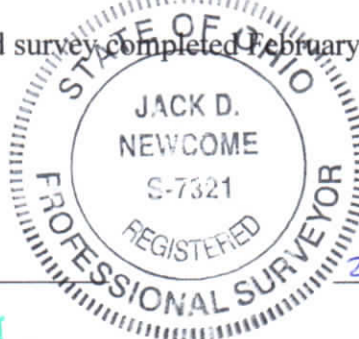

2-22-16

Date

SITUATED IN:

State of Ohio, County of Muskingum,
Township of Monroe, and being part
of the Northwest quarter of Section
21, Township 3, Range 5, United
States Military Lands.

APPROVED
MUSKINGUM COUNTY
PLANNING COMMISSION DIRECTOR

BASIS OF BEARINGS

Bearings are based on the Ohio State
Plane Coordinate System, NAD 83, South
Zone, Grid North, as per GPS
observations.

REFERENCES

OR 1901-166
OR 2074-15
OR 1148-509
Adj. survey by
F. Neuhart

LEGEND

- ▲ Railroad Spike Set
- Iron Pin Found
- ⊞ Stone Found
- Axle Found
- Iron Pipe Found
- ▲ Railroad Spike Found
- ⊙ Iron Pin Set, 5/8" rebar
- ⊞ Monument Found

PARCEL NO.

Part of: 42-90-21-09-000 +- 4.53 Acres
(+- 0.12 Acres in R\W of Co. Rd. 101)

DESCRIPTION
APPROVED

By: *[Signature]* 2/24/16

Date

Fee Paid

Carol A. Hamilton
Trustee of the
Hamilton Family
Trust Agreement
OR 1901-166
Tract Two

Approved for Transfer
No On-Lot Sewage
Zanesville-Muskingum Co.
Health Department
[Signature]
Date 2/24/16

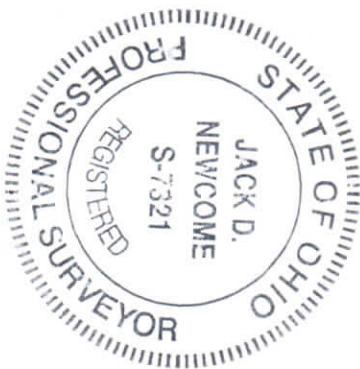

Reg. Surveyor No. 7321

OFFICE COPY
NOT RECORDED
Date 2/24/16
Jack D. Newcome

S 76°09'01" W
6.26'
Acheson Ref.
Mon. No. 1

N 00°56'34" E 363.00' Sec. 22
N 00°56'34" E 498.12' Sec. 21

Paul Douglas,
Paul R., and
Shirley J.
McCuley
OR 1148-509

Carol A. Hamilton
Trustee of the
Hamilton Family
Trust Agreement
OR 1901-166
Tract Two
+- 4.53 Acres

Robert S. and
Paul C. Dickson
OR 2074-15

Centerline of
Lookout Road,
(Co. Rd. 101)
R\W 40'

N 58°06'36"E 81.57'
N 56°45'16"E 146.06'
28.89'

S 46°31'14"E 430.61'

S 59°18'00" W 637.43'

Southwest Corner of the
Northwest Quarter of Section
21, T 3, R 5, U. S. M. L.



Newcome Surveying Company
6515 Ballard Road
Nashport, Ohio
740-458-5796