

Phone and Fax: 740-453-8448

L. Peter Dinan & Associates

27 South Sixth Street

P.O. Box 55, Zanesville, Ohio 43702-0055

SURVEYING & MAPPING

Thomas D. & Erma M. Riley
Part of Parcel #44-02-07-07-000
95.04 Acres

Situated in the State of Ohio, County of Muskingum, Township of Muskingum.

Being a part of the southwest quarter of Section 7, Township 2, Range 8 bounded and described as follows:

Commencing at the southeast corner of the southwest quarter of Section 7; thence along the east line of said southwest quarter of Section 7 north 2 degrees 39 minutes 47 seconds east 553.43 feet to an iron pin found at the northeast corner of a 5.05 acre parcel conveyed to Thomas and Erma Riley by deed recorded in Deed Book 2099, Page 161 and being the true place of beginning of the premises herein intended to be described; thence along the north line of said 5.05 acres south 78 degrees 27 minutes 56 seconds west 454.04 feet to an iron pin found; thence severing the property conveyed to Thomas and Erma Riley by deed recorded in Deed Book 1733, Page 359 south 81 degrees 15 minutes 50 seconds west 810.74 feet to an iron pin placed; thence south 0 degrees 16 minutes 42 seconds west 64.0 feet to an iron pin found at the northwest corner of a 5.00 acre parcel conveyed to Ronald E. Riley by deed recorded in Deed Book 990, Page 165 (also being the basis of bearings of the description and survey); thence severing the property conveyed to Thomas and Erma Riley by deed recorded in Deed Book 1733, Page 359 the following two courses and distances north 87 degrees 53 minutes 42 seconds west 655.64 feet to an iron pin placed; thence south 0 degrees 16 minutes 42 seconds west 230 feet to a point in Fawn Drive, passing an iron pin placed at 208.58 feet; thence along the south line of Section 7 north 87 degrees 46 minutes 45 seconds west 294.33 feet to an iron pin found; thence severing the property conveyed to Thomas and Erma Riley by deed recorded in Deed Book 1733, Page 359 north 35 degrees 26 minutes 37 seconds west 190.96 feet to an iron pin placed at the southeast corner of the premises conveyed to Ronald L. and Karen J. Wilson by deed recorded in Deed Book 920, Page 164; thence along the east lines of said Ronald L. and Karen J. Wilson property the following four (4) courses and distances that are also along the west side of Fawn Drive and that iron pins placed are 18 feet westerly of the centerline of pavement of Fawn Drive; thence north 21 degrees 51 minutes 08 seconds west 231.0 feet to an iron pin placed; thence north 6 degrees 32 minutes 42 seconds west 100.0 feet to an iron pin placed; thence north 1 degree 43 minutes 04 seconds east 863.29 feet to an iron pin placed; thence north 3 degrees 53 minutes 23 seconds west 679.33 feet to an iron pin placed that is south 7 degrees 15 minutes 30 seconds east a distance of 126.15 feet of a stone found that is of record in Survey Record Book 2,

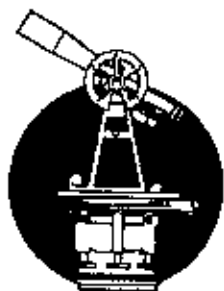

SURVEYING & MAPPING

Phone and Fax: 740-453-8448

L. Peter Dinan & Associates

27 South Sixth Street

P.O. Box 55, Zanesville, Ohio 43702-0055

Page 282 in Muskingum County Engineer Office; thence leaving said road and along the south line of property owned by Neal E. and Shiela E. Dailey by deed recorded in Deed Book 1052, Page 545 south 87 degrees 50 minutes 57 seconds east 2490.18 feet to an iron pin found and passing an iron pin found at 35.66 feet; thence along the west line of property owned by Ronald F. Moran by deed recorded in Deed Book 1061, Page 564 south 2 degrees 30 minutes 16 seconds west 1445.47 feet to the true place of beginning, containing ninetyfive and four hundredths (95.04) acres more or less.

Subject to the easements of Fawn Drive.

This description written from a survey made by L. Peter Dinan, Registered Surveyor #5451, July 30, 20

DESCRIPTION

APPROVED

By:

[Signature]

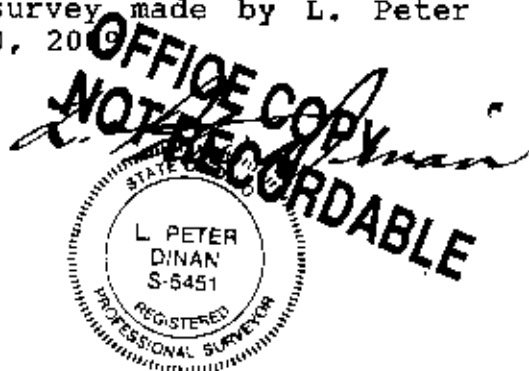

- RONALD L. F. KAREN J. WILSON
DB 970. P. 164

PART OF THE SOUTHWEST QUARTER SECTION 7
TOWNSHIP 2, RANGE 8
IN MUSKINGUM TOWNSHIP
IN MUSKINGUM COUNTY, OHIO
AUG. 1, 2009

95⁰⁴ Ac.

PART OF PARCEL # 44-02-07-07-000

THREE PARCELS 1.71 ACRE, 3.46 ACRE AND 0.83 ACRE
RESPECTIVELY ARE TO BE CONVEYED TO ADJOWNERS.

DESCRIPTION

APPROVED

By: [Signature]



OFFICE COPY
NOT RECORDED
REG. SURVEYOR # 5451

Prior



T. G. E. RILEY
DB. 1733, P. 359

Atk. Wilson

0.83
0.80
0.75
0.70
0.65
0.60
0.55
0.50
0.45
0.40
0.35
0.30
0.25
0.20
0.15
0.10
0.05
0.00

N. 6° 32' 42" W.
100.0'

21°43'04"E
FAW

863.29

DRIVE

73-14673

35.4
K. 3053

5

294.33 W
N. 87° 46' 45" W

21.41'

64.0.42" N. 87°53'42" W. 655.64'
THOMAS D. FERMA N
RILEY DB, 1733, P. 354
J. AG AC.

1874

He

Depa

ent

BOOK 2,9
ENGINE

FAWN DRIVE

5.0° 16' 42" W.
64.0
655.64'

S. 81°15'50"W. 810.74'
T. E. RILEY
20 173

RONALD E. RILEY
DOB 990, P. 165
5.00A9

THOMAS J. ERMA
RUEY D. B. 2099
P. 161
S. 05 AC.

S.E. CORNER
S.W. QUARTER
SECTION 7

N. 2° 39' 47" E.
553.43'

5. 2030-16 ~ W. 1445 17-

RONALD F. MORAN DB 1001, P. 564