

**LINDA IDE**

Situated in the State of Ohio, County of Muskingum, Township of Muskingum, Part of Quarter Township 3 , Township 2, Range 7, bounded and described as follows:

Being part of Linda Ide Volume 2299, page 433, Parcel No. 44-58-01- 04- 0000.

Commencing at a concrete monument found ( Designated as Monument No. 1 on survey plat record in Deed Book 482, page 458, showing Ellis Dam Properties); Thence **North 64° 23'43"East** along State of Ohio Ellis Dam site, Deed Book 482, page 458, **363.22'** feet to a point on Northeast corner of Linda Ide Volume 2299, page 433; Thence along Franklin Real Estate-Ohio Power Volume 275, page 566, **North 60°05'09"West 118.90'** feet to a iron pin set at the Place of Beginning; Thence along split lines of Linda Ide Volume 2299, page 433 the next three courses and distances: **South 44°55'48"West 134.68'** feet to a iron pin set, **North 65° 40'12"West 285.32"** feet to a point, passing a iron pin set at 234.37' feet and **North 56° 08'21"East** along Linda Ide Volume 2260, page 873, **175.96'** feet to a iron pin found at Northwest corner of Linda Ide Volume 2299, page 433; Thence **South 60°05'09"East 241.10'** feet to the Place of Beginning, Containing **0.85 Acres** more or less.

Bearings are based on North line of Ellis Dam Road, bearing North 60°08'34"West.

Iron pins set are No. 5 reinforced bars 30" inches long .

Also the use of a 25.00' foot wide Right of Way for ingress and egress, bounded and described as follows:

Commencing at a concrete monument found ( Designated as Monument No. 1 on survey plat recorded in Deed Book 482, page 458, showing Ellis Dam Properties); Thence **North 60° 08'34"West** along North line of Ellis Dam Road **139.28'** feet to a point at the Place of Beginning; Thence continuing along North line of Ellis Dam Road, **North 60°08'34"West 25.20'** feet to a point; Thence along West line of 25.00' foot right of Way **North 37°05'29"East 151.37'** feet to a point on south line of 0.85 acre parcel; Thence along South line of 0.85 acre parcel **South 65° 40'12"East 25.63'** feet to a point; Thence along East line of 25.00' foot Right of Way **South 37° 05'29"West 153.86'** feet to the Place of Beginning.

Above description is based on a survey by R.L. Daniels Reg. Surveyor No. 5410, April 4, 2012, and is intended for legal transfer of property described and does not intend to desribe all or any easements of record nor encroachments unless otherwise indicated.

Reference Volume 2299, page 433

**OFFICE COPY**  
**NOT RECORDABLE**

**APPROVED**  
**MINOR LOT SPLIT ONLY**  
**MUSKINGUM COUNTY**  
**PLANNING COMMISSION DIRECTOR**

8/17/12  
Date

Fee Paid

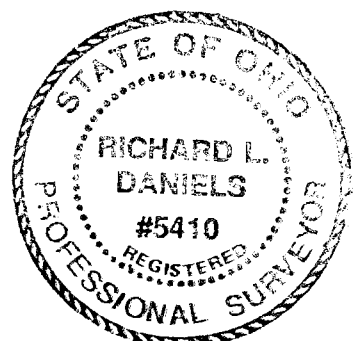

**DESCRIPTION**

**APPROVED**

By: [Signature] 8/17/2012

**PLAT OF SURVEY**  
**Muskingum County, Ohio**  
**Township of Muskingum**  
**T 2, R 7,**  
**Part Quarter Township 3**

**Basis of Bearings**

Bearings are based on  
 North line of Ellis Dam Rd.  
 Bearing N 60°08'34"W.  
 Bearings shown hereon  
 are to an assumed meridian  
 and are used to denote angles  
 only.

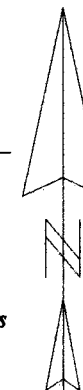

**0.85 Ac.**

Approved For Transfer  
 On Lot Sewage Proposed  
 Date 8/14/12

Zanesville-Muskingum County  
 Health Department

APPROVED  
 MINOR LOT SPLIT ONLY  
 MUSKINGUM COUNTY  
 PLANNING COMMISSION DIRECTOR

Fee Paid

Date

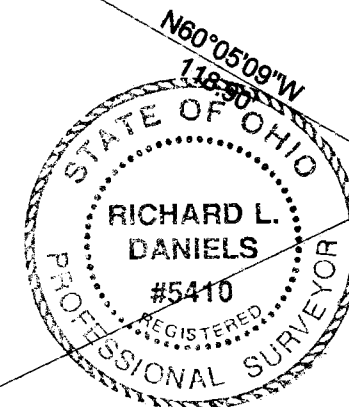

0' 25' 50' 100'

**Ellis Dam Road (40.00')**

Line	Bearing	Distance
1	N60°08'34"W	25.20'
2	S65°40'12"E	25.63'

DESCRIPTION  
 APPROVED

By: [Signature]

Monument # 1  
 Deed Book 482, page 458

State of Ohio  
 Ellis Dam Site  
 Deed Book 482, page 458

**Pertinent Documents And  
 Sources of Data Used :**

1. Deed references as shown
2. Survey by Peter L. Dinan of 2.28 Ac. 10-3-98
3. Tax Map

**LEGEND**

- Iron Pin Set
- Iron Pin Found
- Drill Hole Bottom Concrete Brace  
 Deed Book 482, page 458 (Monument #1)

Part of Linda Ide Volume 2299, page 433  
 Part of Parcel 44-58-01-04-000.

R.L. Daniels Surveying (740) 697-7480  
 61 Old Rainer Rd.  
 Roseville, Oh. 43777

Date : 4-20-12 Scale: 1"= 50'

**OFFICE COPY**  
**NOT RECORDABLE**