

Survey for County of Muskingum

Being a part of land located in the State of Ohio, County of Muskingum, Township of Newton, part of the southeast quarter of Section 3, Township 15 North, Range 14 West, and part of the lands conveyed to the County of Muskingum in Official Record 1751, Page 829, bounded and described as follows:

Commencing at the northeast corner of the southeast quarter of Section 3, being located by magnetic reading and calculations and being in Pinkerton Road (CR 125) (60' wide);
thence along the north line of said southeast quarter and the line dividing Springfield and Newton Townships, North 87 degrees 04 minutes 25 seconds West 208.53 feet to a point in Pinkerton Road (CR 125), the place of beginning for this parcel;

thence leaving the north line of said southeast quarter South 05 degrees 36 minutes 27 seconds West 31.03 feet to an iron pin set;

thence continuing South 05 degrees 36 minutes 27 seconds West 88.94 feet to an iron pin set;

thence North 87 degrees 04 minutes 25 seconds West 102.56 to an iron pin set;

thence North 03 degrees 52 minutes 53 seconds East 66.54 feet to an iron pin set;

thence continuing North 03 degrees 52 minutes 53 seconds East 53.31 feet to a point in Pinkerton Road (CR 125), being the north line of said southeast quarter and the line dividing Springfield and Newton Townships;

thence along the north line of said southeast quarter and the line dividing Springfield and Newton Townships, South 87 degrees 04 minutes 25 seconds East 106.18 feet to the place of beginning, containing 0.29 acres, more or less.

Iron pins set are 5/8 inch rebar 30 inches long with identification caps (DAVIS 7972). This legal description was based on a field survey made in April 2003 by Muskingum County Technical Support. The bearings in this description are based on the north line of the southeast quarter of Section 3, as per C.A.Harkness survey dated 9/20/2000.

Subject to all easements, right of ways, restrictions, reservations, etc., of record and those that may be implied.

References: DR 684-1

DR 946-248

Part of Parcel No.: 47-47-13-01-01-001 (\pm 0.29 acres)

**OFFICE COPY
NOT RECORDED**

Reg. Surv. No. 7972

5/20/2003
Date

DESCRIPTION APPROVED
FOR AUDITOR'S FILE
BY [Signature]
6-2-2003



$SNR_{N/A}$

PART OF THE SOUTHEAST QUARTER OF SECTION 3,
TOWNSHIP 15 NORTH, RANGE 14 WEST

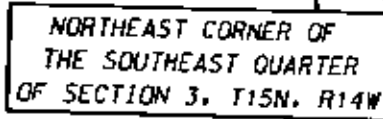

⑥ IRON PIN SET $\frac{5}{8}$ " X 30" W/CAP
MARKED DAVIS S7972
• POINT

BASIS OF BEARING:
BEARINGS ARE BASED ON THE NORTH LINE OF THE
SOUTHEAST QUARTER OF SECTION 3, AS PER
HARKNESS SURVEY DATED 9/20/2000.

PERTINENT DOCUMENTS AND SURVEYS USED:

1. DEED REFERENCES SHOWN
2. TAX MAPS
3. SURVEY RECORDS FOUND IN THE MUSKINGUM COUNTY ENGINEERS OFFICE, ZANESVILLE, OHIO

RESCRIPTION APPROVED
FOR AUDITOR'S TRANSFER
BY [Signature]
6-2-2007

401 MAIN STREET
ZANESVILLE, OHIO 43701
(740) 588-4357

I HEREBY CERTIFY THIS PLAT
TO BE CORRECT AS SURVEYED
APRIL 2003



**OFFICE COPY
NOT RECORDABLE**

DOUGLAS R. DAVIS
PSL# 7972

COUNTY OF MUSKINGUM
PLAT OF SURVEY

DATE 05/13/03

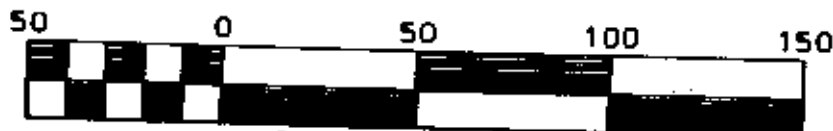

Scale: 1" = 50'