

Situated in the State of Ohio, County of Muskingum, Township of Newton:

Being part of the Southeast Quarter, of Section #10, Township #15, Range #14, of the Congress Lands East of the Scioto River, **being part of the Edith Nolan property** described in deed reference Deed Book Volume 699, Page 338 of said county's deed records, known as **Muskingum County Auditor's Parcel Number 47-29-03-11-000**, and more particularly described as follows;

Commencing at a concrete monument (found) at the center of Section #10; **thence S 03 11 20 W 1047.82 feet** along the common line for the Southeast and Southwest Quarters of Section #10 to a point in the road bed of Moxehala Place (Township Road #84) being the place of beginning for the property herein intended to be described;

- #1- **thence S 81 57 40 E 45.53 feet** into the Southeast Quarter and said Edith Nolan property to an iron pin (set);
- #2- **thence S 85 57 00 E 189.03 feet** continuing through said Edith Nolan property to an iron pin (set);
- #3- **thence N 78 50 30 E 45.60 feet** continuing through said Edith Nolan property to an iron pin (set);
- #4- **thence S 09 53 20 E 139.39 feet** continuing through said Edith Nolan property to an iron pin (set);
- #5- **thence S 28 02 10 E 79.38 feet** continuing through said Edith Nolan property to an iron pin (set);
- #6- **thence S 74 15 10 E 102.01 feet** continuing through said Edith Nolan property to an iron pin (set);
- #7- **thence S 40 51 40 E 54.52 feet** continuing through said Edith Nolan property to an iron pin (set) on the West line of the Southeastern Ohio Railway Company abandoned right of way, also being a common line for said Edith Nolan property and the A. Snedden property recorded in deed reference Deed Book Volume 1108, Page 191;
- #8- **thence S 49 08 40 W 482.24 feet** along the common line for said abandon right of way and Edith Nolan and Snedden properties to the center of said Moxahala Place, passing iron pins (found) at 268.53 feet and 428.59 feet;
- #9- **thence N 78 01 40 W 36.02 feet** along the center of Moxahala Place also being the common line for said Edith Nolan property and for the R. Holdren property recorded in deed reference Deed Book Volume 679, Page 350 to an unmarked point;
- #10- **thence N 55 23 40 W 73.23 feet** continuing along the center of Moxahala Place and common line for said Edith Nolan and Holdren properties to an unmarked point;
- #11- **thence N 24 40 40 W 94.14 feet** continuing along the center of Moxahala Place and common line for said Edith Nolan and Holdren properties to an unmarked point on the West line of said Southeast Quarter;
- #12- **thence N 03 11 20 E 468.78 feet** along the common line for the Southeast and Southwest Quarters of Section #10 to the place of beginning, containing **4.31 acres**.

The bearings within the description are based on State Plane Coordinate Grid derived from a Solar Observation (Local Hour Angle Method). Bearings are shown in a format of Degrees, Minutes, and Seconds. Iron pins (set) are 5/8" rebar with identification caps (C.R.Harkness P.L.S.6885).

This description was written by Charles R. Harkness Professional Land Surveyor #6885 from an actual survey completed on April 14, 1998, in accordance with Chapter 4733-37 of the Administrative Code, and is intended to be used for the legal transfer of the property described and does not intend to describe all or any easements of record, nor encroachments unless otherwise indicated.

DESCRIPTION APPROVED
FOR AUDITOR'S TRANSFER

BY ap205
5-14-98

OFFICE COPY
NOT RECORDED
Charles R. Harkness P.L.S. #6885

47-29-03-11

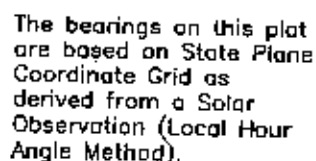

- ☐ PIN (SET) 5/8" REBAR CAPPED
(C R HARKNESS PLSN6885)
- ☒ PIN (FOUND)
- ☐ POINT (UNMARKED)
- ☒ PIPE (FOUND)
- ☒ AXLE (FOUND)
- ☒ CONCRETE MONUMENT (FOUND)

Being part of the Southeast Quarter,
of Section #10, Township #15, Range
#14, of the Congress Lands East of
the Scioto River, being part of the
Edith Nolan property described in
deed reference Deed Book Volume
699, Page 338 of said county's deed
records, known as Muskingum County
Auditor's Parcel Number
47-29-03-11-000;

BY 12870
5-14-98

200 0 200 400 600

GRAPHIC SCALE - FEET

OFFICE COPY
NOT RECORDABLE

Charles R. Harkness PCS #6682

SURVEY FOR:		
Edith Nolan Moxahala Park Rd Zanesville, OH 43701		
SECTION: N10	TOWNSHIP: N15	RANGE: #14
TWP: Newton	COUNTY: Muskingum	STATE OF OHIO
Survey Date: 4/14/98		Draw date 5/2/98 By: CRH
C. R. HARKNESS SURVEYING & MAPPING INC. 768 DRYDEN ROAD Zanesville, Ohio 43701 Phone (614) 454-6367		
Job Number: #836		Drawing/Sheet No. Plat H07