

47-32-12-10-002

CLYDE HINA

Situated in the State of Ohio, County of Muskingum, Newton Township, Township 15, Range 14, Section 12, bounded and described as follows:

Being Part of Clyde Hina Volume 2424, page 503, part of Parcel No. 47-32-12-10-000.

Commencing a iron pin found at the Southwest corner of the Northwest Quarter of Section 12; Thence North $01^{\circ}37'20''$ West along West line of Section 12 2444.83' feet to a point in Jonathan Creek; Thence along Jonathan Creek North $14^{\circ}37'55''$ East 60.00' feet to a point; Thence leaving Jonathan Creek South $48^{\circ}50'58''$ East 177.20' feet to a iron pin found; Thence along Clyde Hina Volume 2424, page 503 North $14^{\circ}07'36''$ East 156.75' feet to a iron pin set at the Place of Beginning; Thence along split lines of Clyde Hina Volume 2424, page 503 the next two courses and distances: North $23^{\circ}32'28''$ East 118.26' feet to a iron pin set and South $52^{\circ}33'06''$ East 416.97' feet to a iron pin set on the west right of way line of Darlington Drive C.R. 46 (40.00' R/W), passing iron pins set 176.97' feet and 351.97' feet; Thence along west right of way line of Darlington Drive (40.00' R/W) South $37^{\circ}02'13''$ West 140.00' feet to a iron pin set; Thence leaving said right of way North $48^{\circ}50'58''$ West 390.37' feet to the Place of Beginning, passing iron pins set at 68.00' feet and 238.00' feet
Containing 1.18 Acres more or less.

Bearings are based on the West line of Section 12, bearing North $01^{\circ}37'20''$ West.

Iron pins set are no. 5 reinforced bars 30" inches long with plastic I.D. caps.

Above description is based on a survey by R.L. Daniels Reg. Surveyor No. 5410, March 16, 2013, and is intended for legal transfer of property described and does not intend to describe all or any easements of record nor encroachments unless otherwise indicated.

Reference Volume 2424, page 503

R.L. Daniels

DESCRIPTION

APPROVED

By:

[Signature]

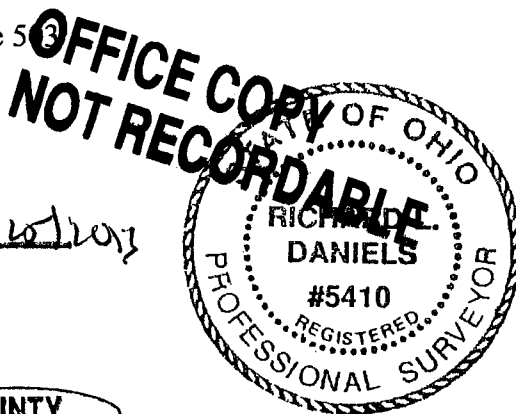

APPROVED

MUSKINGUM COUNTY
PLANNING COMMISSION DIRECTOR

[Signature]

4/2/13
Date

Fee Paid

PLAT OF SURVEY
Muskingum County, Ohio
Newton Township
T 15, R 14, Section 12

Basis of Bearings

*Bearings are based on
West line of Section 12.
Bearing N 1 37'20"W.
Bearings shown hereon
are to an assumed meridian
and are used to denote
angles only.*

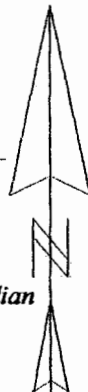

Clyde Hina
Volume 2424, page 503

Section 1
Section 12

**Approved For Transfer
No On-Lot Sewage**

Date 3/19/13

Zanesville - Muskingum Co.
Health Department

Line	Bearing	Distance
1	N 14°37'55"E	60.00'

Pertinent Documents And Sources of Data Used :

1. *Deed References as Shown*
2. *Survey by Robert A. Janes Reg. Surveyor #6029*
(Aug. 2012)
3. *U.S.G.S map*

DESCRIPTION

APPROVED

By: [Signature] 3/20/2013

APPROVED
MUSKINGUM COUNTY
PLANNING COMMISSION DIRECTOR

**Southwest Corner of
the Northwest Quarter
of Section 12**

41 | 21 | 3

Free Paid

LEGEND

- *Iron Pins Set*
- *Iron Pins Found*

Part of Clyde Hina
Volume 2424, page 503
Part of Parcel 47-32-12-10-000

Daniels Surveying (740) 697-7480
61 Old Rainer Rd.
Roseville, Oh 43777

Date: 3-16-12 Scale: 1"=100'

R.L. Daniels
R.L. Daniels Registered Reporter 5410

**OFFICE COPY
NOT RECORD**