

## Alice Russell

Situated in the State of Ohio, County of Muskingum, Township of Newton, Township 15, Range 14, Section 16, bound and described as follows:

Being part of Alice Russell Volume 1081, page 273, Parcel No. 47-46-01-01-000.

Beginning at a stone found at the Northeast corner of Section 16; Thence South 02°52'45" West 1327.09 feet along Donald Moore Volume 1067, page 83 to an iron pin set on the North line of Penn Central Railroad right of way; Thence along said right of way, the next two courses and distances – North 70°21'29" West 203.00 feet to a point on a 1010.37 foot radius curve to the left 395.76 feet to an iron pin found the chord of which bears North 75°38'26" West 393.24 feet; Thence leaving railroad right of way North 02°52'45" East along Sidwell Materials Volume 673, page 47 1188.66 feet to an iron pin set; Thence South 87°16'51" East 579.74 feet to the place of beginning containing 16.54 Acres more or less.

Bearings are based on the East line of Section 16 bearing South 02°52'44" West.

Also the right to continue to use existing private drive for access to Crock Road.

Above description is based on a survey by R.L. Daniels, Registered Surveyor No. 5410, September 4, 2008, and is intended for the legal transfer of property described and does not intend to describe all or any easements of record nor encroachments unless otherwise indicated.

Iron pins set are No. 5 reinforcing bars 30 inches long with plastic ID caps.

Reference: Deed Volume 1081, page 273

**OFFICE COPY  
NOT RECORDABLE**

**APPROVED  
MUSKINGUM COUNTY  
PLANNING COMMISSION DIRECTOR**

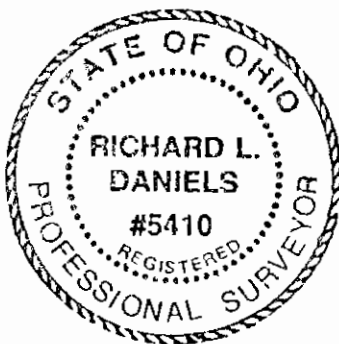

6/6/11  
Date Fee Paid

DESCRIPTION  
APPROVED  
By: *[Signature]* 6/7/11

# PLAT OF SURVEY

Muskingum County, Ohio  
Newton Township,  
Township 15, Range 14, Section 16  
Sidwell Materials Inc.  
Volume 1153, page 97

## Basis of Bearings

Bearings are based on the  
East line of Section 16,  
bearing South 2 52'45" West.  
Bearings shown hereon are to  
an assumed meridian and are  
used to denote angles only.

Sidwell Materials, Inc.  
Volume 673, page 47

Avondale Home  
Volume 1159, Page 441

Donald Moore  
Volume 1067, page 83

## Pertinent Documents and Sources of Data Used:

1. Deed references as shown
2. Survey by Charles R. Harkness  
for Sidwell Materials (6-15-99)
3. U.S.G.S map (Crooksville & Zanesville West)
4. Muskingum County Tax Map of area

Approved For Transfer  
On-Lot Sewage O.K.  
Date 5/18/11

Zanesville - Muskingum Co.  
Health Department

Line	Bearing	Distance
1	N 87°16'51"W	67.89'
2	N 43°27'38"W	73.29'
3	N 25°33'59"W	68.14'
4	N 14°51'13"W	59.05'
5	N 34°20'35"W	61.30'
6	N 48°23'03"W	54.37'
7	N 43°24'51"W	73.03'
8	N 25°34'26"W	71.16'
9	N 18°05'44"W	87.06'
10	N 16°56'39"W	134.38'

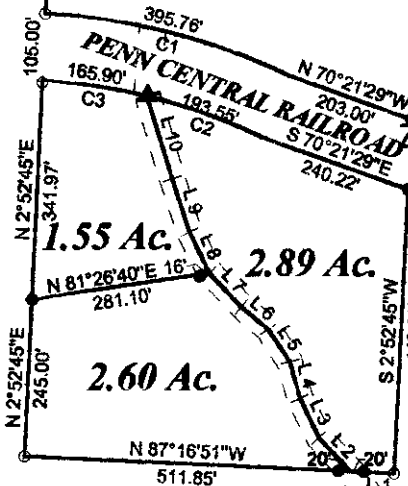

Ohio Power Company  
Volume 313, Page 292



Curve	Delta Angle	Radius	Arc	Tangent	Chord	Chord Bearing
1	22°26'34"	1010.37	395.76	200.45	393.24	N 75°38'26"W
2	12°14'56"	905.37	193.55	97.15	193.19	S 70°12'31"E
3	10°29'56"	905.37	165.90	83.18	165.87	S 81°34'57"E

APPROVED  
MUSKINGUM COUNTY  
PLANNING COMMISSION DIRECTOR

Date  
6/6/11

- LEGEND**
- Iron Pin Set
  - Iron Pin Found
  - Stone
  - ▲ Rail Road Spike

DESCRIPTION  
APPROVED  
By: [Signature]

Fee Paid

R.L. Daniels Reg. Surveyor

0' 150' 300' 600'

CROOK ROAD (Twp. Rd. 265)

Survey Split of Alice Russell  
Volume 1081, page 273  
Parcel No. 47-46-01-01-000

R.L. Daniels & Ass. (740) 697-7480  
61 Old Rainer Road.  
Roseville, Oh. 43777

Date: Aug. 30, 2008 Scale 1" = 300'

OFFICE COPY  
NOT RECORDABLE