

thence, with the south line of said railroad, the following 2 courses:

1. with a curve to the left, having a radius of 1,191.68 feet, an arc length of 108.82 feet, a central angle of $05^{\circ}13'56''$, a chord bearing of North $67^{\circ}11'01''$ East a chord distance of 108.79 feet to a 5/8" iron pin set;
2. thence North $64^{\circ}34'03''$ East a distance of 501.42 feet to a 5/8" iron pin set;

thence, leaving said railroad, South $02^{\circ}37'31''$ West a distance of 873.27 feet to the **POINT OF BEGINNING**;

containing 18.601 acres, more or less, being part of Parcel No. 47-46-02-04-000.

Subject to all legal right-of-ways, easements, restrictions, reservations, and zoning regulations of record.

Subject to the right-of-way of Township Road No. 265 (Crock Road).

Subject to the 100-year Flood Plain restrictions, if applicable.

All iron pins set are 5/8" x 30" rebar capped and labeled "Biedenbach Surveying, LLC. PS 7881".

The bearings in this description are for angle calculations only and are based on the northern portion of east line of the northeast quarter of Section 16 used as a grid bearing of North $02^{\circ}54'53''$ East.

A plat of the above-described survey has been submitted for file at the County Engineer's Office.

The above description prepared by Gregory A. Biedenbach, Ohio Registered Surveyor No. 7881, based on information obtained from an actual field survey of June 10, 2021. Said survey being subject to any facts that may be disclosed in a full and accurate title search.

Prior Deed: Volume 2991, Page 706.

June 10, 2021 *Gregory A. Biedenbach*
Date Gregory A. Biedenbach
Ohio Registered Surveyor
No. 7881.

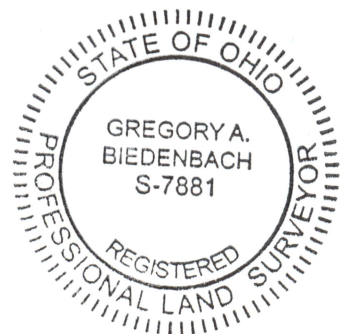

Cc: Survey File: GB-3752F
DESCRIPTION
APPROVED
By: *LR 7/13/21*

[Signature]
APPROVED
MUSKINGUM COUNTY
PLANNING COMMISSION DIRECTOR
7/13/21
Date Fee Paid