

DESCRIPTION OF SURVEY FOR
REBECCA L JEWELL AND GREGORY D BUTLER
JOB#2187-4

Situated in the State of Ohio, County of Muskingum, Township of Newton:

Being part of the Northeast Quarter, Section 15, Township 15, Range 14, of the Congress Lands East of the Scioto River, further **being part of** the Rebecca L Jewell and Gregory D Butler property recorded in **Official Record Volume 2554, Page 258** of said county's deed records, also further **being part of** Muskingum County Auditor's **Parcel Number 47-50-15-61-000**, and more particularly described as follows;

- Commencing at an iron pin (found) at the Southeast corner of the intersection of Market Street and Moxahala Avenue, further being the Northwest corner of the Amy Jo Glines and Chad Saunders property recorded in Official Record Volume 1551, Page 84;
- TIE-1 THENCE South 86 degrees 28 minutes 09 seconds East 860.99 feet** along the South line of Market Street extended by deed and North lines of said Glines/Saunders property and for the Randall L Glines and Mary Glines property recorded in Deed Book Volume 1060, Page 35, also for the Rebecca L Jewell and Gregory D Butler property recorded in Official Record Volume 2554, Page 258 to a survey nail (set) over a magnetic reading at a corner of the Raymond W Evans and Tina I Evans property recorded in Deed Book Volume 1129, Page 212, passing iron pins (found) at 166.04 feet and 372.04 feet;
 - TIE-2 Thence South 14 degrees 20 minutes 53 seconds West 66.18 feet** along a common line for said Jewell/Butler and Evans properties to an iron pin (found);
 - TIE-3 THENCE South 77 degrees 21 minutes 08 seconds East 156.70 feet** continuing along said properties to an unmarked point on the common line for parcels described in said Jewell/Butler deed;
 - TIE-4 THENCE South 03 degrees 55 minutes 07 seconds West 649.34 feet** along said parcel line to an iron pipe (found) at a corner of the Earle E Adams and Rebecca Adams property recorded in Official Record Volume 1871, Page 55 being the place of beginning for the property herein intended to be described;
 - #1- THENCE South 35 degrees 29 minutes 34 seconds West 101.98 feet** along a common line for said Jewell/Butler and Adams properties to a survey nail (set) over a metal reading (found) at the base of a maple tree;
 - #2- THENCE South 25 degrees 19 minutes 35 seconds West 67.81 feet** continuing along a said properties to a cotton gin spike (set) over a metal reading (found) at the base of a maple tree;
 - #3- THENCE South 09 degrees 22 minutes 02 seconds West 75.91 feet** continuing along said properties to an iron pin (found);
 - #4- THENCE South 34 degrees 27 minutes 44 seconds East 62.70 feet** continuing along said properties to an iron pin (set);
 - #5- THENCE North 75 degrees 07 minutes 42 seconds West 60.03 feet** through said Jewell/Butler property to an iron pin (set);
 - #6- THENCE North 24 degrees 39 minutes 35 seconds West 83.53 feet** continuing through said property to an iron pin (set);
 - #7- THENCE North 41 degrees 20 minutes 01 seconds East 239.17 feet** continuing along said properties to the place of beginning, **containing 0.183 acres.**

Not to be used as a separate building site or transferred as an independent parcel in the future without planning commission approval in accordance with applicable subdivision regulations. Parcel to be combined with adjacent Auditor's Parcel Number 47-50-14-57-000.

The bearings within this description are based on State Plane Coordinate Grid (Ohio South 1983) derived from GPS Observations. Iron pins (set) are 5/8" rebar with identification caps (C.R.Harkness P.L.S.6885).

This description was written by Charles R. Harkness Professional Land Surveyor #6885 from an actual survey completed on February 6, 2015 in accordance with Chapter 4733-37 of the Administrative Code, and is intended to be used for the legal transfer of the property described and does not intend to describe any apparent easements nor easements of record, unless otherwise indicated.

OFFICE COPY
NOT RECORDED
Charles R. Harkness PLS #6885

DESCRIPTION
APPROVED
BY: *[Signature]* 2/12/2015

APPROVED
MUSKINGUM COUNTY
PLANNING COMMISSION DIRECTOR



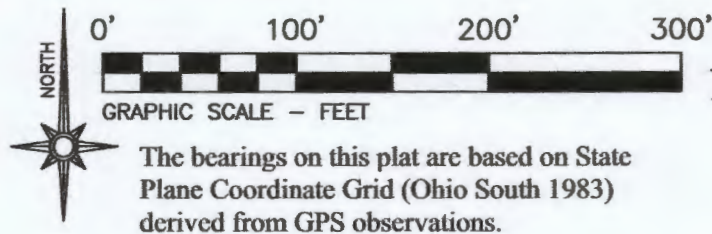

LEGEND

- PIN (SET) 5/8" REBAR CAPPED (C R HARKNESS PLS #6885)
- PIN (FOUND)
- POINT (UNMARKED)
- PIPE (FOUND)
- SURVEY NAIL (SET)
- COTTON GIN SPIKE (SET)

Avondale
PB 4, Pg 72.

Main Street

Perry Street

Avondale
PB 4, Pg 72.

(Platted Washington Street)

Washington St TR 84

Moxahala Avenue

Moxahala Avenue

Vacated St

Rodale Drive

Market Street

Commencing

Amy Jo Glines &
Chad D Saunders
OR Vol. 1551,
Page 84.

Randall L Glines
& Mary Glines
DB Vol. 1060,
Page 35.

Shilo T Pletcher
OR Vol. 2128,
Page 788.

William Morozowsky Jr.
DB Vol. 1133,
Page 93.

Thomas Morrison &
Arnetta Morrison
DB Vol. 1110,
Page 279.

Raymond W Evans
& Tina I Evans
DB Vol. 1110, Pg 276,
DB Vol. 1129, Pg 212 &
OR Vol 1863, Pg 36.

Rebecca L Jewell
& Gregory D Butler
OR Vol. 2554, Page 258.
Parcel Number 47-50-15-61-000

Rebecca L Jewell & Gregory D Butler
OR Vol. 2554, Page 258.
Parcel Number 47-50-15-60-000

Jay R McConnell &
Linda S McConnell
OR Vol. 2424,
Page 511.

SURVEY 2

Situated in the State of Ohio, County of Muskingum, Township of Newton:

Being part of the Northeast Quarter, Section 15, Township 15, Range 14, of the Congress Lands East of the Scioto River, further being part of the Rebecca L Jewell and Gregory D Butler property recorded in **Official Record Volume 2554, Page 258** of said county's deed records, also further being part of Muskingum County Auditor's **Parcel Number 47-50-15-61-000**:

Not to be used as a separate building site or transferred as an independent parcel in the future without planning commission approval in accordance with applicable subdivision regulations. Parcel to be combined with adjacent Auditor's Parcel Number 47-50-14-57-000.

LINE	BEARING	DISTANCE
1a	S 35°29'34" W	101.98'
2a	S 25°19'35" W	67.81'
3a	S 09°22'02" W	75.91'
4a	S 34°27'44" E	62.70'
5a	N 75°07'42" W	60.03'
6a	N 24°39'35" W	83.53'
7a	N 41°20'01" E	239.17'
Containing 0.183 ACRES		

SURVEY 1

Situated in the State of Ohio, County of Muskingum, Township of Newton:

Being part of the Northeast Quarter, Section 15, Township 15, Range 14, of the Congress Lands East of the Scioto River, further being part of the Rebecca L Jewell and Gregory D Butler property recorded in **Official Record Volume 2554, Page 258** of said county's deed records, also further being part of Muskingum County Auditor's **Parcel Number 47-50-15-60-000**:

Not to be used as a separate building site or transferred as an independent parcel in the future without planning commission approval in accordance with applicable subdivision regulations. Parcel to be combined with adjacent Auditor's Parcel Number 47-50-14-57-000.

LINE	BEARING	DISTANCE
1	S 13°29'32" E	72.76'
2	N 29°43'58" W	69.73'
3	N 59°54'54" E	20.35'
Containing 0.016 ACRES		

Earle E Adams &
Rebecca Adams
OR Vol. 1871, Page 55.
Par 47-50-15-57-000
Par 47-50-15-58-001

Rebecca L Jewell
& Gregory D Butler
OR Vol. 2554, Page 258.

APPROVED
MUSKINGUM COUNTY
PLANNING COMMISSION DIRECTOR

Date: 2/20/15 Fee Paid

DESCRIPTION

APPROVED

By: [Signature]

Approved for Transfer
No On-Lot Sewage
Zoning/Muskingum Co.
Health Department

2/20/15

This plat was prepared by C.R. Harkness Surveying & Mapping Inc. accordance with Chapter 4733-37 of the Administrative Code, and it be used for the legal transfer of the parcel surveyed and does not sl apparent easements nor easements of record, unless otherwise ind

OFFICE COPY
NOT RECORDED

SURVEY FOR:

R L Jewell &
G D Butler



HARKNESS SURVEYING & MAPPING, INC.

8205 OLD TOWN ROAD
ROSEVILLE, OHIO 43777
PHONE/FAX (740) 849-0122



SURVEYED:02/06/15 DRAWN:02/09/15

JOB NUMBER
Job#2183

DRAWING / SHEET #
Plat #02 Des-3&4