

47-70-21-08-012 A

Page 2 of 2  
Description of Parcel No. 2C (3.978 Acres)

Subject to the 100-Year Flood Plain restrictions, if applicable.

All iron pins set are 5/8" x 30" rebar capped "Biedenbach Surveying, LLC. 7881".

The bearings in this description are for angle calculations only and are based on the north line of the southeast quarter of Section 21 used as an assumed bearing of South 86°38'14" East.

A plat for the above-described survey has been submitted for file at the County Engineer's Office.

The above description was prepared by Gregory A. Biedenbach, Registered Surveyor No. 7881, based on an actual field survey of April 8, 2020; said survey being subject to any facts that may be disclosed in a full and accurate title search.

Prior deeds: Official Records Volume 2860, Page 517.

Surveyor: *Gregory A. Biedenbach*  
Date: *April 8, 2020*  
Survey File: GB-3446

**OFFICE COPY**  
**NOT RECORDABLE**

DESCRIPTION  
APPROVED  
By: *[Signature]*

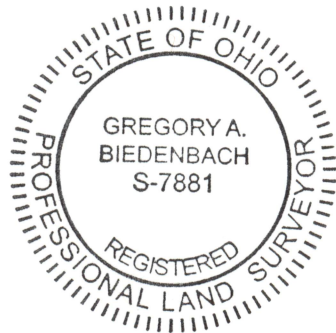

**APPROVED**  
**MUSKINGUM COUNTY**  
**PLANNING COMMISSION DIRECTOR**

*4/20/2020*  
Date Fee Paid