

47-82-31-05-001 B

47-76-36-07-001 B

This description is written based on field and record data and completed October 2, 2020 by Timothy H. Linn, PS.

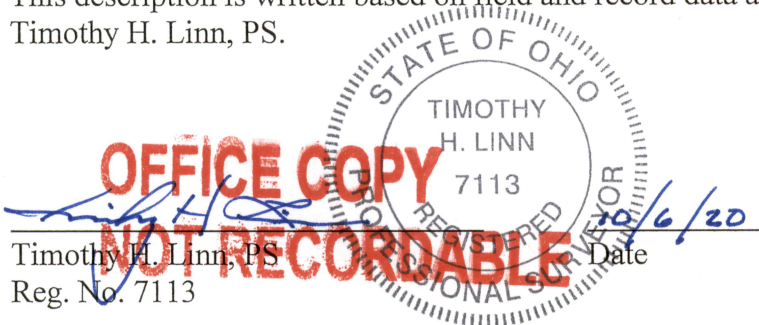

Parcel Nos.

Part of:	47-82-31-05-000	±146.376 ac.
All of:	47-76-36-07-001	± 4.124 ac.
All of:	47-76-36-08-000	± 1.108 ac.
Total		±151.608 ac.

DESCRIPTION

APPROVED

By: AL 10/2/2020