



CANTER SURVEYING

GPS SERVICES, INC.

227A Columbus Road
Athens, Ohio 45701

Phone (740) 592-5706

Fax (740) 592-5817

Situate in Newton Township, Muskingum County, Ohio and being the Charles Martin Clark parcels as described in O.R. Vol. 1138, Pg. 404 and being more fully described as follows:

Parcel 1

Being a part of Section 30, T15N, R14W. **Point-of-Beginning** being a stone found at the northwest corner of said Section 30;

Thence S $86^{\circ}48'44''$ E 300.88 feet along the north line of said Section 30 to an axle found;

Thence S $19^{\circ}54'44''$ E 184.00 feet to an iron pin set on the northerly line of former railroad parcel (reference: O.R. Vol 1554 Pg. 401);

Thence S $51^{\circ}45'32''$ W 66.54 feet along said northerly line;

Thence continuing along said line with a curve to the left having a length of 507.99 feet, a radius of 1605.26 and a chord bearing S $42^{\circ}41'36''$ W 505.87 feet to an iron pin set on the west line of said Section;

Thence N $03^{\circ}03'28''$ E 603.59 feet along said west line to the Point-of-Beginning (reference: passing iron pins set at 100.83 feet and 372.79 feet).

600E SALTILLO RD

Containing 2.950 acres. Auditor's Tax Parcel 47-47-80-04-01-000.

Parcel 2

Being a part of Section 24, T17N, R15W. **Point-of-Beginning** being an iron pin set at the southeast corner of said Section (reference: stone found N $03^{\circ}03'28''$ E 230.80 feet);

Thence N $87^{\circ}00'34''$ W 660.00 feet to an iron pin set;

Thence N $03^{\circ}03'28''$ E 799.26 feet to an iron pin set;

Thence S $69^{\circ}43'41''$ E 690.95 feet to an iron pin set in the east line of said Section;

Thence S $03^{\circ}03'28''$ W 594.00 feet to the Point-of-Beginning.

Containing 10.555 acres. Auditor's Tax Parcel 47-47-54-05-35-000.

N/A

PLAT of SURVEY

PARCEL 1
SITUATE IN SECTION 30, T15N, R14W,
NEWTON TWP., MUSKINGUM COUNTY, OH.
CONTAINING 2.950 ACRES.

PARCEL 2
SITUATE IN SECTION 24, T17N, R15W,
NEWTON TOWNSHIP, MUSKINGUM COUNTY, OH
CONTAINING 10.555 ACRES.

M. PERRY
VOL. 785 PG. 140

P.O.B. PARCEL 1
STONE FOUND AT THE
NORTH WEST CORNER
SECTION 30, T15N, R14W

● 5/8"x30" IRON PIN SET
W/CAP "CANTER P.S. 7226"

□ STONE FOUND

△ AXLE FOUND

REFERENCES:
SURVEY OF RAILROAD PARCEL OF OCT., 2000
BY TERRY FINLEY, P.S. 7222.
SURVEY OF RAILROAD PARCEL OF 1993 BY
R.L. DANIELS, P.S. 5410.

BASIS OF BEARINGS:
BEARINGS ARE OHIO STATE PLANE GRID -
SOUTH ZONE.
DATUM: NAD83(95)
WEST LINE OF SECTION 30 BEING
N 03°03'28" E.

SUBJECT TO ALL LEGAL EASEMENTS AND
RIGHTS-OF-WAY.

DESCRIPTION APPROVED
FOR AUDITOR'S TRANSFER

BY *[Signature]*

7-19-2002

L= 507.99'
R= 1605.26'
chd= S42°41'36"W, 505.87'

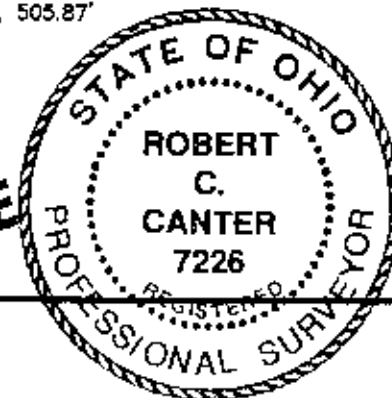

GRAPHIC SCALE



Not to Scale

M. PERRY
677-212
35.59 AC

M. PERRY
558-446
26.07 AC

PARCEL 2
459,775 sq. ft.
10.555 acres

PARCEL 1
128,512 sq. ft.
2.950 acres

A. KIRKBRIDE
538-130
1.83 AC

NOTE: EXISTING FENCELINE
AS SHOWN. NO STATEMENT
IS MADE AS TO ANY RIGHTS
THAT ADJOINER MAY HAVE
DUE TO ADVERSE POSSESSION.

CANTER SURVEYING
GPS SERVICES

Robert C. Canter, P.S.
227A Columbus Road
Athens, Ohio 45701
(740) 592-5708

DRAWN BY: M. SCHLOSS	DATE: 07-18-02
CHECKED BY: RCC	DRAWING NO.: 22055
22055	SHEET 1 OF 1

SURVEYED 7/15/2002 BY
ROBERT C. CANTER, P.S. 7226

OFFICE COPY
NOT RECORDABLE