



Know all Men by these Presents

That **FRANKLIN C. FORD, aka FRANKLIN P. FORD, unmarried, and
JERRY F. OWENS and FLORENCE Y. OWENS, his wife,**

47-83-33-23 PS

of **Muskingum** County, State of Ohio, for valuable consideration paid, grant
with general warranty covenants, to **REGINALD L. FOLDEN and MARGIE FOLDEN**

whose tax mailing address is **7815 Rose Hill Road
Roseville, Ohio 43777**

the following real property:

Situated in the County of Muskingum, in the State of Ohio and in the Township of Newton and being a 4.374 acre tract of land (also referred to as Tract 4) in the Southeast Quarter of Section 33, Township 15, Range 14, as conveyed to Franklin P. Ford, et al, in Deed Volume 269, Page 111 in the office of the Muskingum County Recorder, also being SUBJECT TO all legal easements and rights-of-way of record and being more particularly described as follows:

Commencing for reference at a 1½ O.D. inch iron pipe found at the Southeast corner of said Section 33; thence along the Section line, also the Muskingum-Perry County line, North 83 degrees, 53 minutes, 49 seconds West, a distance of 766.57 feet to a point on the West right-of-way line of County Road 696 (Old State Route 75); thence North 11 degrees, 21 minutes, 30 seconds East, a distance of 1174.24 feet along the West right-of-way line of County Road 696 to the South right-of-way line of County Road 127 and the Northeast corner of a 0.58 acre tract of land conveyed to Gladys L. Brooks in Deed Volume 543, Page 488; thence North 78 degrees, 39 minutes, 30 seconds West a distance of 208.71 feet along the North line of said Brooks tract and the South right-of-way line of County Road 127 to a railroad spike set in the asphalt. Said spike being the point of beginning for the tract herein described; thence South 11 degrees, 21 minutes, 30 seconds West, a distance of 924.06 feet along the West line of said Brooks tract and the West line of the following parcels; R. Folden (Volume 442, Page 21), Church of the Nazarene (Volume 550, Page 601), J. Dunn (Volume 758, Page 287), and C. Dunn (Volume 435, Page 323), to an iron pipe set; thence North 75 degrees, 03 minutes, 47 seconds West, a distance of 220.15 feet along the North line of a parcel of land conveyed to L. Baughman in Deed Volume 753, Page 247 to an iron pipe set on the East line of a parcel of land conveyed to C. Higgins in Deed Volume 926, Page 262; thence North 06 degrees, 08 minutes, 02 seconds East, a distance of 89.16 feet along the East line of said Higgins parcel to a point in the East right-of-way line of State Route 93 at Station 294+30, 144 feet right; thence North 06 degrees, 21 minutes, 39 seconds East, a distance of 214.35 feet with the East right-of-way line of State Route 93 to an angle point in the right-of-way line at Station 296+39.99, 101 feet right; thence North 18 degrees, 33 minutes, 22 seconds East, a distance of 460.04 feet with said right-of-way line to an angle point at Station 301+00, 106 feet right; thence North 10 degrees, 41 minutes, 25 seconds East, a distance of 72.76 feet with said right-of-way line to a concrete right-of-way monument found; thence North 87 degrees, 25 minutes, 54 seconds East, a distance of 116.56 feet with said right-of-way line to an iron pipe set at the right-of-way angle point at Station 302+13, 206 feet right; thence North 79 degrees, 19 minutes, 03 seconds East, a distance of 59.24 feet with said right-of-way line to an iron pipe set at the right-of-way angle point at Station 302+41.37, 258 feet right; thence North 19 degrees, 47 minutes, 18 seconds East, a distance off 28.85 feet with said right-of-way line to a railroad spike set in asphalt on the South right-of-way line of County Road 127; thence South 78 degrees, 39 minutes, 30 seconds East, a distance of 17.46 feet leaving State Route 93 right-of-way line and along the South line of County road 127 to the point of beginning and containing 4.374 acres.

Being Auditor's Parcel Number

The bearing system for this description is based on the centerline of State Route 93 being North 17 degrees, 56 minutes, 00 seconds East.

All iron pipe set are ¾ inch by 30 inch long steel pipe with plastic I.D. caps.

This description was prepared on June 20, 1992 by Mark L. Kitamiller, Registered Surveyor No. 7382 and is based on an actual field survey of the premises and existing public records.

DESCRIPTION APPROVED
FOR AUDITOR'S TRANSFER

BY Mark L. Kitamiller

LANDS OF FRANKLIN P. FORD, ET AL			
TRACT 1	D.B. 269 PG. 111	12.055 ACRES	
TRACT 2	D.B. 269 PG. 111	5.640 ACRES	
TRACT 3	D.B. 269 PG. 111	11.987 ACRES	(42.71 ACRES - ORIGINAL DEED)
TRACT 4	D.B. 269 PG. 111	4.374 ACRES	
TRACT 5 SOUTH	D.B. 269 PG. 111	3.362 ACRES	
TRACT 5 NORTH	D.B. 269 PG. 111	3.004 ACRES	
		40.422 TOTAL ACRES	

ADJOINING PROPERTIES TO FRANKLIN P. FORD, ET AL			
PARCEL 17-001	FIRST NATIONAL BANK	D.B. 560 PG. 953	42.35 ACRES
PARCEL 24	N. MELICK, JR.	D.B. 445 PG. 630	20.15 ACRES
PARCEL 30	G. HEAD	D.B. 1027 PG. 486	0.93 ACRES
PARCEL 31	M. HEINEY	D.B. 783 PG. 311	0.50 ACRES
PARCEL 32	N. MELICK, JR.	D.B. 445 PG. 630	9.00 ACRES
PARCEL 33	J. MELICK	D.B. 447 PG. 284	1.00 ACRES
PARCEL 34	P. CARTER & N. MELICK	D.B. 577 PG. 725	.88 ACRES
PARCEL 35	G. BROOKS	D.B. 543 PG. 488	.58 ACRES
PARCEL 36	R. FOLDEN	D.B. 442 PG. 21	.42 ACRES
PARCEL 38	C. DUNN	D.B. 758 PG. 278	.50 ACRES
PARCEL 39	M. CARTER	D.B. 892 PG. 286	1.00 ACRES
PARCEL 40	M. CARTER	D.B. 892 PG. 286	8.71 ACRES
PARCEL 41	M. CARTER	D.B. 892 PG. 286	1.00 ACRES
PARCEL 42	A. SEVERT	D.B. 555 PG. 223	1.40 ACRES
PARCEL 43	L. BAUGHMAN	D.B. 735 PG. 247	2.00 ACRES
PARCEL 43-001	C. DUNN	D.B. 758 PG. 278	1.75 ACRES
PARCEL 44	C. HIGGINS	D.B. 926 PG. 262	0.38 ACRES
PARCEL 46	CHURCH OF NAZARENE	D.B. 550 PG. 601	1.00 ACRES

SURVEY OF LANDS FOR FRANKLIN P. FORD, et al

Situated in the State of Ohio, County of Muskingum, Township
of Newton, and in the southeast quarter of Section 33,
Township 15, Range 14.

PARCEL 17-001

TRACT 1

PARCEL 24



LEGEND

- Iron pin found
- △ Monument found
- 3/4" Iron pipe w/cap set
- ◇ Stone found
- † Point
- Axle found
- ▲ Railroad spike set
- * Railroad spike found

50 0 100 200
SCALE IN FEET
1" = 100'

I hereby certify that this plat was prepared from an actual field survey of the premises in March of 1992 and from existing public records and that said plat correctly defines the limits of the parcels shown hereon.

This certification was made by me on this
12 day of May, 1992

Mark L. Kitsmiller
Mark L. Kitsmiller Reg. Surveyor No. 7382
Contract Surveying Services, Inc.

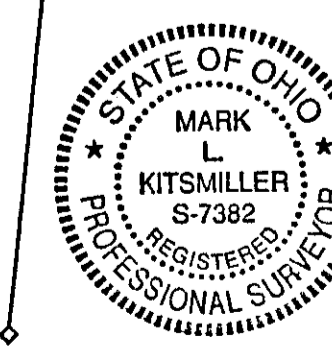

The Bearing System for this Plat is based on the centerline of State Route 93 as being N17°56'00"E (1960 Survey).

County Road 696 - Old State Route 75 was abandoned to County on March 30, 1960, as recorded in the Journal of the Director of Highways, Volume 45, Page 345.

